

# HURTLÉ



## *HURTRD18*

### Smart Digital Treadmill

with Wireless BT App Sync,  
Manual Incline Treadmill Adjustment, Fold-Away Style

## USER MANUAL

**IMPORTANT:** Read all instructions carefully before using this product. Retain this owner's manual for future reference. The specifications of this product may vary from this photo and are subject to change without prior notice.

### **IMPORTANT SAFETY PRECAUTIONS**

**DANGER:** To reduce the risk of electric shock, always unplug the treadmill from the electrical outlet immediately after using and before cleaning, assembling, or servicing the treadmill. Failure to follow these instructions may lead to personal injury and cause damage to the treadmill.

**WARNING:** To reduce the risk of burns, fire, electric shock or injury to any persons, please read the following:

- Never leave the treadmill unattended while plugged in. Disconnect by turning off the master power switch and unplugging from wall outlet when not in use and before putting on or taking off parts.
- Use this appliance only for its intended use as described in this manual. Do not use attachments not recommended by the manufacturer.
- Never operate this treadmill if it has a damaged cord or plug, or if it is not working properly. If it has been dropped or damaged, or been exposed to water, return the appliance to a service center for examination and repair.
- Do not attempt any maintenance or adjustments other than those described in this manual. Should any problems arise, discontinue use and consult an Authorised Service Representative.
- Never operate the appliance with the air openings blocked. Keep the air openings free of lint, hair, and other obstructions.
- Do not use the treadmill outdoors.
- Do not pull the treadmill by its power cord or use the cord as a handle.
- Keep children and pets away from the equipment while in use.
- Elderly or disabled users should only use this treadmill in the presence of an adult who can provide assistance if required.
- Do not operate where aerosol (spray) products are being used or where oxygen is being administered.

- **Keep dry** - do not operate in a wet or moist condition.
- The motor cover can become hot while the treadmill is in use. Do not place the treadmill on a blanket or other flammable surface as this can create a fire hazard.
- Keep electrical cord away from heated surfaces.
- Keep the treadmill on a solid, level surface with a minimum safety area clearance of two meters around the treadmill. Be sure the area around the treadmill remains clear of any obstructions during use.
- This treadmill is for domestic household use only.
- Only one person should use the treadmill at a time.
- Wear comfortable and suitable clothing when using the treadmill. Do not use the treadmill barefoot or in socks. Always wear appropriate, enclosed athletic footwear. Never wear loose or baggy clothing as it can become caught on the treadmill and create an entrapment hazard.
- Always hold on to the handrails while using the treadmill.
- Always make sure the spring knob and round knob are in place when folding and moving the treadmill.
- Do not leave children who are under 12 years-old unsupervised near or on the treadmill.
- To disconnect, turn all controls to the off position, then remove plug from the wall outlet.
- This appliance is not intended for use by persons (including children) with reduced physical, sensory or mental capabilities, or lack of experience and knowledge, unless they have been given supervision or instruction concerning use of the appliance by a person responsible for their safety.
- Children should not be allowed to play on or near the treadmill at any time.
- **CAUTION - RISK OF INJURY TO PERSONS** - To avoid injury, use extreme caution when stepping onto or off of a moving treadmill belt. Carefully read this instruction manual before use.
- Maximum Weight Capacity is 100 kgs.
- Pull out the Safety Tether Key for emergency stop.

- This unit must be plugged into a nominal 120V 60 Hz outlet which has been grounded.
- Keep hands clear of all moving parts. Never place hands or feet under the treadmill while in use.
- Do not use the treadmill on a carpet that is greater than 1.3 cm in height.
- Before using the treadmill, check that the belt is aligned and centered on the running deck and all visible fasteners on the treadmill are sufficiently tightened and secure.
- Children shall not play with the appliance.
- Cleaning and user maintenance shall not be made by children without supervision.
- If the supply cord is damaged, it must be replaced by the manufacturer, its service agent or similarly qualified persons in order to avoid a hazard.
- Never operate this treadmill if it is in the folded position.
- Allow the running belt to fully stop and unplug the power cord from the wall outlet before folding up the treadmill.
- Always face towards the computer console and do not run backwards on the running belt.

**WARNING:** Before beginning any exercise program consult your physician.

This is especially important for people who are over 35 years old or who have pre-existing health problems. Read all instructions before using any fitness equipment. Do not operate this exercise equipment without properly fitted guards, as the moving parts can present a risk of serious injury if exposed.

**CAUTION:** Read all instructions carefully before operating this product.

Retain this Owner's Manual for future reference.

## TOOL KIT

**S1**



M8x50  
Hexagon Socket  
Oval Head Bolt x 2

**S2**

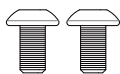

M8x16  
Hexagon Socket  
Oval Head Bolt x 2

**S3**



Spring washer x 2

**S4**



Socket Head  
Screw x 1

**S5**



Safety Key  
(emergency stop) x 1

**S6**

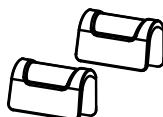

Handrail cover x 2



Allen Key x 1



Allen Wrench x 1

## ASSEMBLY INSTRUCTIONS

**5 easy steps to assemble your treadmill then you're ready to workout.**

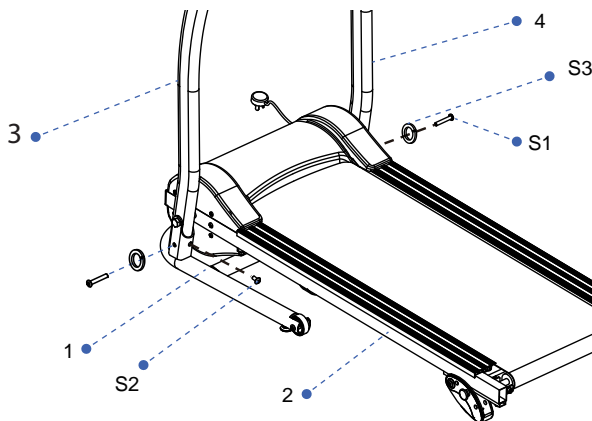

### Step 1

It is recommended to have a second person assist with this step. One person should hold the Left/Right Handlebar Support Tubes (3, 4) in place while the other person tightens the bolts.

- A.** Use two M8x50 Hexagon Socket Oval Head Bolts (S1) and two M8 Nylon Nuts (S3) to secure both Left/Right Handlebar Support Tubes (3, 4) onto the Base Frame (1).

- B.** Use two M8x16 Hexagon Socket Oval Head Bolts (S2) to secure both Left/Right Handlebar Support Tubes (3, 4) onto the Base Frame (1).

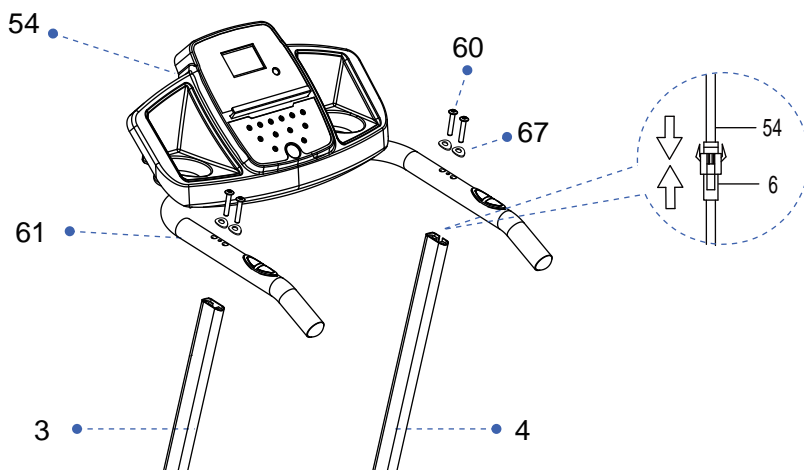

## Step 2

Connect the cable that comes from the Computer Console (54) to the Main Control Cable (6) that comes from the Right Handlebar Support Tube (4).

Slide the Handlebar (61) onto the both Left/Right Handlebar Support Tubes (3, 4). Secure the Handlebar (61) onto the both Left/Right Handlebar Support Tubes (3, 4) with four M8x55 Hexagon Socket Oval Head Bolts (60) and four M8 Curve Washers (67).

**IMPORTANT:** While sliding the Handlebar (61) onto the both Left/Right Handlebar Support Tubes (3, 4), make sure the cables are installed inside the Right Handlebar Support Tube (4) and pay attention not to pinch the cables.

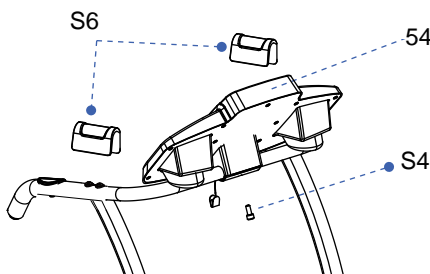

## Step 3

- A.** Turn the Computer Console (54) up or down to align the Socket Head Screw hole. Lock the Computer Console (55) in place by tightening the Socket Head Screw (54).
- B.** Install both Handlebar Plastic Covers (S6) onto the Handlebar (61). Place the Safety Key (S5) onto the Computer Console (54).

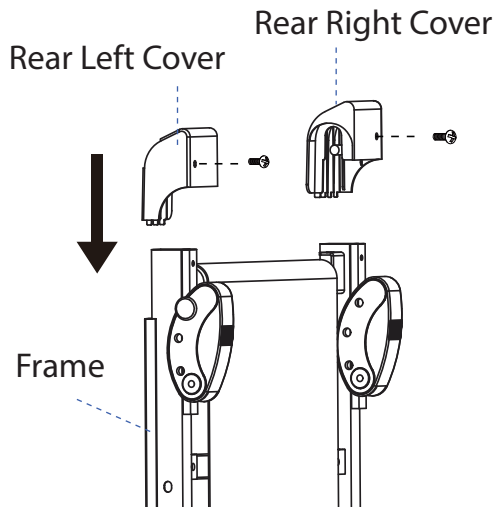

#### Step 4

- A. Remove one **Flat Head Phillips Screw** from both sides of the **Frame**. Attach the **Rear Left Cover** onto the left side of the Frame. Align the holes and secure the **Rear Left Cover** using the one **Flat Head Phillips Screws**, that were previously removed by Allen Wrench.
- B. Align the holes and secure the **Rear Right Cover** using the one **Flat Head Phillips Screws** that were previously removed by Allen Wrench.

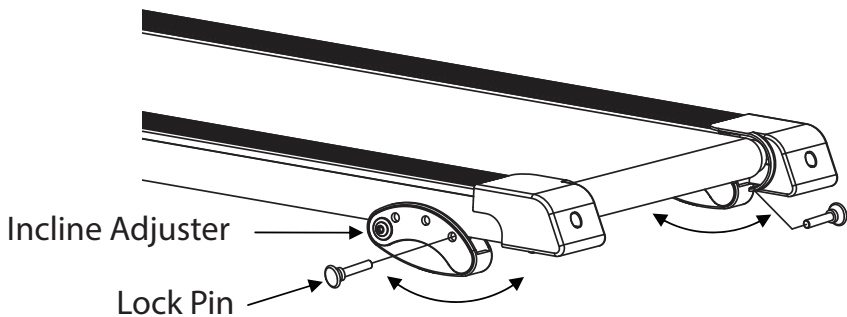

#### **INCLINE ADJUSTMENT**

There are 3 incline angles that the **Incline Adjuster** can be set to. Place one hand on the rear end of the main frame, then lift the rear end of the main frame up and use the other hand to remove the **Lock Pin**. Adjust the **Incline Adjuster** to the desired position and insert the **Lock Pin** into the holes on the main frame and **Incline Adjuster** to lock the **Incline Adjuster** in place.

**NOTE:** Make sure when adjusting the incline angle of the Incline Adjuster that both Incline Adjusters should be adjusted to the same angle. Using the Incline Adjusters at different angles can cause the treadmill to be unstable and cause injury.

**TRAINING IN PRE-SET PROGRAM MODE (P01-P12):**

The computer offers 12 pre-set programs (P01-P12). You may select one of the pre-set training programs in STOP mode before training. Press the PROG (PROGRAM) button on the computer console to select one of the training programs. The split window of TIME begins to blink. You may press the SPEED  $\wedge$  or SPEED  $\vee$  button on the computer console or handlebar to change the setting. Each increment is 1 minute. The pre-set target time range is from 5:00 to 99:00 minutes. Once you pre-set target time, press the START button on the computer to begin exercising. When the pre-set training program time count down to 0:00, the computer will beep to alert you and the treadmill will stop automatically.

Program	Speed (MPH)																			
P1	1.5	2.0	2.0	2.5	3.0	2.0	2.5	3.0	3.0	2.0	2.5	3.0	2.5	2.5	2.5	1.5	2.0	2.0	3.0	2.0
P2	1.5	2.5	2.5	3.0	3.5	2.5	3.5	3.5	3.5	2.5	3.0	3.5	2.5	2.5	2.5	1.5	1.5	3.0	2.5	1.5
P3	1.5	2.5	2.5	3.5	3.5	2.5	4.0	4.0	4.0	2.5	4.0	4.0	2.5	2.5	2.5	1.5	2.5	3.0	2.0	1.5
P4	2.0	3.0	3.0	3.5	4.0	4.0	3.0	4.0	4.0	5.0	5.0	3.0	5.5	3.0	3.0	3.5	3.5	2.5	2.5	2.0
P5	1.5	2.5	2.5	3.0	3.5	4.0	4.0	3.0	3.5	4.0	5.0	5.0	3.0	2.5	2.5	3.5	3.0	3.0	2.5	1.5
P6	1.5	2.5	2.0	2.5	3.0	2.5	5.0	4.0	3.0	4.0	5.0	2.0	3.5	2.5	2.5	1.5	3.0	2.5	2.0	1.5
P7	1.5	2.0	2.0	2.0	2.5	3.0	2.0	2.5	3.0	2.0	2.5	3.0	2.0	2.0	2.0	3.5	3.5	3.0	2.0	2.0
P8	1.5	2.0	2.0	3.5	4.0	4.0	2.5	3.5	4.0	2.5	2.5	2.5	3.5	4.0	2.5	2.5	2.5	1.5	2.0	1.5
P9	1.5	2.5	2.5	4.0	4.0	2.5	4.0	5.0	2.5	5.0	5.5	5.5	2.5	2.5	2.5	3.0	3.5	2.0	2.0	1.5
P10	1.5	2.5	3.0	3.5	4.0	3.0	2.5	3.5	5.0	5.0	3.5	3.5	3.0	2.5	2.5	1.5	2.5	2.5	2.0	2.0
P11	2.0	2.5	3.0	5.5	3.0	5.5	3.0	3.0	3.0	5.5	5.5	3.0	3.0	3.0	5.5	5.5	5.0	4.0	3.5	2.0
P12	1.5	3.0	5.0	6.0	4.0	4.0	6.0	6.0	4.0	4.0	6.0	6.0	3.5	3.5	5.5	5.5	3.0	3.0	2.5	2.0

**FOLDING / UNFOLDING THE TREADMILL**

- Turn off the treadmill, turn off the main power switch and pull out the plug.
- Lift up the running board carefully until hear the click.



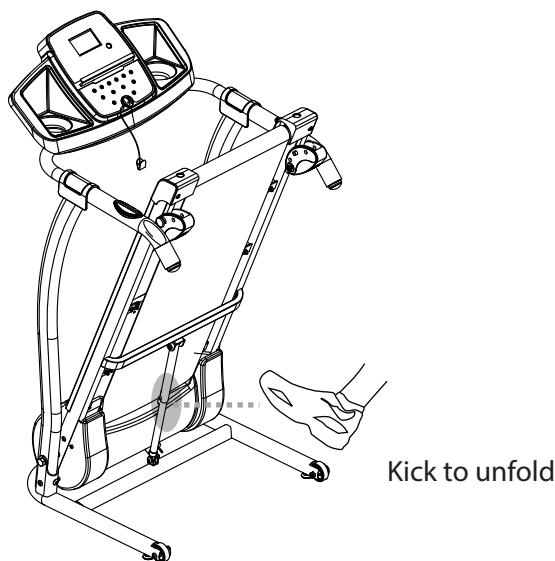

## LUBRICATION

Lubricating under the running belt will ensure superior performance and extend its life expectancy. After the first 25 hours of use (or 2-3 months) apply some lubricant, and repeat for every following 50 hours of use (or 5-8 months).

### How to check running belt for proper lubrication

- Lift one side of the running belt and feel the top surface of the running deck.
- If the surface is slick to the touch, then no further lubrication is required.
- If the surface is dry to the touch, apply some lubricant.

### How to apply lubricant

- Lift one side of running belt.
- Pour some lubricant under the centre of the running belt on the top surface of the running deck.
- Run on the treadmill at a slow speed for 3 to 5 minutes to evenly distribute lubricant.

**NOTE:** DO NOT over lubricate running deck. Any excess lubricant that comes out should be wiped off.

1pc. Lubricant

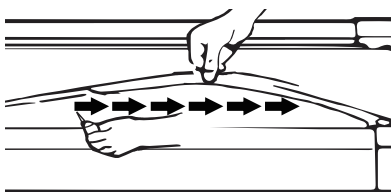

## OPERATING THE COMPUTER

Before beginning a workout session ensure that the **Safety Key** is properly placed onto the **Computer Console** and the **Safety Clip** is securely attached to an article of your clothing.

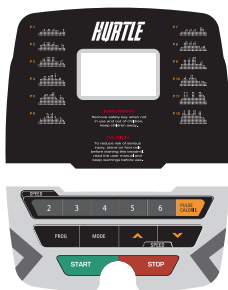

**NOTE:** Always stand on the side rails when you start the treadmill, never start the treadmill while you are standing on the running belt.

### QUICK START:

Press the **START** button on the computer to start exercise, the LCD window will countdown 3 seconds with the LCD showing "3-2-1" before the running belt starts moving. The running belt starts moving with an initial speed of 0.6 MPH. Always allow the treadmill to reach a speed of 0.6 MPH before stepping on to the running belt. You may press the **SPEED**  $\wedge$  or **SPEED**  $\vee$  button on the computer console or handlebar to increase or decrease the running speed during exercise. The split window of **SPEED** will display your current running speed. The speed range is from the minimum 0.6 MPH to the maximum 6.0 MPH. You may also press one of the **INSTANT SPEED** buttons (2/3/ 4/5/6) on the computer console and the split window of **SPEED** will display the speed that you have pressed and the running speed will change to 2 MPH, 3 MPH, 4 MPH, 5 MPH, or 6 MPH respectively. The split window of **TIME** will display your elapsed workout time in minutes and seconds. The split window of **DIST.** (DISTANCE) will display the accumulative distance travelled during workout. The split window of **CAL.** (CALORIES) will display the total accumulated calories burned during workout. The split window of **PULSE** will display your current heart rate in beats per minute (BPM). To activate, grip the hand pulse sensors on both handlebars during exercise and the pulse will display after 4-5 seconds. For a more accurate reading, grip pulse sensors with both hands. During training, you may press the **STOP** button on the computer console to stop the treadmill running at any time, or pull out the safety tether key to stop the treadmill running.

## FUNCTION BUTTONS

**START:** Press the **START** button to start training on different training mode.

**STOP:** Press the **STOP** button to stop training on different training mode.

**PROG (PROGRAM):** Press the **PROG** button to select the pre-set training program (P01-P12) mode before training.

**MODE:** Press the **MODE** button to select different functions (time or distance) for setting exercise goals in manual program mode before training.

### **SPEED $\wedge$ (SPEED UP):**

Press the **SPEED  $\wedge$**  button to make upward adjustments for pre-setting target training time or distance in manual program mode before training.

Press the **SPEED  $\wedge$**  button to make upward adjustments for pre-setting target training time in pre-set training program (P01-P12) mode before training. Makes speed adjustments during all training periods on different training modes.

The speed range is from 0.6 MPH to 6.0 MPH.

### **SPEED $\vee$ (SPEED DOWN):**

Press the **SPEED  $\vee$**  button to make backward adjustments for pre-setting target training time or distance in manual program mode before training.

Press the **SPEED  $\vee$**  button to make backward adjustments for pre-setting target training time in pre-set training program (P01-P12) mode before training.

Makes speed adjustments during all training periods on different training modes.

The speed range is from 0.6 MPH to 6.0 MPH.

**INSTANT SPEED (2/3/4/5/6):** Used to reach desired speed more quickly.

**PULSE/cal:** During exercise mode, press the **PULSE/cal** button to switch display the pulse and calories values on the split window of PULSE/CAL..

## DISPLAY FUNCTIONS

**TIME:** Displays your elapsed workout time in minutes and seconds. Press the **START** button on the computer to begin exercising, the LCD window will countdown 3 seconds with the LCD showing "3-2-1" before the running belt starts moving. The running belt starts moving with an initial speed of 0.6 MPH. You may press the **SPEED  $\wedge$**  or **SPEED  $\vee$**  button on the computer console or handlebar to increase or decrease the running speed during exercise. Time starts counting up from 0:00 to 99:59 per 1 second increment.

**SPEED:** Displays the current speed from the minimum 0.6 MPH to the maximum 6.0 MPH. You may increase or decrease the speed by pressing the **SPEED  $\wedge$**  or **SPEED  $\vee$**  button on the computer console or handlebar.

**DIST. (DISTANCE):** Displays the accumulative distance travelled during workout. Press the **START** button on the computer to begin exercising, the LCD window will countdown 3 seconds with the LCD showing "3-2-1" before the running belt starts

moving. The running belt starts moving with an initial speed of 0.6 MPH. You may press the SPEED  $\wedge$  or SPEED  $\vee$  button on the computer console or handlebar to increase or decrease the running speed during exercise. Distance starts counting up.

**CAL. (CALORIES):** Displays the total calories burned during your workout. Press the START button on the computer to begin exercising, the LCD window will countdown 3 seconds with the LCD showing "3-2-1" before the running belt starts moving.

The running belt starts moving with an initial speed of 0.6 MPH. You may press the SPEED  $\wedge$  or SPEED  $\vee$  button on the computer console or handlebar to increase or decrease the running speed during exercise. Calorie starts counting up. (This data is a rough guide for comparison of different exercise sessions and should not be used in medical treatment).

**PULSE:** Displays your current heart rate in beats per minute (BPM). To activate, grip the hand pulse sensors during exercise and the pulse will display after 2-5 seconds. For a more accurate reading, grip pulse sensors with both hands.

**TRAINING IN MANUAL PROGRAM MODE:** You may pre-set target TIME or DISTANCE in STOP mode before training. Only one of the functions can be pre-set. To set TIME press the MODE button on the computer console until you see the split window of TIME begin blinking. Press the SPEED  $\wedge$  or SPEED  $\vee$  button on the computer console or handlebar to change the setting. Each increment is 1 minute. The pre-set target time range is from 5:00 to 99:00 minutes. Once you pre-set target time, press the START button on the computer to begin exercising. The running belt starts moving with an initial speed of 0.6 MPH. You may press the SPEED  $\wedge$  or SPEED  $\vee$  button on the computer console or handlebar to increase or decrease the running speed during exercise. Time starts counting down from pre-set target time to 0:00 per 1 second backward. When the pre-set target time counts down to 0:00, the computer will beep to alert you and the treadmill will stop automatically.

To set DISTANCE press the MODE button on the computer console until you see the split window of DISTANCE begin blinking. Press the SPEED  $\wedge$  or SPEED  $\vee$  button on the computer console to change the setting. The pre-set target distance range is from 0.50 to 99.5 kilometers, the default distance is 1 kilometer. Once you pre-set target distance, press the START button on the computer to begin exercising. The running belt starts moving with an initial speed of 0.6 MPH. You may press the SPEED  $\wedge$  or SPEED  $\vee$  button on the computer console or handlebar to increase or decrease the running speed during exercise. Distance starts counting down from pre-set target distance to 0.00. When the pre-set target distance counts down to 0.00, the computer will beep to alert you and the treadmill will stop automatically.

CARE, MAINTENANCE & TROUBLESHOOTING GUIDE

**WARNING:** To prevent electrical shock, please turn off and unplug the treadmill before cleaning or performing routine maintenance.

**WARNING:** Always check the wear and tear components like spring knob and running belt to prevent injury.

CLEANING

After each exercise, ensure that the unit is wiped down and any sweat is removed from the unit.

The treadmill can be cleaned with a soft cloth and mild detergent. Do not use abrasives or solvents. Be careful not to get excessive moisture on the display panel as this might damage the unit and create an electrical hazard.

Please keep the treadmill, especially the computer console, out of direct sunlight to prevent damage to the screen.

STORAGE

Store the treadmill in a clean and dry indoor environment. Never leave or use the unit outdoors. Ensure the master power switch is off and the power cord is un-plugged from wall outlet.

TROUBLESHOOTING GUIDE

Problem	Potential Causes	Corrections
Treadmill won't start	1. Treadmill not plugged in 2. Safety Tether Key is not correctly installed. 3. House Circuit breakers has "tripped" 4. Treadmill circuit breakers has "tripped"	1. Plug the power cord into the wall outlet 2. Reinstall the Safety Tether Key 3. Reset the circuit breaker, or call an electrician to replace the circuit breaker. 4. Wait 5 minutes and then try to restart the treadmill.
Belt slips	Belt not tight enough	Adjust belt tension
Belt hesitates when stepped on	1. Not enough lubrication applied onto the running deck. 2. Belt is too tight	1. Apply lubricant. 2. Adjust belt tension
Belt is not centered	Running belt tension not even across the rear roller	Center the belt

## EMERGENCY STOP

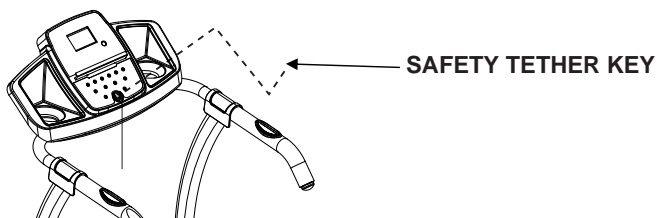

Before beginning a workout session ensure that the Safety Key is properly placed onto the Computer Console and the Safety Clip is securely attached to an article of your clothing. If you fall the clip will pull out the **SAFETY KEY** from the Computer Console and the running belt will stop immediately for emergency stop, helping to prevent injury. Replace the Safety Key onto the Computer Console. Press the START button to begin exercise again.

## BELT ADJUSTMENT

The running belt is pre-adjusted to the running deck at the factory, but after prolonged use it can stretch and require readjustment. To adjust the belt, turn on the main power switch of the treadmill and let the belt run at a speed of 0.6-6.0 MPH. Use the Allen Key provided to turn the rear roller adjustment bolts in order to center the belt. If the running belt is shifting to the left, turn the left adjustment bolt 1/4 turn clockwise, and the running belt should start to correct itself.

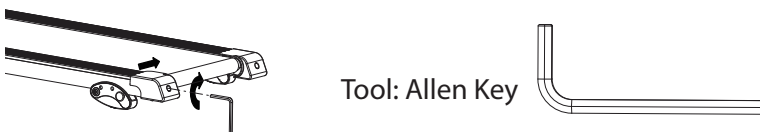

If the running belt is shifting to the right, then turn the right adjustment bolt 1/4 turn clockwise, and the belt should start to correct itself. Keep turning the adjustment bolts until the running belt is properly centered

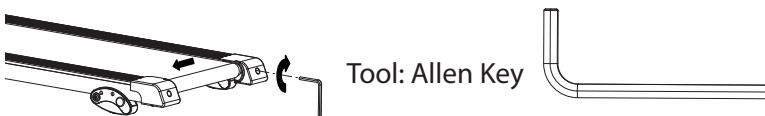

If the running belt is slipping during use, turn off and unplug the treadmill. Using the Allen Wrench provided, turn both left and right rear roller adjustment bolts 1/4 turn clockwise, then turn the main power switch back on and run the treadmill at a speed of 5-6 MPH. Run on to the running belt to determine if the belt is still slipping. Repeat this procedure until the belt no longer slips.



## **WARM UP AND COOL DOWN ROUTINE**

The **WARM-UP** is an important part of any workout. The purpose of warming up is to prepare your body for exercise and to minimize injuries. Warm up for two to five minutes before aerobic exercising. It should begin every session to prepare your body for more strenuous exercise by heating up and stretching your muscles, increasing your circulation and pulse rate, and delivering more oxygen to your muscles.

**COOL DOWN** at the end of your workout, repeat these exercises to reduce soreness in tired muscles. The purpose of cooling down is to return the body to its resting state at the end of each exercise session. A proper cool-down slowly lowers your heart rate and allows blood to return to the heart.

### **HEAD ROLLS**

Rotate your head to the right for one count, you should feel a stretching sensation up the left side of your neck. Then rotate your head back for one count, stretching your chin to the ceiling and letting your mouth open. Rotate your head to the left for one count, then drop your head to your chest for one count.



### **SHOULDER LIFTS**

Lift your right shoulder toward your ear for one count. Then lift your left shoulder up for one count as you lower your right shoulder.

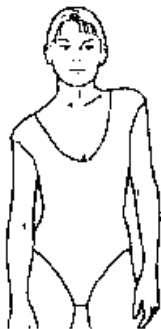

### **SIDE STRETCHES**

Open your arms to the side and lift them until they are over your head. Reach your right arm as far toward the ceiling as you can for one count. Repeat this action with your left arm.



### **QUADRICEPS STRETCH**

With one hand against a wall for balance, reach behind you and pull your right foot up. Bring your heel as close to your buttocks as possible. Hold for 15 counts and repeat with left foot.

### **INNER THIGH STRETCH**

Sit with the soles of your feet together and your knees pointing outward. Pull your feet as close to your groin as possible. Gently push your knees toward the floor. Hold for 15 counts.



### **TOE TOUCHES**

Slowly bend forward from your waist, letting your back and shoulders relax as you stretch toward your toes. Reach as far as you can and hold for 15 counts.

### **HAMSTRING STRETCHES**

Extend your right leg. Rest the sole of your left foot against your right inner thigh. Stretch toward your toe as far as possible. Hold for 15 counts. Relax and then repeat with left leg.

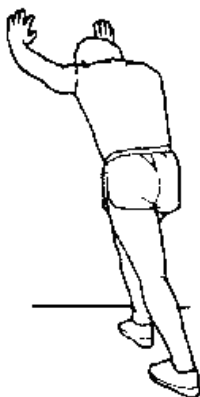

### **CALF/ACHILLES STRETCH**

Lean against a wall with your right leg in front of the left and your arms forward. Keep your left leg straight and the right foot on the floor; then bend the right leg and lean forward by moving your hips toward the wall. Hold, then repeat on the other side for 15 counts.



## HURTRD18

### Smart Digital Treadmill with Witeless BT App Sync

Manual Incline Treadmill Adjustment, Fold-Away Style

#### Features:

- Smart Digital Treadmill Design
- Get Connected with the 'FitShow' App
- Pairs to Your Device via Bluetooth
- Running & Training Data Statistics Readout
- Built-in Hand Grip Sensors for BPM Pulse Monitoring
- Large LCD Digital Display Screen with Touch Button Controls
- Displays Run Time, Distance, Speed, Calories Burned, Heart Rate
- Adjustable Speed Settings
- Selectable Preset Training Modes
- Simple Electric Motorized Plug-in Design
- Use the Incline Adjusters to Manually Set Run Incline Levels
- Convenient Hydraulic Folding Style for Easy Setup & Storage
- Integrated Safety Key, Emergency Power Off
- Built-in Book / Magazine Tray
- Built-in Cup Holders
- Used for Walking, Jogging, Running Exercise Training
- Perfect for Weight Loss, Cardiovascular Fitness, Endurance & Stamina Building

#### The 'Fitshow' App:

- Train Smarter & Connect with Your Favorite Devices
- Record, Collect & Review Treadmill Training Data
- Put Your Training Stats on Display & Challenge Friends
- Ability to Share Health & Fitness Data via Social Media
- Connects to the Treadmill via Bluetooth Smart
- Free to Download, Available for iOS and Android
- Works with Smartphones, Tablets, Laptops, Computers, etc.

#### Technical Specs:

- Motorized Treadmill Motor Power: 1.0HP
- Running Belt / Running Surface  
Size (L x w): 39.37" x 14.17" -inches
- Adjustable Speed: 0.6 - 6.0 MPH
- Target Time Range: 5 - 99 Minutes
- Digital Training Modes:  
1 - 12 Preset Levels Selectable
- Manual Incline Adjustment: (3) Levels
- Maximum Weight Support: Up to 265 lbs.
- \*Some Assembly Required
- Power Cable Length: 5.9' ft.
- Power Supply: 120V
- Total Folded Dimensions (L x W x H): 26.4" x 24.8" x 50.4" -inches
- Total Open Dimensions (L x W x H): 51.2" x 24.8" x 50.4" -inches

#### Bluetooth Connectivity:

- Hassle-Free Pairing,  
No Password Required
- Compatible with All of  
Today's Latest Devices
- Bluetooth Version: BLE SMART 4.0
- Wireless Range: Up to 16.4' ft.



***HURTLÉ***