

nutrichef™

nutrichef™



Questions or Comments?

We are here to help!

Phone: 1.718.535.1800

nutrichefkitchen.com/ContactUs



Start Here



nutrichefkitchen.com/register

NCHUB13 - NCHUB24 - NCHUB35
Digital Hot Water Dispenser
USER GUIDE

About NutriChef

A mission born out of need

NutriChef was created on the principle that healthy home cooking should be attainable to all, regardless of skill level and economic status. Starting in 2014, we noticed the disconnect in our lives and in the lives of those around us. We were so busy, always rushing forward, and our health and personal lives suffered. We needed to find some way to slow down and put our health first, all without sacrificing convenience or taste. Could we somehow create healthier versions of our favorite foods, easily in our own kitchens? The answer was a resounding yes, and NutriChef was born.

We create products that make life a little easier and a little healthier

Our brand was created out of a desire to provide an alternative to fast food convenience and reintroduce people to home cooking. A healthy home-cooked meal is what brings families and friends together. We believe strongly in the value of simple pleasures. An evening spent cooking and sharing a meal of wholesome, nourishing foods is a memory in the making.

We believe a moment shared is priceless

Today, we have built upon our original mission and now in addition offer products that make the art of entertaining a simpler one. Entertaining and hosting family and friends are one of the great joys of life. Why waste a moment stuck in the kitchen? We offer products that free you up to socialize, while never sacrificing quality or taste.



TABLE OF CONTENTS

FEATURES AND TECHNICAL SPECS 4

SAFETY CAUTIONS 5

MAIN PARTS DIAGRAM 7

CONTROL PANEL 7

DIRECTIONS 8

MAINTENANCE 11

STORAGE 12

TROUBLESHOOTING 13

OVERHEAT PROTECTION 14

REGISTER PRODUCT 15

IMPORTANT SAFETY INSTRUCTIONS
READ CAREFULLY AND KEEP FOR FUTURE REFERENCE

California Prop 65 Warning

⚠ WARNING:
This product may expose you to chemicals, which is known to the state of California to cause cancer, birth defects and other reproductive harm. Do not ingest.

For more info go to: www.P65warnings.ca.gov

Features:

- 360° Rotating Base
- Instantly Heats & Dispenses Hot Water
- Simple Electric Plug-in Design
- Built-in LED Light Illuminates When Dispensing
- Adjustable Water Temperature & Dispensing Amounts
- Convenient Easy Access Refillable Water Tank
- Transparent Water Container with Clear Level Mark
- Safe for Placement on Any Table or Countertop
- Suitable for All Drinks Including Instant Coffee, Tea & Soups
- Two Easy Dispensing Methods: Electric Auto Dispense & Cup Touching
- Automatically Keeps Warm and Reboils
- Dry-Boil Protection and Safety Auto Shut-off

What's in the Box:

- Heating Unit
- Power Cable

Technical Specs:

- Heating Element: 750W
- Electric Auto Dispense: 10oz - 16oz per 10 seconds
- Temp. Adjustment: 185°F (85°C), 203°F (95°C), 113°F (45°C), 131°F (55°C), 149°F (65°C), 167°F (75°C)
- Material: 304 Stainless Steel Inner Pot & #430 Stainless Steel Outer Housing
- Power Cord Length: 4.59 ft.
- Power Supply: 120V, 60Hz

MODEL	Capacity	Dimensions (L x W x H)
NCHUB13	3L	11.81" x 7.87" x 9.84"
NCHUB24	4L	11.81" x 7.87" x 11.81"
NCHUB35	5L	11.81" x 7.87" x 13.78"

Safety Precautions

When using an electrical appliance, basic safety precautions should always be followed, including the following:

1. It is essential to read the Instruction Manual carefully before use.
2. Please carry or handle this Hot Water Dispenser using the built-in carrying handle.
3. Do not place it on or near other high-temperature appliances.
4. Do not immerse the power cord or Hot Water Dispenser body in water or other liquids to avoid electric shock.
5. Keep this Hot Water Dispenser out of children's reach during use.
6. Make sure to unplug the power cord from the Water Dispenser when cleaning it.
7. Do not use the Hot Water Dispenser if the power cord is frayed, damaged, or if it operates abnormally. Send it to the nearest authorized repair facility for inspection, adjustment, or repair. Do not attempt to disassemble or repair it.
8. It is not recommended to use tools other than those included with this Hot Water Dispenser.
9. This Hot Water Dispenser is for indoor use only.
10. Do not suspend the power cord off the edge of tables or countertops to avoid injury resulting from overturning the Hot Water Dispenser.
11. Keep this Hot Water Dispenser away from hot surfaces, stoves, and baking ovens.
12. This Hot Water Dispenser operates using only 120V AC.
13. Ensure that the exterior/interior of the Hot Water Dispenser is clean and free of foreign material.
14. Do not place hands close or touch the steam vent to prevent burns resulting from high-temperature steam released during boiling water.
15. Do not boil more water than the maximum allowable amount.
16. Use a damp cloth or sponge for cleaning the Hot Water Dispenser. Never use metal or abrasive scrubbers.
17. Do not use this Hot Water Dispenser for purposes other than its intended use.
18. Always use caution when there is hot water present in the Hot Water Dispenser.

19. Do not suddenly change the temperature of the inner metal lining, for example, by adding ice into boiling water.
20. Do not touch the bottom heating area until it cools down.

Please keep this Instruction Manual for future reference.

Introduction

The NutriChef Digital Hot Water Dispenser is tailored for making hot water available 24/7. With the new emphasis on "Healthy Living-Healthy Life," many people are adding hot tea to quench their thirst. Today, as people are exposed to more chemicals and heavy metals in their environment, they are developing certain sensitivities to them. From these sensitivities, awareness and fears of using non-stick coated cookware are ever-increasing. Taking this into consideration, along with the pursuit of healthier living, our company has developed and manufactured the NutriChef Digital Hot Water Dispenser. We believe our Hot Water Dispenser, free of chemicals and heavy metals, promotes a healthier, stress-free living.

Functions

The NutriChef Digital Hot Water Dispenser is tailored for people who lead a busy, active lifestyle and are also health-conscious. This Hot Water Dispenser can boil water and keep it warm at three different temperatures.

Keep warm at 208°F; suitable for tea, instant coffee, and other instant drinks, at 185°F; an energy-saving default keep warm temperature setting, and 149°F; ideal for Japanese Green Tea or Baby Formula.

It also comes with a Stand-by function for extended energy savings when you will not use the Hot Water Dispenser for a long period, such as when you are asleep.

Main Parts Diagram

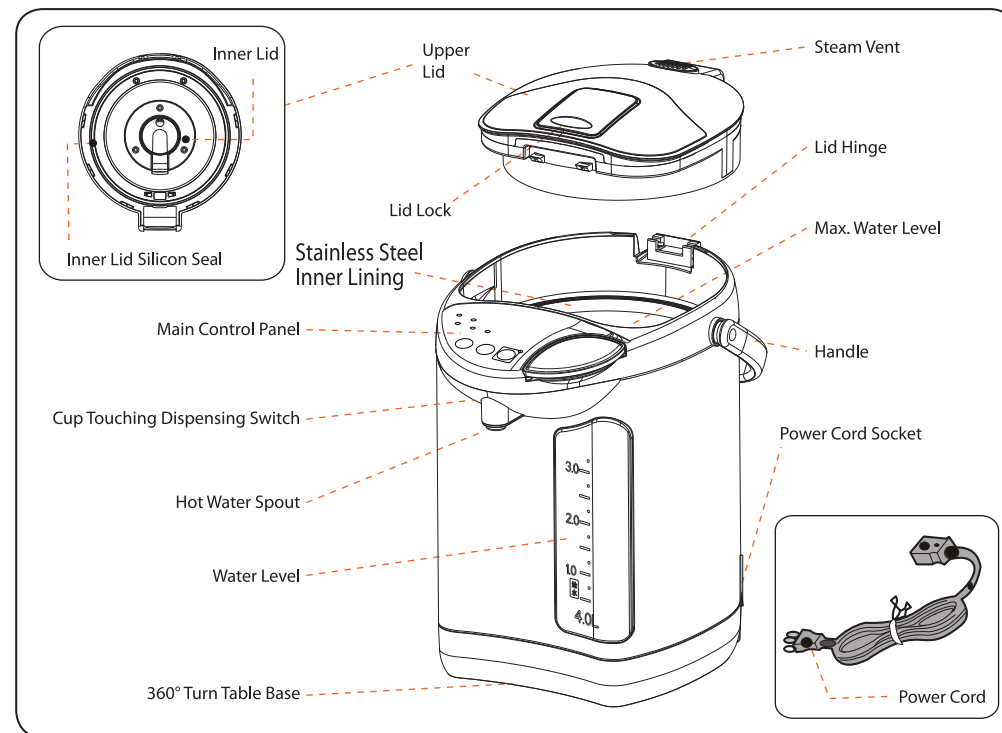

Control Panel

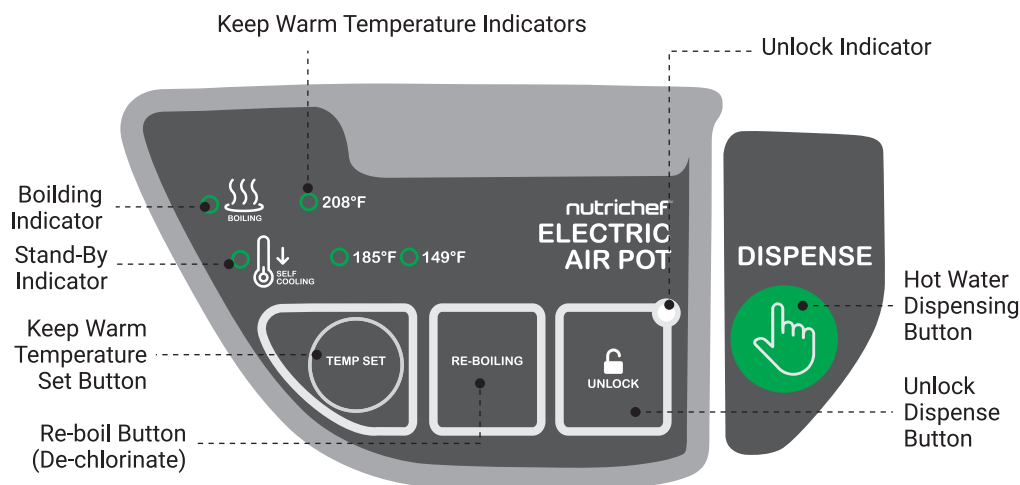

Directions

Pay attention to the following before use:

1. Preparation prior to first operation.

- Take out the Digital Hot Water Dispenser, Power cord, Instruction manual, and warranty from the packing box.
- Fill out the warranty card and mail it back to our Company for registration and one-year after-sales service. Your rights and benefits will only be guaranteed if we receive your completed warranty.
 - Set aside packing materials and the box for future storage and transport.
 - Please read the Instruction Manual carefully for the proper use of this kettle.
 - Do not plug the power cord into the outlet before being ready to use.
 - Ensure the interior and exterior of the kettle are dry and clean before pouring water into it (Filtered Water is recommended for boiling in this kettle).
2. Press the "**TEMP SET**" Button to select your desired keep warm temperature.
 3. The Digital Hot Water Dispenser is designed to boil water and keep it warm 24/7 for your convenience. Do not use this kettle for anything other than heating water.
 4. The Digital Hot Water Dispenser is characterized by its ease of operation and convenience. Enjoy!

How to use

1. Open Lid to Pour Water

NOTE: Filtered Water is recommended for boiling in this Hot Water Dispenser.

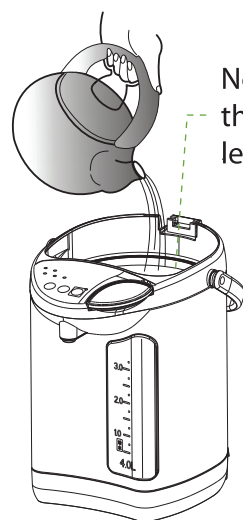

Never fill above the max water level line

- Do not spill water outside of this kettle.
- Close the lid after pouring water.
- Please do not over fill water pass the Max Water Level. It might cause overflow during boiling

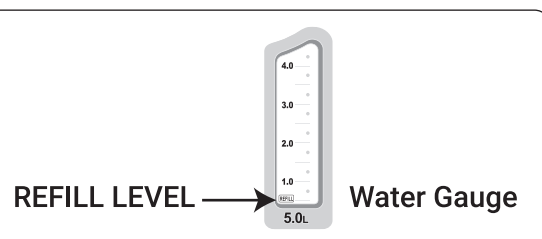

2. Plug in the Power Cord to start boiling

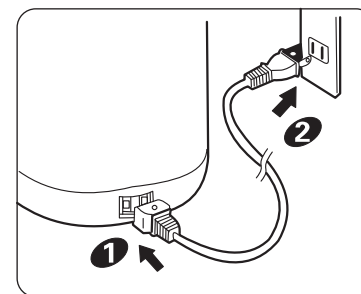

Start Boiling

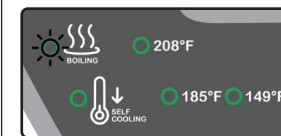

Boiling indicator is ON

Boiling Finished

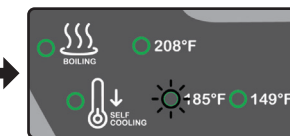

Boiling indicator is OFF;
Temp indicator is ON



1. Connect the Power Cord to the Hot Water Dispenser.

2. Plug the Power Cord into the power outlet.

After connecting to the outlet, the "**BOILING**" indicator lights up, and water starts to boil automatically until reaching a boiling temperature of (212°F).

3. When the water is boiling, the Hot Water Dispenser will switch to keep-warm mode. The Default (or customer-selected) Temp indicator of 185°F lights up.

- The Hot Water Dispenser will re-boil again if the water temperature drops below the set temperature level.
- If the Hot Water Dispenser does not boil automatically, press the "**RE-BOIL**" button to boil water.

4. Each time the "**TEMP SET**" button is pressed, the keep-warm temperature indicator will switch in the following sequence: 185°F -> 208°F -> 149°F -> 185°F -> ...

3. TWO WAYS TO DISPENSE HOT WATER

1. Press the "**UNLOCK**" button; the unlock light is on.

(Hot Water Dispenser will auto-lock if idle for 10 seconds.)

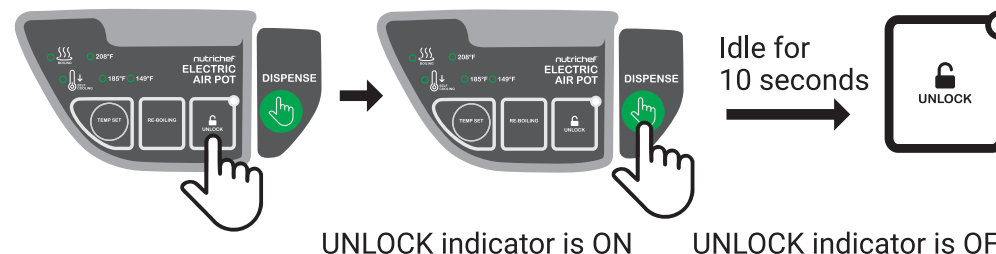

2. **Push Button Dispensing:** Press the "**DISPENSE**" button to dispense hot water into the cup.

Cup Touch Dispensing: Hold the cup up to touch the cup switch behind the spout to dispense hot water into the cup.

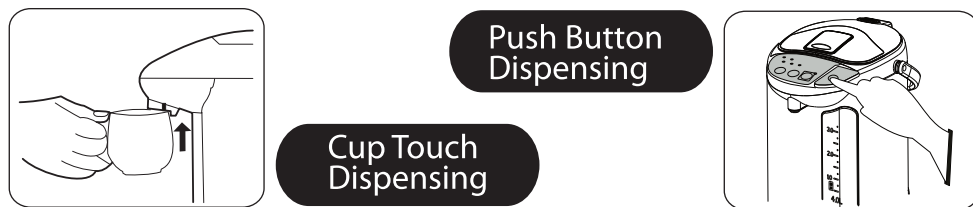

NOTE:

After water has boiled without dispensing for a period, some air might become trapped in the water pump, preventing water pumping. Simply open, then close the lid to solve this issue.

4. STAND-BY FUNCTION

1. During water boiling, press the "**RE-BOIL**" button once; the kettle will turn into **STANDBY** mode and stop boiling. To resume boiling, press "**RE-BOIL**" again.

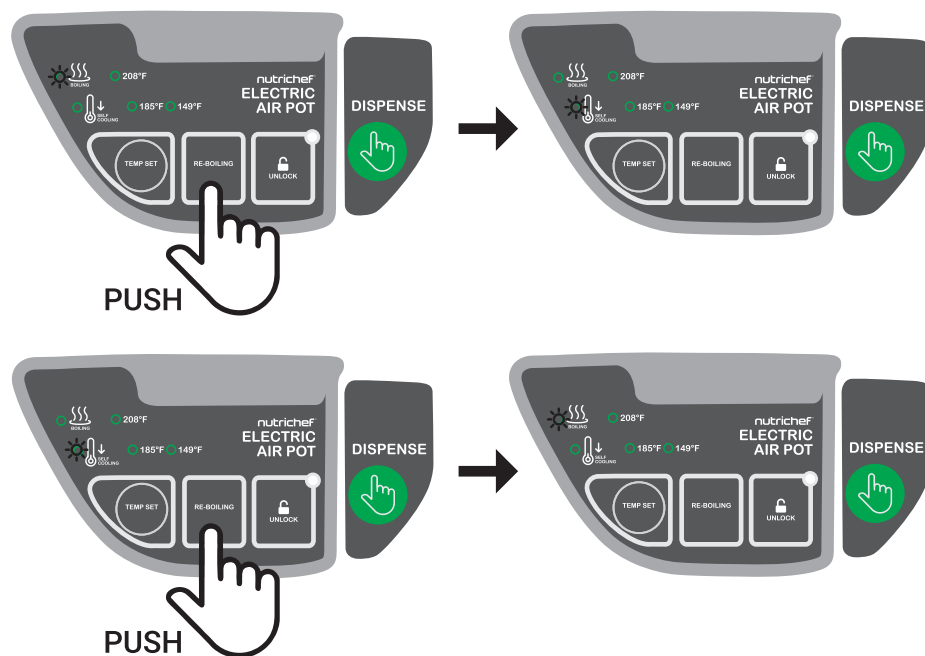

2. If the Dispenser is in keep-warm mode, press the "**RE-BOIL**" button twice to set the Hot Water Dispenser into **STANDBY** mode. Resume boiling by pressing "**RE-BOIL**" again.

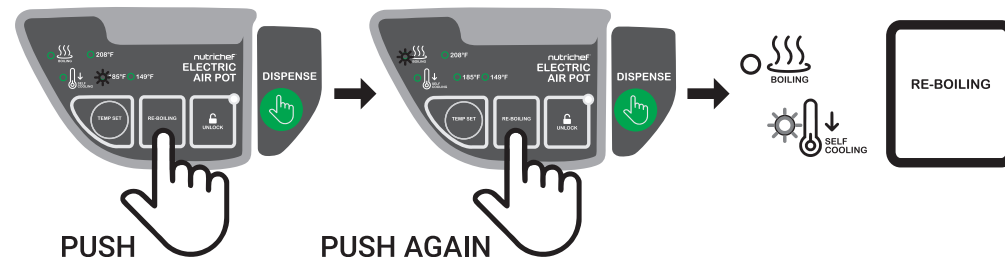

Maintenance

BODY

Wipe the Hot Water Dispenser body with soft dry cloth.

- Wipe the Hot Water Dispenser body with a soft, dry cloth.
- Wipe with a damp cloth if the stain is hard to remove.
(Never use a soaked cloth!)
- Don't use thinner to clean; it might crack the plastic casing.
- Any cloth containing chemicals might cause color changing of the body.

WARNING: This Hot Water Dispenser is not Dishwasher safe!

REMOVE SCALE DEPOSIT

If using tap water, the minerals in the water will deposit on the surface of the stainless steel lining over time. This deposited scale will shorten the life of this Hot Water Dispenser. Please clean this Hot Water Dispenser with citric acid at least once a month. Follow the instructions on the citric acid's package to clean and remove mineral deposits.

LINING

Wipe the lining with a damp sponge.
Don't use detergent or any kind of abrasive brush.

REPLACE SILICON SEAL

The silicon seal may become damaged after a long period of use. It should be replaced. Call our service line or order on our web store for a replacement silicon ring.

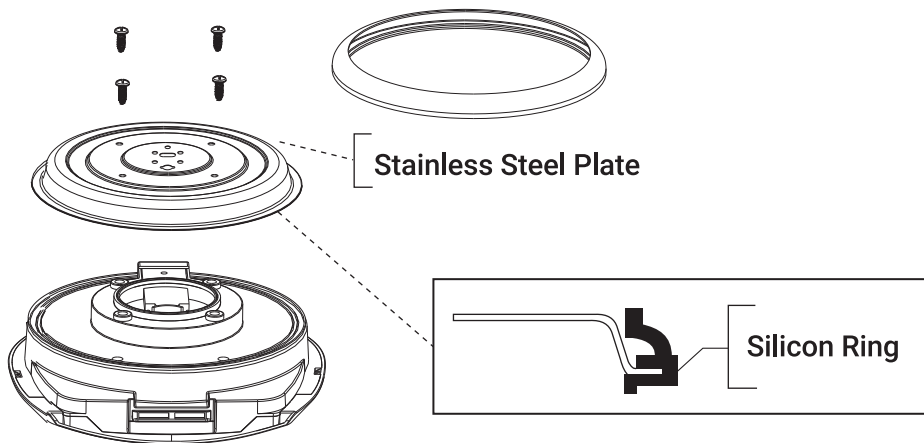

It is easy to replace the silicon ring by following these steps: Remove the four screws inside the bottom of the upper lid. Remove the stainless steel plate. Take out the existing silicon ring and replace it with the new ring. Put back the stainless steel plate. Tighten the four stainless steel screws.

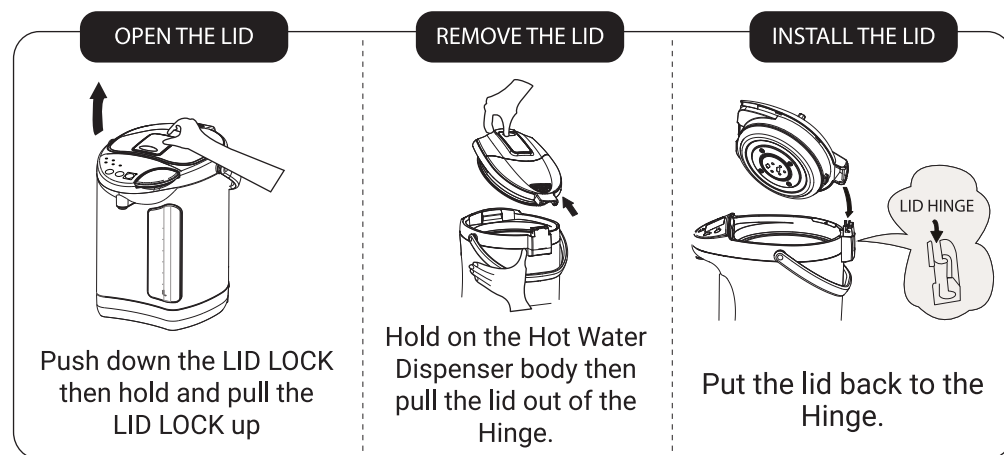

STORAGE

1. Pull the plug out of outlet.
2. Pull the cord out of kettle.
3. Remove upper lid.
4. Pour all water out of kettle.

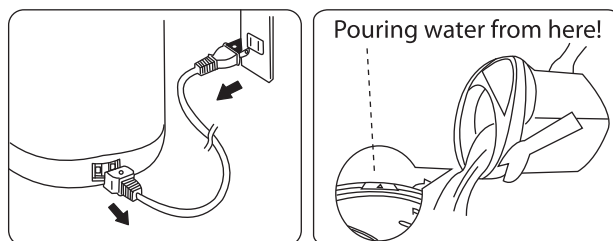

TROUBLESHOOTING

TROUBLES	POSSIBLE CAUSE	SOLUTION
White mineral or shiny specks floating in the water or deposited on the surface of the inner lining of the Hot water Dispenser	Mineral Crystallized in water	Clean with citric acid. How to clean? See REMOVE SCALE DEPOSIT section in this menu or the instruction on the package of citric acid
	Tap water contain too much minerals causing deposits on the surface of the inner lining	
Odors in the hot water	Chlorine in the tap water may cause odor	Press "RE-BOILER" to De-Chlorine
	For the first few uses, it may have a plastic smell in the water because of new plastic components.	Boil a new pot of water for few times before normal use
Water does not pump out smoothly	Filter might be plugged	Clean the filter with citric acid
	Air might be trapped in the water pump	Open the upper lid and closed it few times, then try again.
Does not pump water out at all	Check that the unlock indicator is off	Press "UNLOCK" button once then press "DISPENSE" to see whether it works or not
Hot water leaking out from the nozzle	Too much water in the pot	Make sure the water is not filled above the MAX water level line.
No Power	Check the power cord	Attach power cord firmly to both outlet and Hot Water Dispenser
Hot Water Dispenser body case feels hot	To keep water hot when at higher room temperature the body case might reach 149°F	

OVERHEAT PROTECTION

When the Hot Water Dispenser is empty of water, an overheat safety protection sensor will automatically activate, swiftly turning off the power to prevent overheating. Simultaneously, the temperature keep warm lights will blink when the overheat protection is triggered.

This Hot Water Dispenser comes with overheat protection sensors. However, operating the dispenser without water while it's powered on is extremely dangerous and can lead to fire and property damage. Always maintain water above the REFILL line on the water gauge to prevent accidents.

Note:

If issues persist after following troubleshooting steps, contact our service center or an authorized repair center for assistance.

Do not attempt to disassemble the Hot Water Dispenser yourself, as it will void the manufacturer's warranty.

The following cases are exempted from free maintenance or warranty:

1. Failure to present the invoice, pre-pay postage, or submit the warranty registration form to our company.
2. Damage to the Hot Water Dispenser due to inappropriate use.
3. Use for commercial purposes.
4. Damage to the Hot Water Dispenser resulting from unexpected accidents after purchase.
5. Damage to the Hot Water Dispenser due to self-modification or repair.
6. Damage to the Hot Water Dispenser resulting from natural and/or man-made disasters.



NCHUB13

NCHUB24

NCHUB35

Register Product

Thank you for choosing NutriChef. By registering your product, you ensure that you receive the full benefits of our exclusive warranty and personalized customer support. Complete the form to access expert support and to keep your NutriChef purchase in perfect condition.

Start Here



Model Number:
NCHUB13
nutrichefkitchen.com/pages/register