

# PYLE

PyleUSA.com

## HIGH POWER STREET DANCE BOOMBOX



**PBMSPG260L**

**USER MANUAL**

## Location of Controls

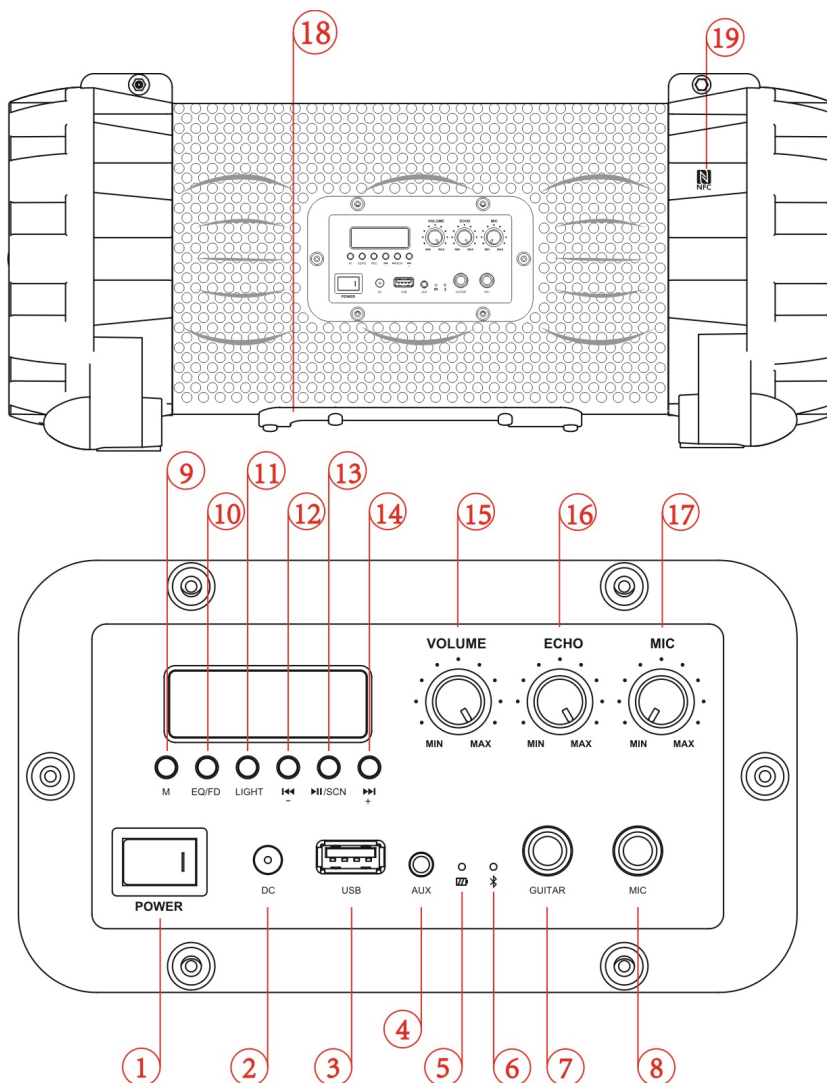

- |                                |                                    |
|--------------------------------|------------------------------------|
| 1. POWER SWITCH                | 11. LIGHT ON/OFF BUTTON            |
| 2. DC IN JACK                  | 12. ⏮ / -                          |
| 3. USB PORT                    | 13. ⏭ / FM SCAN                    |
| 4. AUX IN JACK                 | 14. ⏭ / +                          |
| 5. BATTERY INDICATOR           | 15. VOLUME LEVEL CONTROL           |
| 6. BLUETOOTH INDICATOR         | 16. ECHO LEVEL CONTROL             |
| 7. GUITAR INPUT JACK           | 17. MICROPHONE INPUT LEVEL CONTROL |
| 8. MICROPHONE INPUT JACK       | 18. BATTERY COMPARTMENT            |
| 9. MODE BUTTON                 | 19. NFC AREA                       |
| 10. EQ/FD (EQUALIZER / FOLDER) |                                    |

## Getting Started

---

### Charge the battery

Before using the speaker, you must charge the battery. When the battery is charging, the BATTERY INDICATOR lights solidly. After the battery has fully charged, the light switches off.

1. Connect the AC adapter to the DC IN JACK of the speaker firmly, and plug it into a wall outlet.
2. When the battery is fully charged, first disconnect the AC adapter from the speaker, then from the wall outlet.

### Power source

1. Press the POWER SWITCH to turn on the speaker.
2. Press the POWER SWITCH again to turn off the speaker, and pull the AC adapter out of the wall outlet if you want to switch off completely.

## Bluetooth Function

---

### Pair the bluetooth device

Before using your speaker with a Bluetooth device for the first time, you must pair and connect it to the Bluetooth device. Press the POWER SWITCH to turn on the speaker. The display shows “HI”. Then press the MODE button to select the Bluetooth mode (F1). The “**BLUETOOTH INDICATOR**” starts to flash, and the speaker is now in pairing mode.



F1

### Pair the speaker using NFC

1. With Near Field Communication (NFC), you can easily pair and connect the speaker to Android device with NFC.
2. If the Android device supports NFC, activate its NFC feature, and touch the NFC area of the speaker with the NFC area of your Android device (F2). The speaker pairs and connects to the Android device automatically. For details on NFC, see the user guide of the Android device.

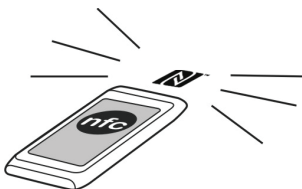

F2

3. For other Bluetooth device, pair the speaker manually.

## Pair the speaker manually

1. Verify that the Bluetooth function of Bluetooth device is enabled.
2. Choose the Bluetooth menu in your Bluetooth device, and from the found devices, select the “P137L”. If you are prompted to enter the PIN code, please enter “0000” (four zeros).
3. For more information, see the user manual of Bluetooth device.
4. After a successful pairing, play the music from the Bluetooth device.

Note:

1. Only one Bluetooth device can be connected to the speaker. If the speaker is already connected to another Bluetooth device, the speaker will not appear in the Bluetooth menu of your Bluetooth device.
2. When you turn off/on the speaker or the Bluetooth device, the speaker will connect to the last Bluetooth device it was used with automatically within 10 seconds. Otherwise, you need to connect it manually on the Bluetooth menu in your Bluetooth device.
3. Depending on the device manufacturer, some Bluetooth devices need to perform the pairing again.

## APP control using hPlay light

1. Please scan the QR Codes or search “**hplay light**” on the Google play or App Store to download the app to your Android or IOS device.



## Using the app “hPlay light

1. Tap the speaker to connect.



2. After connection, slide your finger on the color wheel or tap the circular icon to change the color. Also, you can swipe the screen from left to right on the lower bar to adjust the brightness. Tap on the power button on the top right corner to turn ON/OFF light.

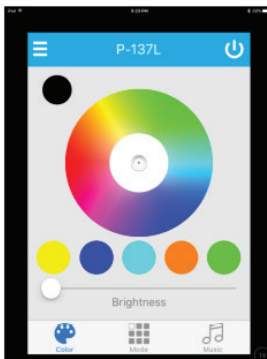

3. Tap “Music” to play local music on your mobile device - iPhone, device.



4. Tap “USB” to play music on USB drive if the USB drive is plugged in.

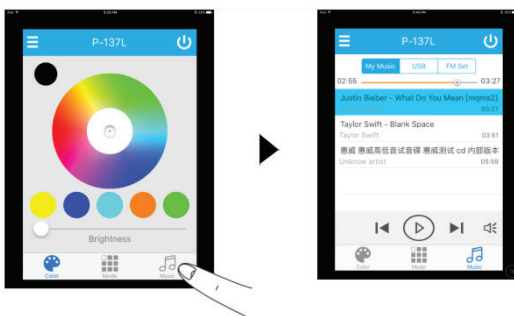

5. Tap “FM Set” to FM radio.



6. Tap “Mode” to light effect. Slide your finger upwards/downwards or tap M+ / M- to change color mod. For each color mode, the light effect pulses to music rhythm. Also, you can slide your finger left and right on the lower bar to adjust its speed of light effect.

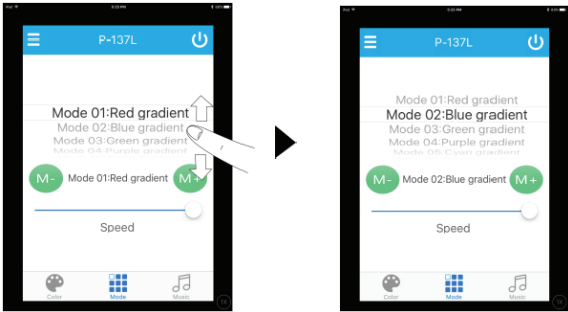

**Aux in function**

1. When the speaker is in Bluetooth mode, press the MODE button to select the Aux in mode (F3).



- 2. Connect an audio cable (not included) to the AUX IN JACK of the speaker and to the audio output socket on the external audio devices such as MP3 player, discman, etc.
- 3. Play from an external audio device.

## Listening to FM radio

1. When the speaker is in Aux in mode, press the MODE button to select FM radio (F4)



2. Press ►| / FM SCAN button to search all the FM stations.
3. When it stops searching FM stations, all the FM stations have been found and stored automatically.
4. Press ◀◀ / - or ►► / + button to explore the found stations (F5).

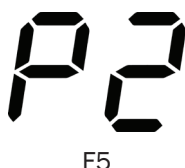

*Remark: you can also use **hplay\_light** APP to control FM radio.*

## Playing audio via USB port

1. When the speaker is in FM radio mode, press the MODE button to select USB mode (F6).



2. Plug the USB device into USB Port, then it will play the music file automatically.
3. For interruption while the music is playing, press the ►| / FM SCAN button once. Playback is now paused. To re-start playback, press the ►| / FM SCAN button again. The music will start from the exact position where it was interrupted.
4. When ◀◀ / - or ►► / + button is pressed once, it will return to the previous track or advance to the next track.
5. During play mode, when ◀◀ / - or ►► / + button is pressed and held, it will search the track with audible high-speed backward or forward playback.
6. Press and hold EQ/FD button will advance to the next folder (F7).



## Connecting a microphone/guitar

---

Using a microphone or a guitar, you can mix its sound with a source sound.

### CAUTION

DO NOT connect a bass guitar to the **MICROPHONE / GUITAR INPUT JACK**, as it may damage the speaker.

1. Turn the **MICROPHONE INPUT LEVEL CONTROL** fully counterwise.
2. Connect a microphone or a guitar to the **MICROPHONE / GUITAR INPUT JACK** of the speaker.
3. Select the Bluetooth, Aux in, FM radio or USB as the source.
4. Start playback of the sound source.
5. Turn the **MICROPHONE INPUT LEVEL CONTROL** to adjust the microphone volume.
6. Turn the **GUITAR OUTPUT LEVEL CONTROL** of your guitar to adjust the guitar volume.

## Party Light

---

Press **LIGHT** button to turn on/off the party light.

## Adjust volume level and sound effect

---

### To adjust the volume

Turn the **VOLUME LEVEL CONTROL** to adjust the volume of the speaker.

### Control the echo

Turn the **ECHO LEVEL CONTROL** to adjust the echo effect.

### Control the EQ

Press the **EQ/FD** button, the sound tone changes as below:

→ **FLAT** → **CLASSIC** → **ROCK** → **POP** → **JAZZ** →

## Features & Specifications

---

### Features:

- Compact, Portable & High-Powered Speaker System
- Audio & Visual Entertainment Stereo BoomBox
- Multi-Colored DJ Flashing LED Lights Pulse to the Music
- Illuminating LED Lights Pulse to the Music
- Control Lighting Effects via the Free Downloadable **“hPlay\_Light”** App
- (2) Wireless Audio Streaming Options: Bluetooth & NFC Technology
- NFC (Near Field Communication) Easily Pairs to Android Devices
- Built-in Rechargeable Battery, Up to 4 Hour Life
- Connect & Stream Audio from External Devices
- Aux (3.5mm) Input Jack
- LCD Digital Display with FM Radio
- USB Flash Reader Input for MP3 Playback
- Mic/Guitar Input for Karaoke Style
- Preset EQ Audio Settings

### Bluetooth Connectivity:

- Wireless Music Streaming Ability
- Compatible with All Your Favorite Bluetooth Devices (iPhone, Android, Smartphone, iPad, Tablet, PC, etc.)
- Bluetooth Version: 4.0
- Bluetooth Wireless Range: 35' ft.
- Bluetooth Network Password: '0000' (4 Zero's)

### What's in the Box:

- BoomBox Speaker
- Shoulder Carry Strap
- Power Adapter Cable

### Technical Specs:

- Sound System: (2) x 5.25" Subwoofers, (2) x 2.5" Speakers
- Housing Construction Material: Engineered ABS
- Battery: Rechargeable Lithium-ion, 6000mAh 7.4V
- Radio Station Memory Presets: 30
- Maximum USB Flash Size Support: 32GB
- Digital Media File Support: MP3, WMA,
- Power: 100/240V (15V DC Power Adapter)
- Dimensions (L x W x H): 24.5" x 9.5" x 10.0"
- Weight: 15.6 lbs.

