

PYLE

PyleUSA.com



PDICBT57- Dual 5.25" Speakers

PDICBT67- Dual 6.5" Speakers

PDICBT87- Dual 8.0" Speakers

*Wireless BT Streaming
Wall / Ceiling Speaker System*

USER MANUAL

REAR SPEAKERS

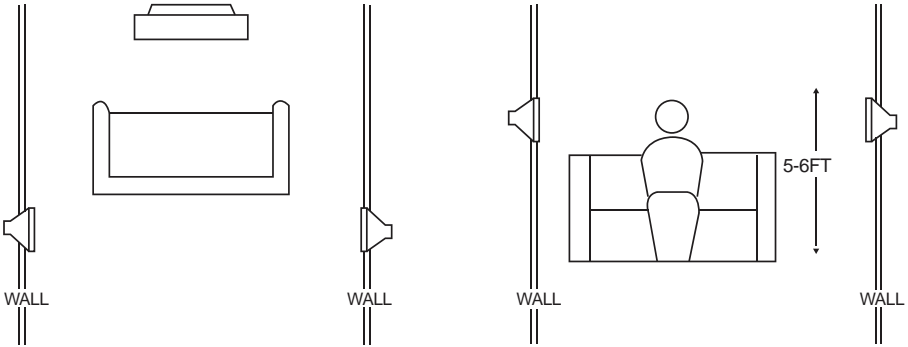

IN-CEILING

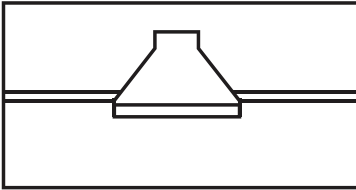

Proper placement of the speakers is an important step in obtaining the most realistic soundstage possible. These recommendations are for the optimum placement of the loud speakers. Use these placement recommendations as a guide. Slight variations will not

diminish your listening pleasure. The front speakers should be placed the same distance from each other as they are from the listening position. They should be placed at about the same height from the floor as the listener's ears will be, with the tweeters aimed toward the listener at ear-level height. In a home theater configuration, the two surround speakers should be placed slightly behind the listening position and ideally should face each other and be at a level higher than the listener's ears. If that is not possible, they may be placed in a wall (or in the ceiling) behind the listening position, facing forward. The surround speakers should not call attention to themselves. They should provide a diffuse, ambient sound accompanying the main program material heard in the front speakers. In Dolby*Digital and DTS systems, aim the tweeters toward the listening position at ear-level height.

Speaker Power Supply Connection:

The active speaker features the power supply for the speaker system. You may choose to use the included power supply adapter to connect directly into the active speaker's power supply input. *Optional power supply connection can be made by directly 'hard-wiring' power supply cables to the speaker's power supply screw terminal post -- as pictured, also located on the active speaker.

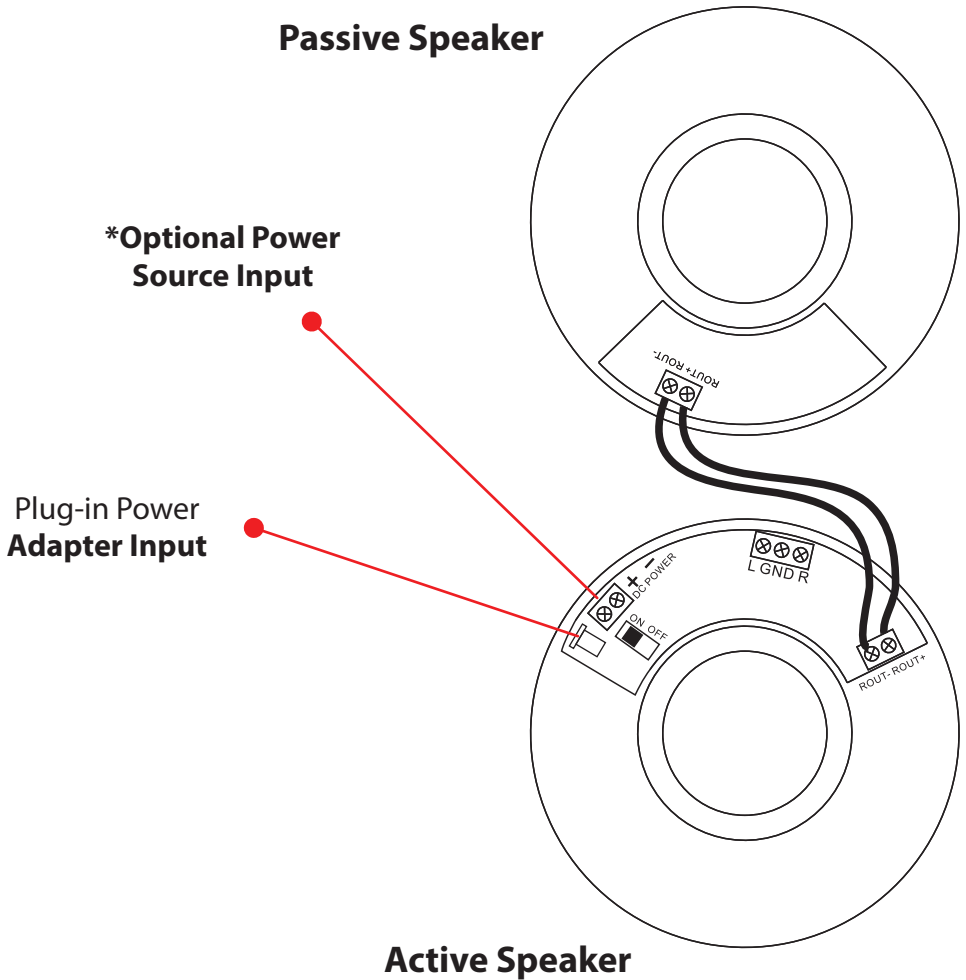

Speaker Connection (Active-to-Passive)

Create the daisy-chain style speaker connection to allow speaker-to-speaker audio communication output. The included speaker wire is used to connect the active speaker to the passive speaker. Ensure proper speaker connection wiring between the speakers.

Passive Speaker

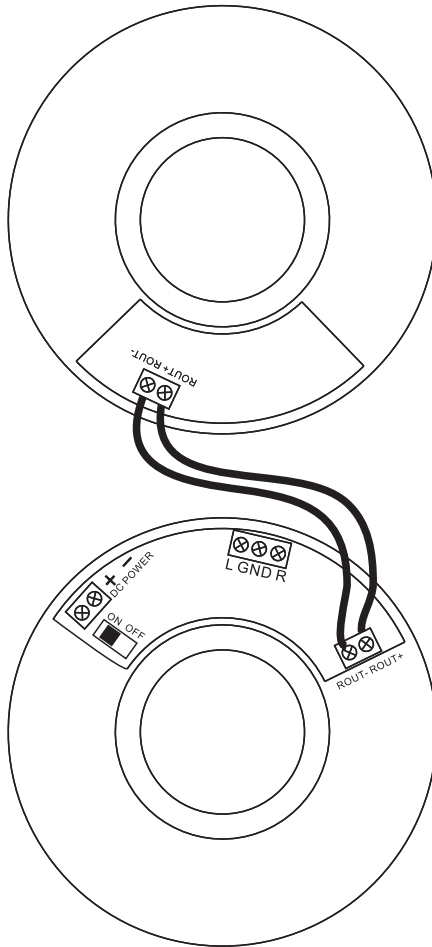

Active Speaker

Bluetooth Pairing

Once the speakers are installed and powered -- search the Bluetooth network name "**Pyle Audio USA**" on your device. Ensure the Bluetooth Receiver Switch is set to ON position -- as located on the active speaker. If you are prompted for a password, enter '0000' (4 zeroes).

Passive Speaker

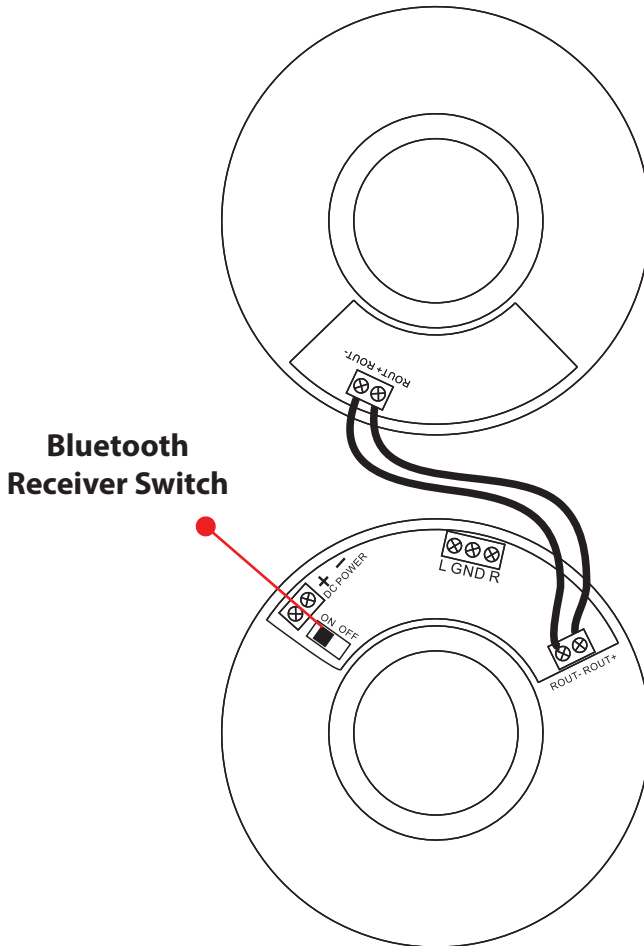

Active Speaker

INSTALLATION

TOOLS NEEDED

The in-wall/in-ceiling speakers were designed to be easily installed. However, if you are unsure of your ability to properly install these loud speakers please contact your dealer or a qualified installer.

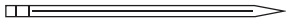

Pencil



Phillips #2 screwdriver

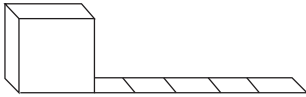

Measuring tape



Utility knife

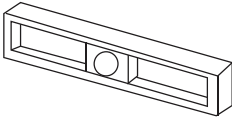

Carpenter's level

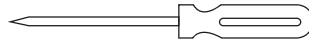

Awl

1. Cut the drywall

Note: Always allow at least one-half inch between a wall stud and the speaker cutout or the locking tabs will not be able to swivel into place.

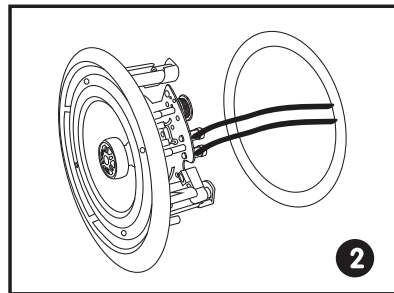
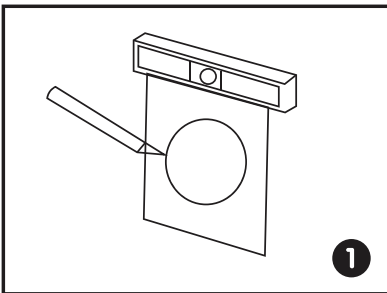

2. Connect the speaker wires to the speaker

3. Screw down each of the four Phillips head screws. The locking tabs will swivel into place and secure the unit to the rear surface of the drywall. Put in the strips of adhesive to secure the grill.

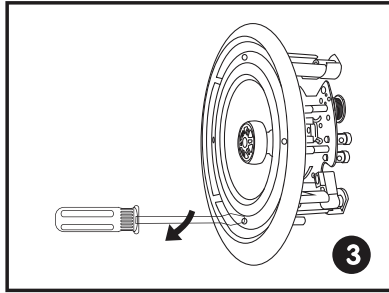

4. Replace the metal grill.

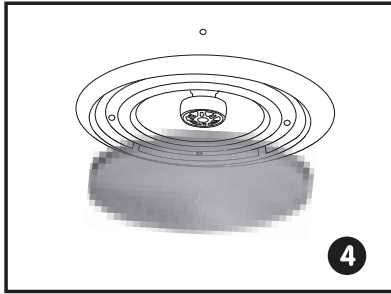

5. Complete

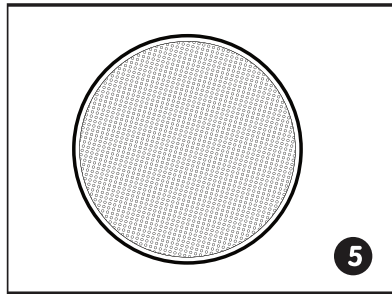

TROUBLESHOOTING

IF THERE IS NO SOUND FROM ANY OF THE SPEAKERS:

- Check that receiver/amplifier is on and a source is playing.
- Check all wires and connections between receiver/amplifier and speakers. Make sure all wires are connected. Make sure none of the speaker wires are frayed, cut, punctured or touching each other.
- Review proper operation of your receiver/amplifier.

IF THERE IS NO SOUND COMING FROM ONE SPEAKERS:

- Check the "Balance" control on your receiver/amplifier.
- Check all wires and connections between receiver/amplifier and speakers. Make sure all wires are connected. Make sure none of the speaker wires are frayed, cut, punctured or touching each other.

IF THERE IS LOW (OR NO) BASS OUTPUT:

- Make sure the connections to the left and right “speaker Inputs” have the correct polarity (+ and -).
- Consider adding a powered subwoofer to your system.
- In Dolby Digital or DTS modes, make sure your receiver/processor is correctly configured. When using a subwoofer, make sure the subwoofer output of the receiver/processor has been enabled. If no subwoofer is being used, make sure the left and right front and rear speakers have been configured as “LARGE” See your receiver/processor’s owner’s manual for further information on correct speaker configuration in Dolby Digital, DTS and other surround sound modes.

IF THE SYSTEM PLAYS AT LOW VOLUME BUT SHUTS OFF AS VOLUME IS INCREASED:

- Check all wires and connections between receiver/amplifier and speakers. Make sure all wires are connected. Make sure none of the speaker wires are frayed, cut, punctured or touching each other.
- If more than one pair of main speakers is being used, check the minimum -impedance requirements of your receiver/amplifier.

PDICBT57 - PDICBT67 - PDICBT87

Wireless BT Streaming Wall / Ceiling Speaker System

MODEL	PDICBT57	PDICBT67	PDICBT87
Sound System	5.25" Speaker + 1" Tweeter	6.5" Speaker + 1" Tweeter	8.0" Speaker + 1" Tweeter
MAX Power Output	240 Watt	300 Watt	400 Watt
Efficiency	86dB	88dB	90dB
Frequency Response	100Hz-20kHz	70Hz-20kHz	50Hz-20kHz
Total Speaker Size	7.8" Diameter, 3.0" Depth	9.4" Diameter, 3.9" Depth	10.7" Diameter, 4.6" Depth
Cut-Out Size	7.0" Diameter, 2.9" Depth	7.9" Diameter, 3.7" Depth	9.6" Diameter, 4.4" Depth

Features:

- Includes (2) Speakers (Active + Passive)
- Bluetooth Wireless Music Streaming Ability
- 2-Way Full Range Stereo Sound
- Built-in Digital Sound Amplifier
- Mounts Flush to Walls or Ceilings
- Screw Terminal Block Speaker Connectors
- Ability to Daisy-Chain Speakers for Stereo System Sound
- Environmentally Friendly ABS Construction
- Perfect for Custom Installations & Applications

Bluetooth Connectivity:

- Includes Bluetooth Control Receiver
- Stream Wireless Audio from Your Connected Device (Smartphone, Tablet, Laptop, Computer, etc.)
- Bluetooth Network Name: 'Pyle USA'
- Bluetooth Network Password: '0000' (4 Zeroes)
- Bluetooth Version: 3.0
- Wireless Range: Up to 40'+ ft.

What's in the Box:

- Active Speaker
- Passive Speaker
- 12V Power Adapter
- Speaker Connection Cable, 16' ft.

Technical Specs:

- Impedance: 8 Ohm
- Power: 100/240V, 12V Power Adapter
- Sold as: Pair

PYLE

PyleUSA.com



VISIT US ONLINE:

Have a question?

Need service or repair?

Want to leave a comment?

PyleUSA.com/ContactUs

PYLE