

# MINI DEHUMIDIFIER USER MANUAL

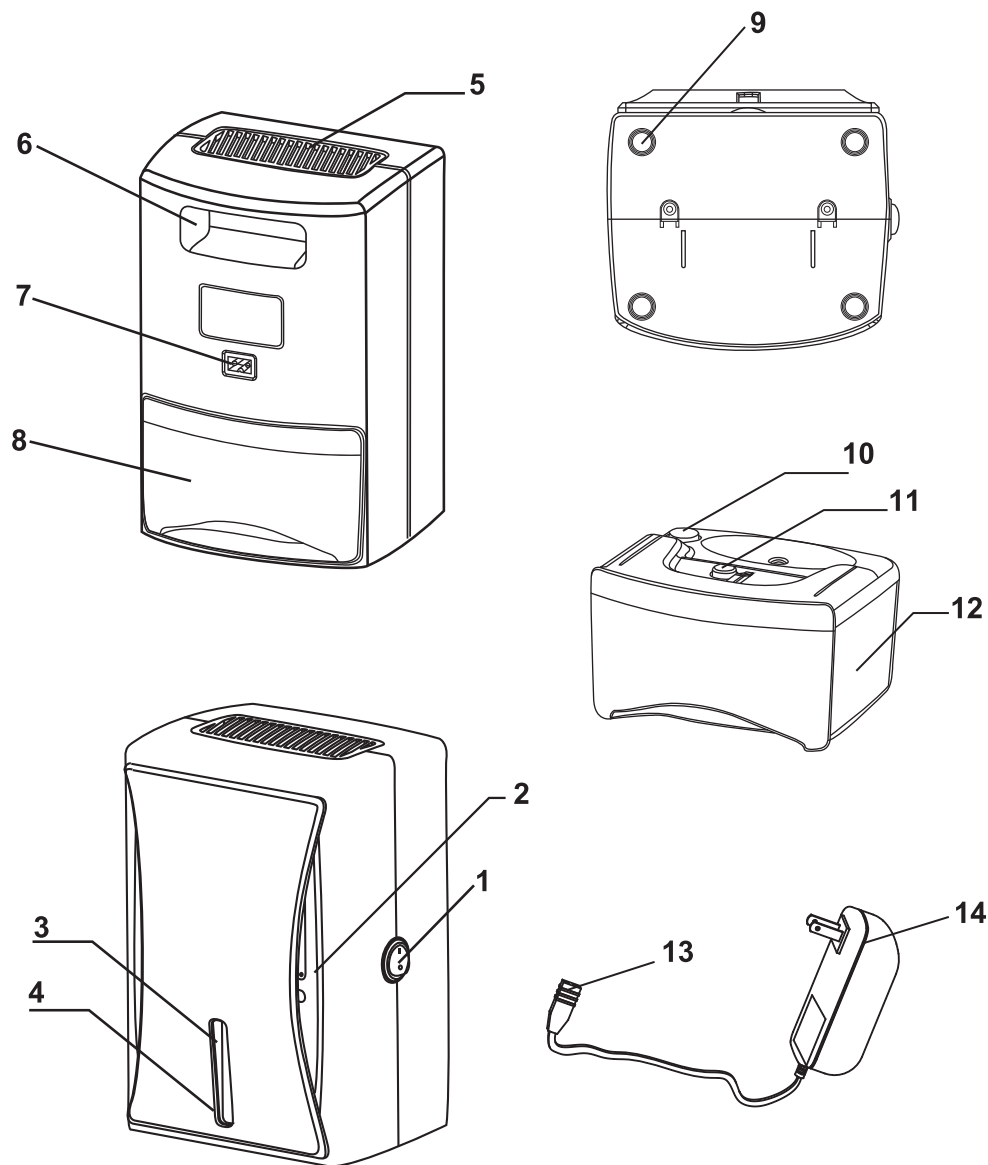



1. After you are finished using the Dehumidifier, the user should switch the unit off by pressing the “On/Off” button to “Off” position.
2. Avoid using the AC/DC power adaptor in wet or damp place, and position it in areas where the air ventilation is good.
3. Keep the front inlet grill and the top outlet free from air blocking materials such as clothing, plastic bag or papers.
4. If the unit has been properly connected and no power is flowing, remove the AC/DC power adaptor and have the dehumidifier unit checked by a qualified electrician.
5. Always keep the unit at an up-right position to avoid water leakage.
6. Mini Dehumidifier should not be operated for a long time. Use a timer to automatically turn the machine on/off the unit every 12 hours to prolong the lifespan of the unit.

**Cooling element** : Thermo-electric peltier module  
**Fan** : DC Brushless motor  
**Power adapter** : 9V DC 2.5Amp  
**Power consumption** : 22.5W

**Water Level Detector** : Automatic switch off with “Yellow” LED Indicator when the water tank is full

**Drying feature** : Warm air outlet on top for drying purposes

**Product Dimensions** : 5.32” ( W ) x 5.75”( D ) x 8.78” ( H )

**Working environment** : Over 50°F, over 40% RH

1. After removing the packaging materials, there should be 2 items:
  - a. Dehumidifier
  - b. AC/DC Power adaptor
2. Plug the DC power jack of AC/DC power adaptor to the DC Power socket , then connect the AC plug of the AC/DC power adaptor to the appropriate main socket.
3. Press the “On/Off” button to “On” position. The green LED will be turned on. The Mini Dehumidifier will begin to operate. You should able to feel the air blowing from dry air outlet [Fig.1]
4. To switch off the unit, press “On/Off” button to “Off” position, the Mini Dehumidifier will be turned off.[Fig.2]



When the water tank is full, the unit will be switched off automatically and the “Yellow” LED will be on. [Fig.3]



To remove the water tank, first switch off the Dehumidifier, press “On/Off” button to the “Off” position. Then, remove the water tank from the unit and pour the water out to the toilet or bathroom sink. Put the water tank back into the unit. To continue dehumidifying, push the “On/Off” button to “On” position again.

After long hours working, inside filter will accumulate dust. Before cleaning it, turn off the Petite Dehumidifier and unplug the AC plug from the main socket first, then remove the front cover (15) and take out the filter (16) to wipe off the dust on it with water (as Fig.4). After you are done, you may put the filter back on the machine for using. Cleaning the filter will prolong the life of the dehumidifier.

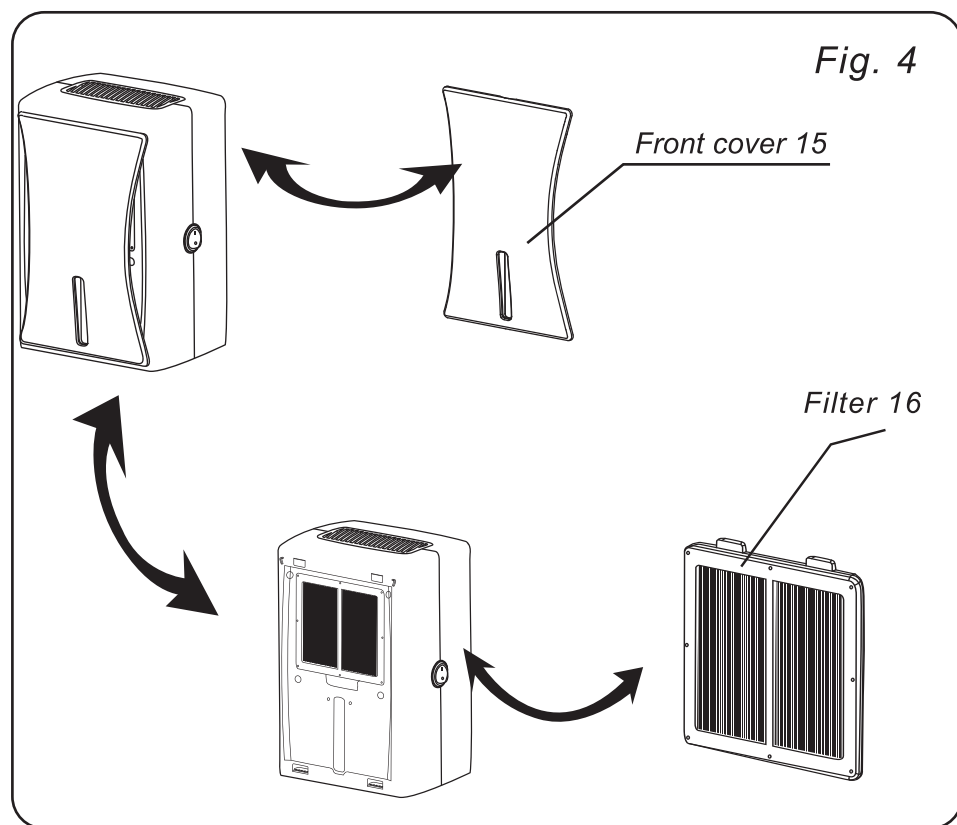

The Mini Dehumidifier Uses Petite technology (no compressor) which makes it light and quiet. It is perfect for small rooms. Poor ventilation causes musty odor and fungus in wardrobes, larder, etc. The Mini Dehumidifier eliminates this problem by keeping them free of unwanted moisture.

- (1) On/Off button
- (2) Air Inlet
- (3) “On” Blue LED/“Full” Yellow LED
- (4) Water Level Detector
- (5) Dry air Outlet
- (6) Handle
- (7) DC Power Socket
- (8) Removable Water Tank
- (9) Rubber feet
- (10) Water displacement hole
- (11) Float switch
- (12) Water tank
- (13) DC power jack
- (14) AC/DC switching model supply

- To avoid electric shock, do not open this machine. There are no user-serviceable parts inside.
- Any repair work must be done by qualified technician appointed by our distributors.
- Specifications are subjected to changes for improvement without prior notice.