



Visit Our Website



SCAN ME
PyleUSA.com



6-String Classic Guitar

Guitar with Digital Tuner and Accessory Kit

USER GUIDE

Please take a few moments to read through this booklet.

In it you will find answers to many of your questions and other invaluable information about how to attach a guitar strap and how to tune a guitar.

Instructions

A. How to attach a guitar strap?

1. Adjust your guitar strap to the correct size.



2. Take the looped end of your string and thread it through the key hole on the front of your strap, tying a knot close to the hole.



3. Adjust your guitar strap to the correct size.



4. Run one side of the string through the headstock and tie a knot on the other side.



5. Ready to Play now!



B. How to tune a guitar (for first time user)

1. Hold the strings down with your left hand while stretch the strings away from the body with your right. (image 1)
2. Use some pressure to wiggle strings back and forth. You don't need to be gentle but make sure you don't pull too hard once you feel the string resisting or it can break. (image 2)



BASIC RUNDOWN OF TUNING A GUITAR

1. Memorize what the strings are on the guitar. (E – Low version, A, D, G, B, E – High version) (image A, B)
2. Look at the tuners of the guitar. (image C)



3. Pluck the string with a pick or if not with the pick then with your finger and when you move the tuner around, you can hear the pitch get lower. You can turn it the other way and tighten it and you hear the pitch get higher.



4. You can also use clip-on tuners then put on the headstock because it reads the vibration off the guitar and tells what note it is or it's close to.



5. Move the needle of the tuner to get the right tune of the string. If the needle goes too far, bring it back down and even lower than the notes needs to be and then bring it back up until the needle hits the right tune of the strings.



6. Once you've tuned all the strings, you can gently tug each string at the the middle back and forth to help stretch it. When stretched the string will drop pitch and go out of tune. After stretching re-tune each string and repeat this process 6-8 times. This stretching process is only necessary for new strings and the instrument will hold better in tune after they are broken in.



How to Adjust an Acoustic Guitar Truss Rod

Your truss rod needs adjustment when the neck of your guitar has too much or too little upbow or too much backbow.

Tightening or loosening the adjustment nut adds or lessens pressure on the rod and neck. As a general rule, tightening the nut moves the neck away from the string pull and removes upbow; loosening the nut allows the neck to relax into an upbow again (especially when helped by the strings' pull). Controlled upbow is known as relief.

However, with a one-way truss rod, if the neck warps away from the string pull, no amount of loosening the truss rod will pull the neck straight, because the truss rod only works against the pull of the strings.

Two primary signs tell you that your truss rod needs adjusting:

1. There's a noticeable change in the action; the height of the strings over the frets has become either too high or too low.
The most common scenario is that the strings get higher as the neck upbows from the string pull.
2. Some strings buzz on the frets between the nut and the fifth fret.
This indicates that the neck is either too straight or it is backbowed from the truss rod's slow, constant pressure over time.

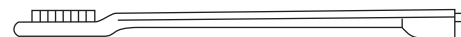
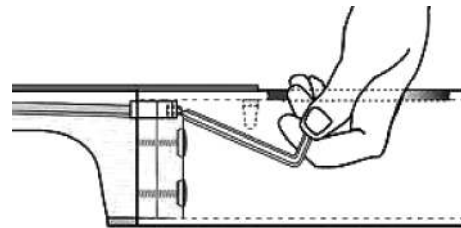

ADJUSTMENT NUT

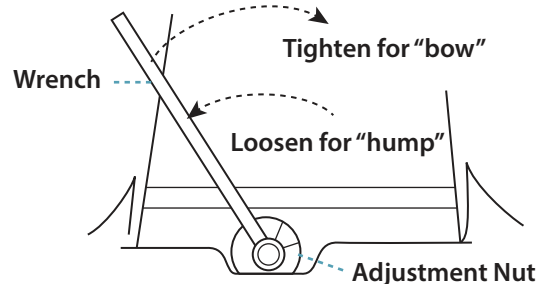

1. 1/4" nut
2. 3/16" washer
3. Threads
4. Main shaft of the truss rod
5. Truss rod anchor
6. Truss rod compartment cover
7. 1/4" nut driver

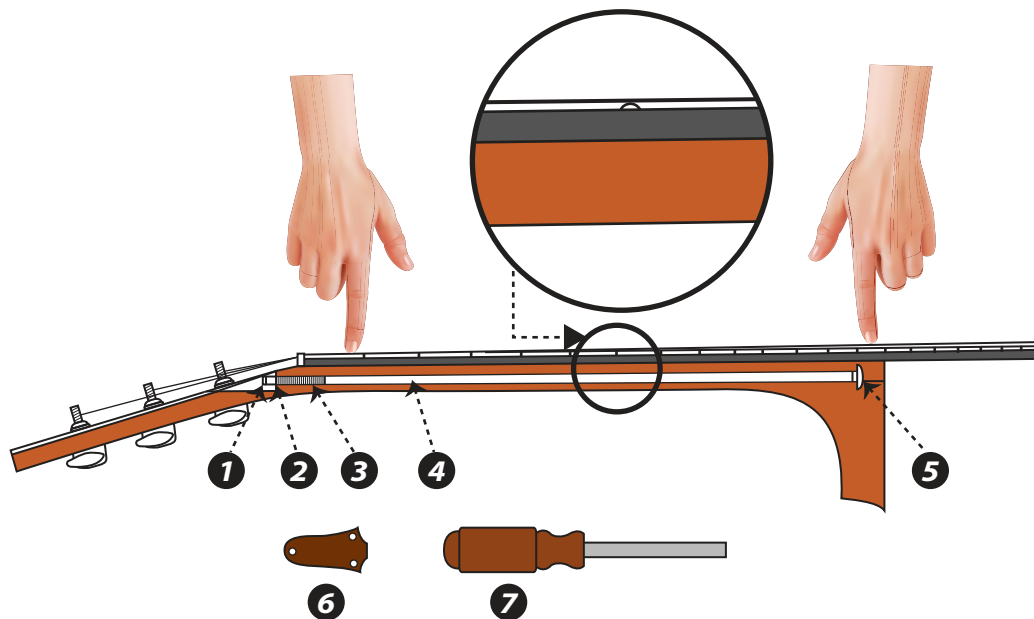

As you press the string down at the 1st and 14th frets, the string should be approximately .010" away from the 6th fret - about the thickness of a business card

Register Product

Thank you for choosing PyleUSA. By registering your product, you ensure that you receive the full benefits of our exclusive warranty and personalized customer support.

Complete the form to access expert support and to keep your PyleUSA purchase in perfect condition.



[PyleUSA.com/register](https://www.pyleusa.com/register)



Questions or Comments

We are here to help!

Phone: 1.718.535.1800

PyleUSA.com/ContactUs