

95mm

PHLTBS51Sonic Toothbrush Plus UV Sanitizer

IMPORTANT SAFEGUARDS

The PHLTBS51 has been carefully designed to offer you and your family a new and unique brushing experience, that is both safe and effective. However, When using the electrical products, especially when children are present, basic safety precautions should always be followed, including the following:

READ ALL INSTRUCTIONS BEFORE USING DANGER

To reduce the risk of electrocution:

- Always unplug this product immediately after using.
- Do not use while bathing.
- Do not place or store product where it can fall or be pulled into a tub or sink.
- Do not place in or drop into water or other liquid.
- Do not reach for a product that has fallen into water. Unplug immediately.
- Specific instructions for the proper method of cord storage, total product storage, and the like when the product is not in use; and for cord white in use, such as for hand supported products, untwisting and the like.

WARNING

To reduce the risk of fire, electric shock, or injury:

- Do not leave Appliance when plugged in. Unplug from outlet when not in use and before servicing
- Do not allow to be used as a toy. Close attention is necessary when used by or near children.
- Use only as described in this manual. Use only manufacturer's recommended attachments.
- Do not use with damaged cord or plug. If Appliance is not working as it should, has been dropped, damaged, left outdoors, or dropped into water, return it to a service center.
- Do not pull or carry by cord, use cord as a handle, close a door on cord, or pull cord around sharp edges or corners. Do not run Appliance over cord. Keep cord away from heated surfaces.

- Do not unplug by pulling on cord. To unplug, grasp the plug, not the cord.
 - Do not handle plug or Appliance with wet hands.
 - Turn off all controls before unplugging.
 - This cover is provided with an interlock to reduce the risk of excessive ultraviolet radiation. Do not defeat its purpose or attempt to service without removing.
- LAMP INTENDED FOR REPLACEMENT BY QUALIFIED SERVICE PERSONNEL ONLY.**
- Never block the air openings of the product or place it on a soft surface, such as a bed or couch, where the air openings may be blocked. Keep the air openings free of lint, hair, and the like.
 - Never use while sleeping or drowsy.
 - Never drop or insert any object into any opening or hose.
 - Do not use outdoors or operate where aerosol (spray) products are being used or where oxygen is being administered.
 - Connect this product to a properly grounded outlet only. See grounding instructions.
 - Unplug this product before filling. Fill (reservoir) with water only unless otherwise specified by manufacturer. Do not overfill (or specify filling instructions).

SAVE THESE INSTRUCTIONS

Household Use Only

PLEASE READ CAREFULLY BEFORE USE:

- This product has no user serviceable parts.
- Store the charging unit onto a dry and safe place when it is not in use.
- Untwisted the power cord before use.
- In case of the product failing to function, you should not dismantle, exchange or manipulate any part of it, otherwise there is the risk of an electric shock. You should take it to the seller.
- If the supply cord is damaged, it must be replaced by the manufacturer in order to avoid a hazard. You should contact the seller.
- If the product is dropped, the brush head should be replaced before the next use even if no damage is visible

- This appliance has a polarized plug (one blade is wider than the other). As a safety feature, this plug will fit in a polarized outlet only one way. If the plug does not fit fully in the outlet, reverse the plug. If it still does not fit, contact a qualified electrician. Do not attempt to defeat this safety feature.

Declaration

The toothbrush is conformity to the applicable provisions of applicable US Federal requirements, including 21 CFR, Chapter 1, Subchapter J, Radiological Health.

LIST OF COMPONENTS

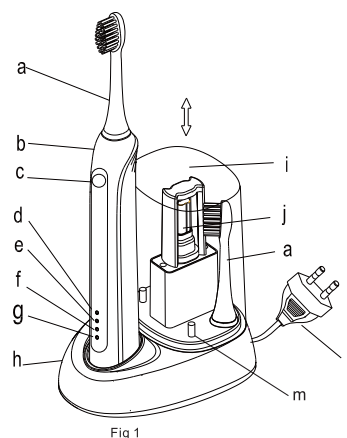

- | | |
|-------------------------------------|-------------------------------|
| a. brush head | g. Charger indicator |
| b. Handle | h. Charger station/UV chamber |
| c. On/off & brushing mode button | i. UV shield cup (Water cup) |
| d. Normal working mode indicator | j. UV Lamp |
| e. Whitening working mode indicator | k. Cable |
| f. Massage working mode indicator | m. Brush head station |

Connecting and Charging (Fig 2)

- PHLTBS51 has a **waterproof handle**, it is electrically safe and is designed for use in the bathroom.
- Plug the adaptor (k) into an electrical outlet, cover the UV shield cup (i), the UV light (j) will turn on, you can see the UV shield cup, the UV light will turn off automatically by auto timer after 6-8 minutes.
- Put the toothbrush handle (b) onto the charging station (h). The charging indicator (g) should be lit. A full charge takes at least 24 hours and enables approximately 6 weeks of regular brushing. Charging indicator is shining when full charge.
- Pull plug out of outlet for saving energy, or leave it and keep the brush on charging base, there is no risk of overcharging of battery.

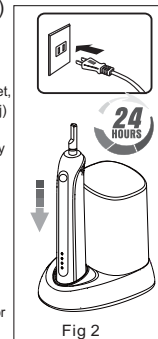

Using PHLTBS51

- Take out the UV shield cup (i), fill clean water into the cup for washing. (Fig 3)
- Take out a brush head (a) and the handle. Attach a brush head to the handle. There will be about 0.5 mm space between the brush head and the handle. (Fig 4)
- You can use any kind of toothpaste. Wet the bristles and apply a small amount of toothpaste.
- Place the bristles against the teeth at a slight angle towards the gum line. (Fig 5)
- Press the button to turn on the toothbrush. There are 3 modes.
- After brushing, take down the brush head from handle.
- Rinse both the brush head and handle under running water and wipe them dry. (Fig 6)
- Put the handle back into the charger. put the brush head into the brush station, put back the UV shield cup to UV chamber.

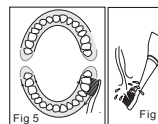
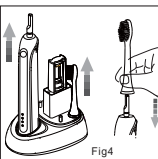
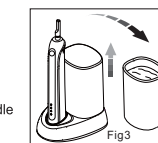

● Brushing Technique:

- > Guide the brush head slowly from tooth to tooth
- > Hold the brush head in place for a few seconds before moving on to the next tooth
- > Brush the gums as well as the teeth, first the outsides, then the insides, finally the chewing surfaces
- > Do not press too hard or scrub, simply let the brush do all the work

● Brushing Modes

PHLTBS51 offers different brushing modes for varying oral care needs:

- <<Normal>> – Exceptional mouth cleaning
- <<Whitening>> – Gentle, yet thorough cleaning for sensitive areas
- <<Massage>> – Gentle stimulation of gums

● Two minutes auto-timer:

PHLTBS51 is designed to reach proven and best brushing timing (2 mins) after 2 minutes brushing, the device stops operating automatically, every 30 seconds the device will keep and alert you change brushing area. Generally, people divide the teeth and gum into four areas for brushing.

● How to switch between brushing modes:

>Power on/off and brushing mode selection are controlled by on single press button, it is called on/off & brushing mode button (c).When keeping on pressing this button, the working sequence as power on and work in the <<Normal>> mode –<<Whitening>> mode –<<Massage>> mode– power off, the device will turn off if any mode working over 5 seconds.

PHLTBS51 automatically starts in the <<Normal>> mode when pressing the on/off & brushing mode button once.

>To shift from the<<Normal>> to <<Whitening>> mode, press the on/off & brushing mode button one more time.

>If you wish to use the<<massage>> mode, press the on/off & brushing mode button one more time again.

>When you press the on/off & brushing mode button, the brushing mode indicator will be lit, you know which mode you are selected and brushing.

>To turn your brush off, press the on/off & brushing mode button, if the brush handle works in<<Normal>> mode, you need to press the button three times to power off the device.If the brush handle works in<<Whitening>> mode, you need to press the button twice to power off the device. If the brush handle works in<<massage>> mode, you need to press the button once to power off the device.

● How to sanitize your Brush heads

This product includes a UV sanitizer to sanitize the brush heads between use. The sanitizer has been proven 99.9% effective against E.Coli, Candida Albicans, Salmonella and H. Simplex.

- > Insert the brush heads to the small shafts on the brush station (m) .Make sure the bristles of brush head are facing to the UV lamp.
- > Put back the shield cup , the UV tube will light up and will shut-off automatically after approximately 7 minutes. If the cover is opened accidentally when the UV tube is operating, The UV tube will be automatically turned off

>The brush heads are recommended to be sanitized before and after every use of your sonic toothbrush.

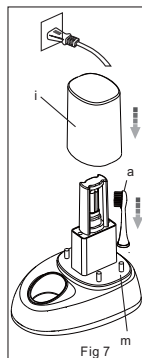

Cleaning and recommendations

- After brushing, rinse your brush head thoroughly under running water.
- Remove the brush head from the handle and clean both parts separately under running water. Then wipe them dry before you put the handle onto the charger station and put the brush head into the UV chamber, take back the cup to the charger station.
- Before cleaning your charger station, make sure unplug the adaptor, and only use dry or damp-dry cloth to wipe the surface . Important, do not clean the charger unit under running water or immerse it into water
- Place the charger station on dry and safe place.
- This product contains rechargeable batteries. In the interest of protecting the environment, please do not dispose of the product in the household waste at the end of its useful life .Disposal can take place at appropriate collection points provided in your country.

PHLTBS51

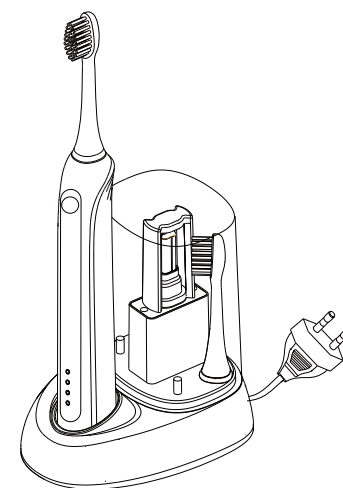

Pyle Health Ultrasonic Wave
Rechargeable Electric Toothbrush
w/ Ultraviolet Sanitizer

