

Visit Our Website



SCAN ME
serenelifehome.com

serenelife™



PHSPAMT22 - AZPHSPAMT22 - PHSPAMT24HT
Bubble Bath Mat Body Spa Massage

USER GUIDE

BUBBLE BATH SPA MAT

Model #: PHSPAMT22 / AZPHSPAMT22 / PHSPAMT24HT

IMPORTANT SAFETY INSTRUCTIONS KEEP INSTRUCTIONS FOR FUTURE USE

When using electrical products, especially when children are present, basic safety precautions should always be followed:

READ ALL INSTRUCTIONS BEFORE USING THIS PRODUCT

DANGER: To reduce the risk of electric shock:

- Always unplug the product from the electric outlet immediately after using (and before cleaning).
- If the appliance falls into water, unplug it immediately. Do not reach into the water.
- Do not place or store appliance where it can fall or be pulled into a tub or sink. Do not place or drop into water or other liquid. Store in dry place.
- This appliance has to be positioned so that the plug is accessible.
- Parts incorporating electrical components must be located or fixed so that they cannot fall into the bath



**Do not use or put up over bathtubs, showers or any basin etc. filled with water.
Do not submerge the appliance in water or liquid!**

WARNING: To reduce the risk of burns, electrocution, fire, or injury to persons:

- The appliance should never be left unattended when plugged in. Always unplug the appliance when it is not in use.
- Close supervision is necessary when this appliance is used by, or near children, or disabled people.

- Use this appliance only for its intended use as described in this manual. Do not use any attachments that have not been recommended by the manufacturer.
- Never operate the appliance if it has a damaged cord or plug, if it is not working properly, if it has been dropped or damaged, or dropped into water. Return this appliance to the service center for examination and repair.
- Do not put and use the appliance next to/near electric heaters, hot surfaces or any heat sources. Fire, electric shock or injury might occur.
- Do not carry this unit by holding the power cord.
- Using the appliance for more than 30 minutes is not recommended. Continuous use could lead to the product being overheated. When the product is overheating, stop using it and allow it to cool down before operation.
- Keep the power cord away from heated surfaces.
- Disconnect the power cord by holding the plug attached to the cord instead of pulling the cord itself.
- Do not stand on this appliance.
- Never operate this appliance near an electrical oven or any heat source.
- Never operate the appliance if any openings are blocked. Keep the openings free of lint, hair and other particles.
- Do not use the appliance outdoors or operate it where aerosol (spray) products are being used or where oxygen is being administered.
- Do not use this product if you have sensitive skin or poor circulation.
- The use by unattended children or incapacitated persons can be dangerous.
- Never use while sleeping or drowsy.
- Do not plug in the appliance before the tub is filled with water.

- Do not overfill the tub and make the water run over the edge after you enter it.
- Never drop or insert any objects into any opening or the tube.
- Always ensure that the air inlet on the underside of the main unit is not covered.
- This appliance is equipped with a protective device which may make the appliance not operable under certain conditions (such as immersion of the appliance). If the appliance becomes inoperable, return it to the service center for examination and repair.
- Do not use this product with an extension cord.
This will damage the circuit protector.
- The appliance is designed to work with ordinary household current only at 120volts A.C., 60 Hz.

INSTRUCTIONS

CAUTIONS

- Never use this appliance as a substitute for medical attention. Persistent ailments and symptoms could be more serious and should be investigated.
- This appliance should not be used in the following cases: Tuberculosis, benign and malignant tumors, hemorrhages, inflammations on the skin, phlebitis and thrombosis, open and fresh wounds, bruises, broken skin or varicose veins, or undetermined calf pain.
- Consult your physician, if you have any therapeutic questions regarding its use.
- Do not use on any unexplained pain before consulting your physician.
- Stop using the product if the pain increases or the swelling occurs after application.
- Do not use on any part of the body that is anesthetized.

- Do not use on any part of the body where surgery has been performed recently.
- It should not be used by children younger than 12 years old.
- It should not be used by people during pregnancy or anyone with high blood pressure or a heart condition.
- Do not use the appliance if you have sensitive skin.
- This appliance should not be left with children without supervision in order to avoid from being played with.
- As additional protection, the installation of residual current device (RCD) with a rated breaking current of not more than 30mA is recommended in the electric circuit of the bathroom. Please consult a qualified electrical engineer.

APPLIANCE CONTENTS:

1. MAIN UNIT

- 1.1 Main unit
- 1.2 AC power cord (9.8 ft., approx.)

2. AIR HOSE

- 2.1 Air hose (8.2 ft., approx.)
- 2.2 Hose end with valve and aroma clip
- 2.3 Hose end without valve

The hose end (fig 2.2) should be plugged into the airflow hole of the main unit, and the other hose end (fig 2.3) should be connected to the bath mat (fig 3).

3. BATH MAT WITH SUCTION CUPS ON UNDERSIDE (Only used for non-textured bathtubs)

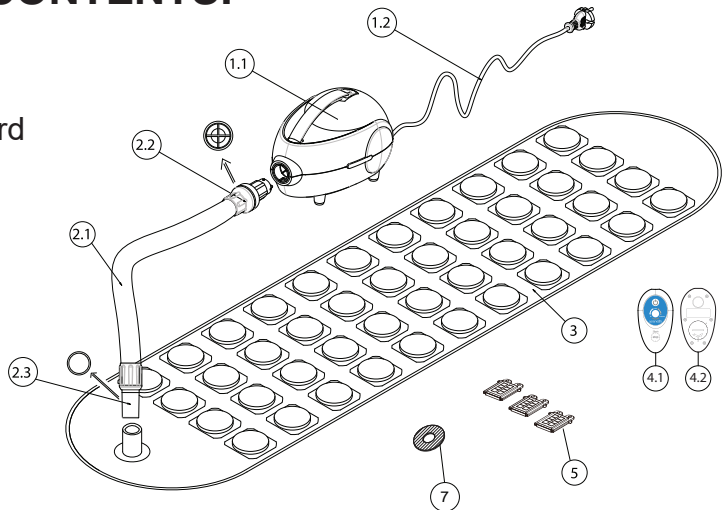

- 3.1 There is a pair of release tabs on every suction cup (fig. A)
- 3.2 To remove the bath mat from your bathtub, pull on the tab of the suction cup to allow some air in and then pull up slowly (fig. B). Starting from one side of the bath mat and pull each suction cup up in order. If you feel some resistance, gently slide your fingernail under the suction cup to help break the seal. Please follow our suggestion and do not pull the suction cup too hard. Not only the bath mat will be damaged, but the reaction force could also cause you to slip and get hurt.

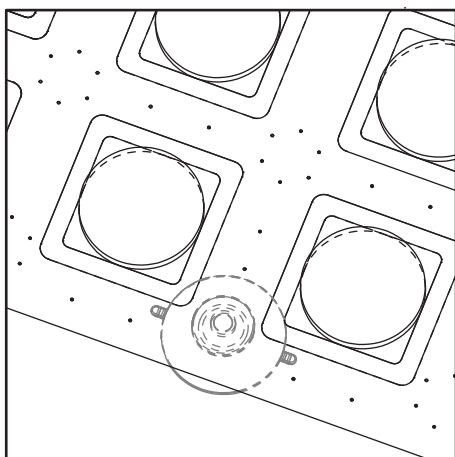

A

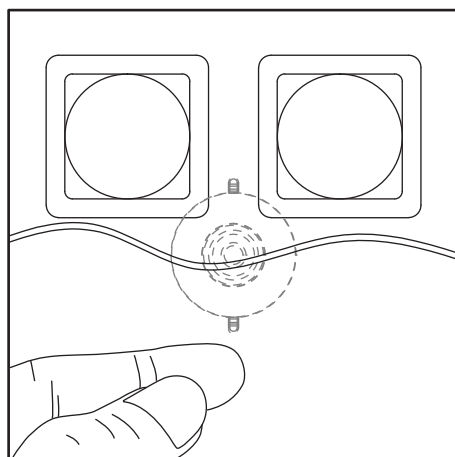

B

4. REMOTE CONTROL

- 4.1 Remote control with function buttons
- 4.2 Suction cup of the remote control and the battery (CR2032) compartment

5. 3x AROMA CLIP WITH PADS

6. SPARE COTTON PADS FOR AROMA CLIP (NOT SHOWN)

7. 8X DOUBLE-SIDED ADHESIVE PLATE

ASSEMBLY:

1. Remove the main unit and all accessories from the box and check for any damage.
2. Ensure the Control Unit is unplugged.
3. Place the control unit on the floor or a level, sturdy surface near your bathtub.
4. Do not place the unit where it can fall into the bathtub.
5. Make sure the ON/OFF switch is in the "O" position.
6. We suggest giving your bathtub a deep cleaning for better adhesion of the bath mat to the tub floor. The mat's suction cups may not adhere properly if the bathtub surface is rough, stained, or dirty.
7. The suction cups will adhere better if they are slightly wet.
Put a small amount of water on the tub floor to ensure each suction cup has enough moisture to attach securely to the bathtub.
8. Place the bath mat into the bathtub and press down on each suction cup individually to remove air from the suction cup. Ensure the bath mat is firmly attached to the tub floor and does not slide around.
9. If any part of the bathtub surface is worn down and prevents the suction cups from adhering, use the double-sided adhesive plates (refer to "DOUBLE-SIDED ADHESIVE PLATE" section for detailed instructions) to secure them.
10. The connector on the bath mat should be positioned where your feet will be.
11. Connect the hose end with the valve and aroma clip to the main unit and lock it by turning it counterclockwise.
12. Connect the other hose end to the connector on the bath mat.
13. The bath mat length is 3.9 ft. If the tub floor is shorter than 3.9 ft., extend the bath mat to where your back will be. Avoid folding or obstructing the bath mat connector.

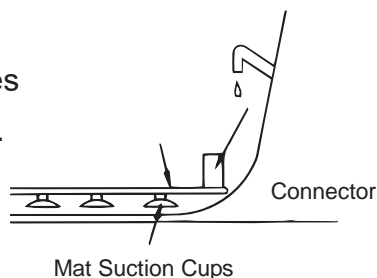

14. After confirming that the bath mat is securely fixed, start filling the tub with water. It will be more difficult to reposition the suction cups if the water level is higher than 2 inches. You may switch on the device (see "SET CONTROL" section) at this water level to check if all suction cups are properly secured.
15. The bathing water level is recommended to be lower than two-thirds of the bathtub (Fig. 2).
16. Ensure the bathroom has a comfortable room temperature and start enjoying your bubble spa.

TIPS TO OPTIMIZE USER EXPERIENCE

1. Please ensure the bath mat lies flat at the bottom of the bathtub, and the hose end remains unobstructed (Fig. 2).

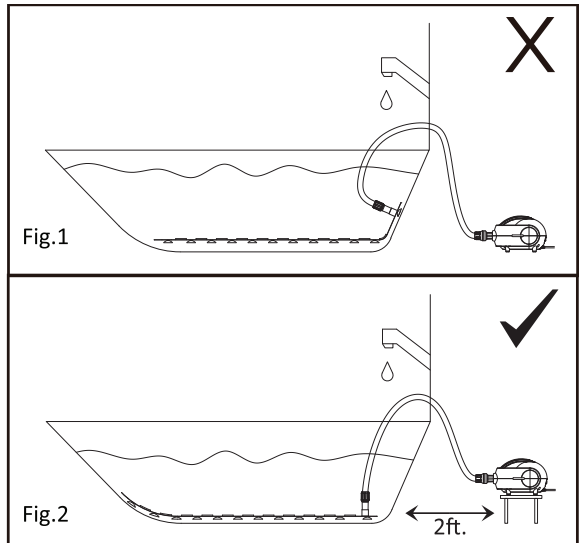

2. This product is not designed to be used with any soaps, gels, shampoos, or similar products. Soaps can prevent the suction cups from adhering to the bathtub, and bubbles may overflow, increasing the risk of slipping.
3. **The device has three bubble intensity modes: LOW, HIGH, and PROGRAM.** Strong bubbles in HIGH mode may overflow from the bathtub. Exercise caution for safety.
4. We recommend placing the main unit at a height of 1 ft. from the ground, ideally on a solid stool, and 2 ft. away from the bathtub (Fig. 2) to keep it dry.

5. When operating the device at HIGH bubble intensity, the volume of water bubbles and the operational sound from the main unit's built-in motor system will increase. If the operating sound concerns you, consider placing the main unit at a greater distance from the bathtub to minimize its impact.
6. This product does not heat up the water in the bathtub.
7. Millions of air bubbles generated quickly may reduce the water temperature. If the water temperature drops, add warm water to maintain a comfortable heat level.

AROMA CLIP ASSEMBLY:

- Put a drop of essential oil on the cotton pad, place the cotton pad inside the aroma clip, and close the aroma clip (Fig. 1).
- Insert the aroma clip into the tube end (Fig. 2).
- Plug the air hose into the main machine (Fig. 3).

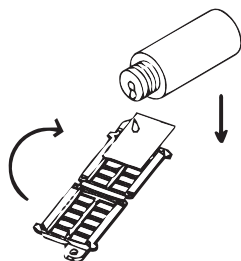

Fig. 1

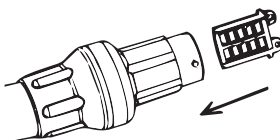

Fig. 2

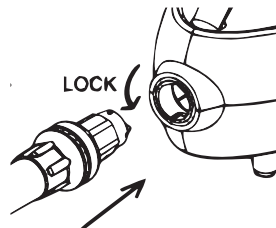

Fig 3

Note:

- The cotton pad is reusable.
- Using too much essential oil may cause erosion of the aroma clip.

USER MAINTENANCE INSTRUCTIONS:

The bubble bath can be controlled directly from the unit by using the on/off switch or with the remote control.

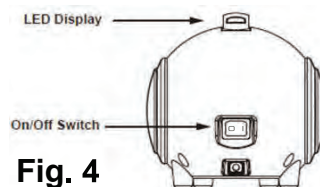

Fig. 4

SET CONTROL

The **Power button** (ON/OFF switch) is on the back side of the device. (Fig.4).

“O”: The product is OFF and cannot be operated by remote control.

“I”: The product runs automatically at low intensity.

Use the remote control to adjust the intensity or turn it off.

The appliance switches off automatically after 20 minutes.

Please always set the ON/OFF switch to "O" when you finish using the device each time.

REMOTE CONTROL

This unit can be operated with the remote control by pointing the remote at the infrared sensor on the handle of the main unit and pressing the function button. The remote control comes with a suction cup on the back. Slightly wet the suction cup and press it firmly to the bathroom wall or the side of the bathtub.

Do not immerse the remote control in water.

Once the appliance is in place, you can turn on the device by pressing the power button after carefully getting into the bathtub. There are three bubble intensity levels, which can be adjusted using the remote control (see Fig. 5). The selected setting is also indicated by the colored LED lights (see Fig. 4) on the handle.

- When the appliance is switched on, the unit starts at the LOW bubble intensity level. The LED indicator lights up green.
- Press the intensity button once to change the intensity to HIGH. The LED indicator lights up red.

- Press the intensity button a second time to enter PROGRAM mode. In this mode, the intensity automatically alternates between Low and High. The LED indicator lights up orange.
- Press the intensity button a third time to return to Low intensity.

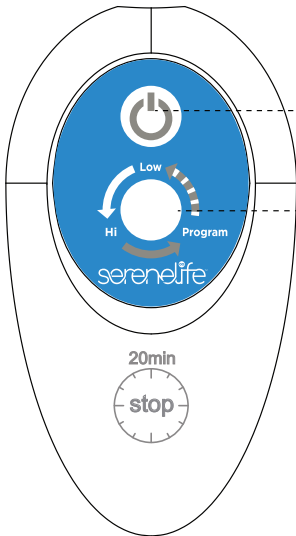

ON/OFF Button:

Turns the unit on or off.

Intensity Button:

Cycles between Low, High, and Program modes.

Press this button:

1st time: Changes to HIGH.

2nd time: Changes to PROGRAM mode.

3rd time: Returns to LOW.

4th time: Changes to HIGH again, and the cycle continues.

Fig. 5

BATTERY:

To change the battery, simply use a coin to open the cover of the battery compartment on the back of the remote control. Once the battery is inserted, use the coin again to close the battery compartment.

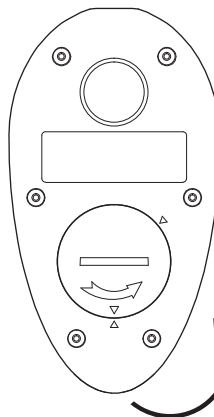

**Battery Operated
3V CR 2032**

⚠WARNING

- **INGESTION HAZARD:** This product contains a button cell or coin battery.
- **DEATH** or serious injury can occur if ingested.
- A swallowed button cell or coin battery can cause **Internal Chemical Burns** in as little as **2 hours**.
- **KEEP** new and used batteries **OUT OF REACH of CHILDREN**
- **Seek immediate medical attention** if a battery is suspected to be swallowed or inserted inside any part of the body.



CAUTIONS:

- Remove and immediately recycle or dispose of used batteries according to local regulations and keep them away from children.
- Do NOT dispose of batteries in household trash or incinerate.
- Even used batteries may cause severe injury or death.
Call a local poison control center for treatment information.
- The battery CR2032 attached to this product is not to be recharged.
- Do not force discharge, recharge, disassemble, heat above 212°F, or incinerate. Doing so may result in injury due to venting, leakage, or explosion resulting in chemical burns.
- Ensure the batteries are installed correctly according to polarity (+ and -).

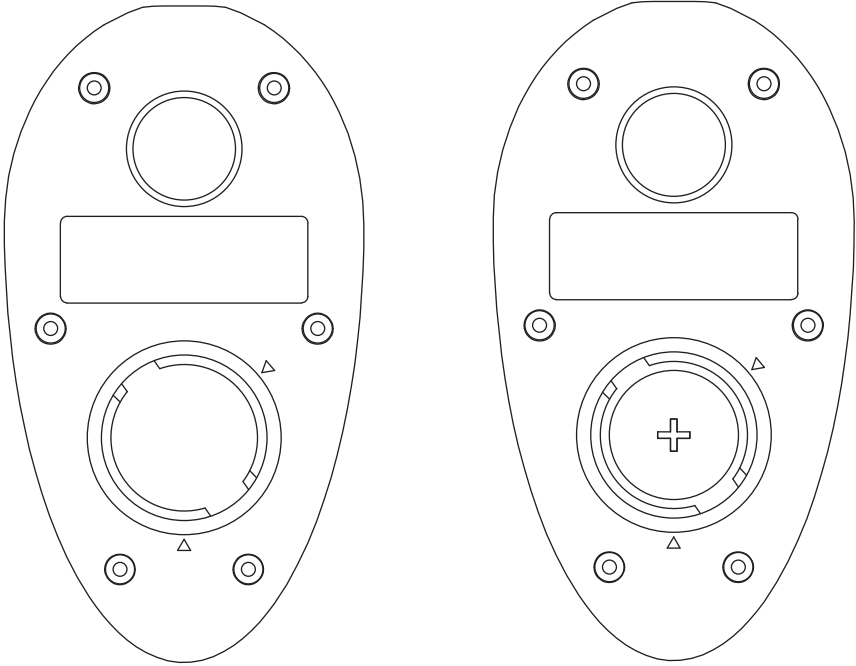

- Remove and immediately recycle or dispose of batteries from equipment not used for an extended period of time according to local regulations.
- Always completely secure the battery compartment. If the battery compartment does not close securely, stop using the product, remove the batteries, and keep them away from children.

DISPOSAL OF BATTERIES

Batteries must not be disposed of in household waste.

As a consumer, you are legally obligated to take all used batteries to public collection points in your area or to locations where batteries are sold.

AIR BUBBLES

Hundreds of pinholes on the bath mat produce millions of air bubbles every minute.

HEATER (FOR PHSPAMT24HT ONLY)

- This appliance is equipped with a built-in heater that operates when the appliance is switched on.
- The heater is not intended to heat up cold bathwater but rather to help maintain water temperature by circulating warm air generated by the main unit.

DOUBLE-SIDED ADHESIVE PLATE:

Ensure the plates are clean and not deformed before use. If a round plate is deformed, submerge it in warm water (at a temperature similar to bath water) for 5 to 10 minutes. Always allow the round plates to dry completely before attaching them to the suction cups.

1. Tear off the protective paper.

The side with the non-woven fabric should be attached to the suction cup.

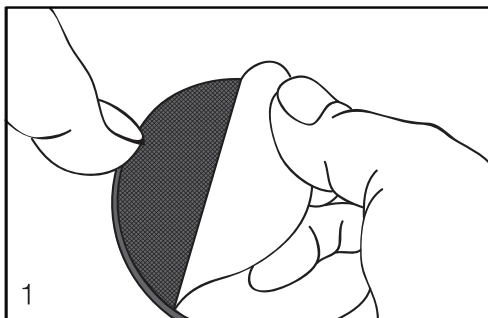

2. It is recommended to attach 4 round plates to the suction cups located in the 4 corners and 1 in the center. Press the round plates firmly to ensure they are securely attached to the suction cups.

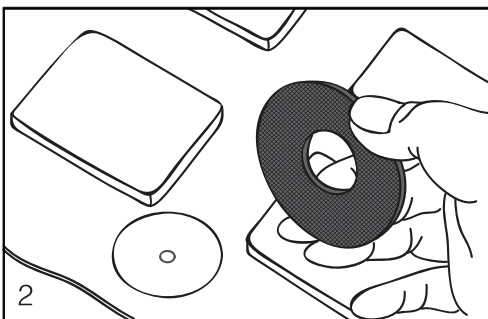

3. Remove the plastic cover on the other side of the round plate. The bath mat is now ready to be used.

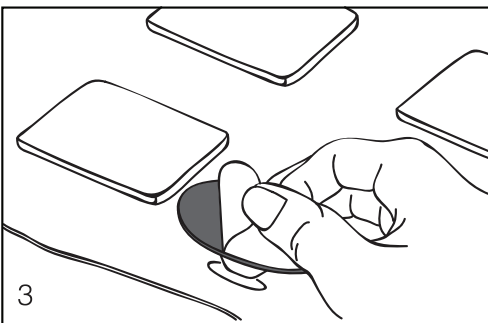

4. Press down each suction cup to secure the mat in place.

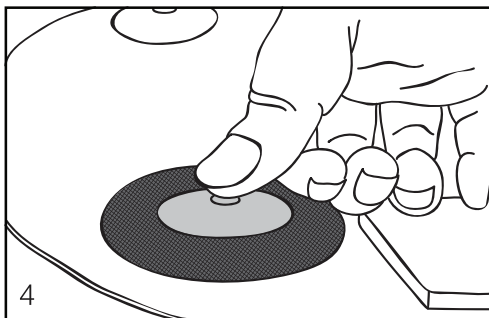

5. To remove the bath mat from the bathtub, slide your fingernail under the suction cups (or round plates) to release the vacuum. Avoid pulling the bath mat directly to prevent damage.

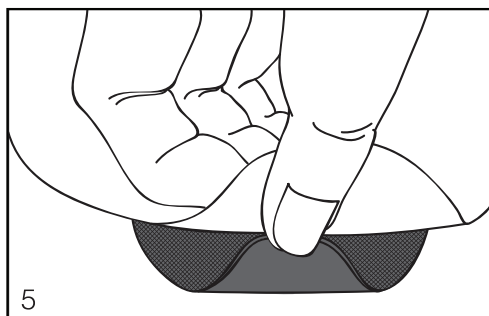

6. Cleaning the round plates is simple; use your fingers and water to clean them.

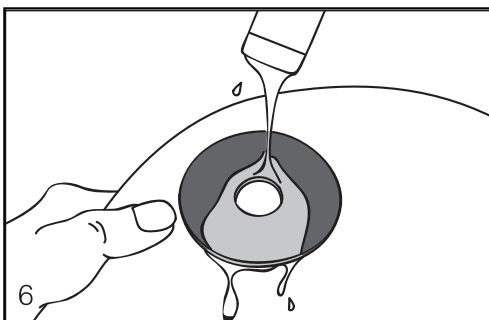

CLEANING, DISINFECTION AND STORAGE

- Always unplug the appliance and allow it to cool before cleaning.
- Disinfect the bath mat periodically to keep it free from bacteria.
Use a mild household cleanser and follow the manufacturer's instructions. Disinfect once a week if used daily, especially if used by multiple people. If used less frequently, disinfect after each use.
- This product is not designed for use with soaps, gels, shampoos, or similar substances. However, if used with these substances, follow these steps to maintain the product: Fill the bath mat with fresh water through the air connection, then empty the water.
Repeat several times to remove any residue.
- To remove the bath mat from the tub, carefully slide a fingernail under the suction cups to release the vacuum, and gently pull the mat sideways. Avoid tearing or pulling it forcefully.
- Turn the bath mat over, lay it flat, and press lightly to squeeze out any remaining water.
- Store the appliance in a dry and clean place. If not used for an extended period, store it in the original packaging.
- It is recommended to store the appliance at a room temperature of approximately 77°F (25°C) and to avoid exposure to sunlight.

CAUTION: READ SAFETY RULES AND OPERATING INSTRUCTIONS CAREFULLY. THIS PRODUCT IS INTENDED FOR INDOOR USE ONLY.

TWO-WIRE POLARIZED ATTACHMENT PLUG INSTRUCTIONS

This appliance has a polarized plug (one blade is wider than the other). As a safety feature, this plug will fit into a polarized outlet only one way. If the plug does not fit fully into the outlet, reverse the plug. If it still does not fit, contact a qualified electrician. Do not attempt to bypass this safety feature.

ALCI SAFETY DEVICE

This appliance is equipped with an appliance leakage circuit interrupter (ALCI) safety device, designed to make the unit inoperable under abnormal conditions. The ALCI safety device has a test button to check its operation.

ALCI TESTING

It is recommended to test the ALCI before each use of the appliance.

After plugging it in:

- Press the reset button on the ALCI device.
- Press the test button. The reset button should pop out, and the appliance will stop operating. This verifies that the safety device is functioning properly.
- Press the reset button again to reactivate your ALCI safety device.
- The bubble bath mat is now ready for use.

Note: If the reset button pops out during use, press the reset button. If the reset button cannot be pressed down, stop using the appliance and return it to the distributor or the designated service center.

Technical Data (For PHSPAMT22/AZPHSPAMT22)

Voltage: 120V~60Hz

Watts: 350W

Remote Control: 3V CR2032 Lithium Battery

Technical Data (For PHSPAMT24HT)

Voltage: 120V~60Hz

Watts: 470W

Remote Control: 3V CR2032 Lithium Battery



California Prop 65 Warning

WARNING:

This product may expose you to chemicals, which is known to the state of California to cause cancer, birth defects and other reproductive harm. Do not ingest.

For more info go to: www.P65warnings.ca.gov

FCC DISCLAIMER

This device complies with Part 15 of the FCC Rules and Industry Canada's license-exempt RSS(s). Operation is subject to the following two conditions:

1. This device may not cause harmful interference.
2. This device must accept any interference received, including interference that may cause undesired operation.

NOTE:

Changes or modifications not expressly approved by the party responsible for compliance could void the user's authority to operate the equipment.

This equipment has been tested and found to comply with the limits for a Class B digital device, pursuant to Part 15 of the FCC Rules and CAN ICES-3 (B)/NMB-3(B). These limits are designed to provide reasonable protection against harmful interference in a residential installation. This equipment generates, uses, and can radiate radio frequency energy and, if not installed and used in accordance with the instructions, may cause harmful interference to radio communications. However, there is no guarantee that interference will not occur in a particular installation.

If this equipment does cause harmful interference to radio or television reception, which can be determined by turning the equipment off and on, the user is encouraged to try to correct the interference by one or more of the following measures:

- Reorient or relocate the receiving antenna.
- Increase the separation between the equipment and receiver.
- Connect the equipment into an outlet on a circuit different from that to which the receiver is connected.
- Consult the dealer or an experienced radio/TV technician for help.

Register Product

Thank you for choosing SereneLife. By registering your product, you ensure that you receive the full benefits of our exclusive warranty and personalized customer support.

Complete the form to access expert support and to keep your SereneLife purchase in perfect condition.

Start Here



Model Number:
PHSPAMT22

[SereneLifeHome.com/pages/register](https://www.SereneLifeHome.com/pages/register)

serenelife™



Questions or Comments?

We are here to help!

Phone: 1.718.535.1800

Serenelifehome.com/ContactUs