

PYLE
PyleUSA.com

PYLE
PyleUSA.com



VISIT US ONLINE:
Have a question?
Need service or repair?
Want to leave a comment?
PyleUSA.com/ContactUs

PYLE



PLRD146

Roof Mount LCD Monitor

13.3" Roof Mount TFT LCD Monitor
Built In Multimedia Disc/USB/SD Player
with Wireless FM/IR Transmitter

USER MANUAL

Contents

Caution	1
Check Point	2
 Name and Function of Each Part	
Unit	3
Remote Control	4
 Picture Control	
Playing a Disc	6
Basic Operation	6
DVD System	7-8
Installation	9
Connection Diagram	9
Disc Information	10
Cautions of Use	11
Troubleshooting	12
Specifications	13

Caution

Please read and observe all warnings and instructions in this owner's manual and those marked on the unit. Retain this booklet for future reference.

The Two kinds of alarm symbols are as follows:



WARNING

The lightning flash with arrowhead symbol within an equilateral triangle is intended to alert the user to the presence of "**dangerous voltage**" within the product's enclosure that may be of sufficient magnitude to constitute a risk of electric shock to persons.



CAUTION

The exclamation point within an equilateral triangle is intended to alert the user to the presence of important operating and maintenance (servicing) instructions in the literature accompanying the product.

WARNING

The driver should never operate these products while the vehicle is in motion! Installation of all TV monitors must be out of the driver's field of vision! Do not try and service these products yourself, seek only a qualified service center or factory service center.

Be careful not to drop or apply undue pressure to the front panel of your video monitor. If the screen cracks due to misuse your warranty will be void!

Make sure to keep products away from heater ducts or vents and out of direct sunlight. Do not mount forward of the driver's shoulders.

Be careful not to overload your cigarette lighter plug by adding more than one device at a time.

Be careful with any liquids in your car. If you or your child spills any liquid on these products, park your vehicle at the roadside, turn the key off to disconnect the power and then wipe the products with a towel. Do not operate the equipment until all liquids have evaporated or you have had the monitor inspected by a qualified Technician. Severe harm or death can occur!

Just use a wet cloth to clean the screen, only use purified water on the cloth, wring out all excess water before wiping the screen. Do not use any cleaners or chemicals to clean the screen. In most cases a dry cloth will do!

Do not mount the product where it will obstruct the deployment of the airbag or in an area where it would affect the vehicular control. Also be careful to avoid mounting the product where it can become hazardous during sudden stops or in the event of an accident.

Caution

Quality installations are performed by qualified and certified installers.

Watching the monitor for an extended period of time without the engine running may deplete the vehicle's battery charge.

This product is designed for operation with a 12 Volt DC, negative ground vehicle. It is not suitable for operation under other conditions or voltages.

Check Point

1. The operating temperature of this product is limited to $-4^{\circ}\text{F} \sim +176^{\circ}\text{F}$. Your vehicle can reach temperatures up to 22°F in the summertime.
2. If your vehicle is extremely hot or cold you must allow time for your air conditioner or heater to cool or heat the vehicle until operating temperatures have returned to the normal operating ranges.
3. Optimum picture quality will be achieved when viewed from directly in front of the monitor (± 30 degrees).
4. Do not open the housing and attempt to make any repair yourself. Refer servicing to qualified personnel.
5. DVD Players use an invisible laser beam which can cause hazardous radiation exposure. Be sure to operate the unit correctly as instructed.
6. Do not cut the car power supply off while a disc is playing. It can cause damage to the DVD Player.

TYPE	Content	Size
DVD	Video & Audio (dynamic image)	12cm/8cm
VCD	Video & Audio (dynamic image)	12cm/8cm
CD	AUDIO	12cm/8cm
MP3	AUDIO	12cm/8cm
MP4	Video & Audio (dynamic image)	12cm/8cm

Disc-related terms

- Title (DVD Only)
- The main film content or accompanying feature content or additional feature content, or music album. Each title is assigned a title reference number enabling you to locate it easily.
- Chapter (DVD Only)

Name and Function of Each Part

Sections of a picture or a musical piece that are smaller than titles.

A title is composed of one or several chapters. Each chapter has an assigned chapter number, enabling you to locate the chapter you want. Depending on the disc, no chapters may be recorded.

Track (Video CD and audio CD only)

Sections of a picture or a musical piece on a video CD or an audio CD.

Each track has an assigned track number, enabling you to locate the track you want.

Diagram of DVD disc

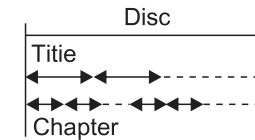
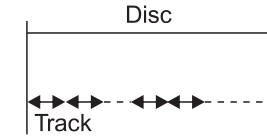

Diagram of VCD/CD



UNIT

1. This little key is for the unit Screen Savers
2. **Vol-/Rewind Forward Skip:** Press and hold to reduce volume, short press to enter rewind forward
3. **Vol+/Fast Forward Skip:** Press and hold to increase volume, short press to enter fast forward.
4. This key controls Dome Light Key 7. If pressing this key after pressing Key 7, and Key 7 doesn't work, press this key again, then Key 7 works.
5. **Menu Key** (Press this key to enter **MENU** setup, hold it for one second to select)
6. **Power ON/OFF:** Press and hold or short press to turn **ON/OFF** the unit
7. **Dome Light Key**
8. **Pause/Open:** Press and hold for Disc **IN/OUT**. Short press for pause display.
9. **SD/USB/DVD/AV Switch Key:** Press and hold to select DVD/SD/SUB; Short press to switch DVD/AV1/AV2 mode
10. Dome light and IR Receive for remote control
11. **DVD Loader**
12. **USB**
13. **HDMI**
14. **SD**
15. **AV**



Name and Function of Each Part

Remote Control Unit

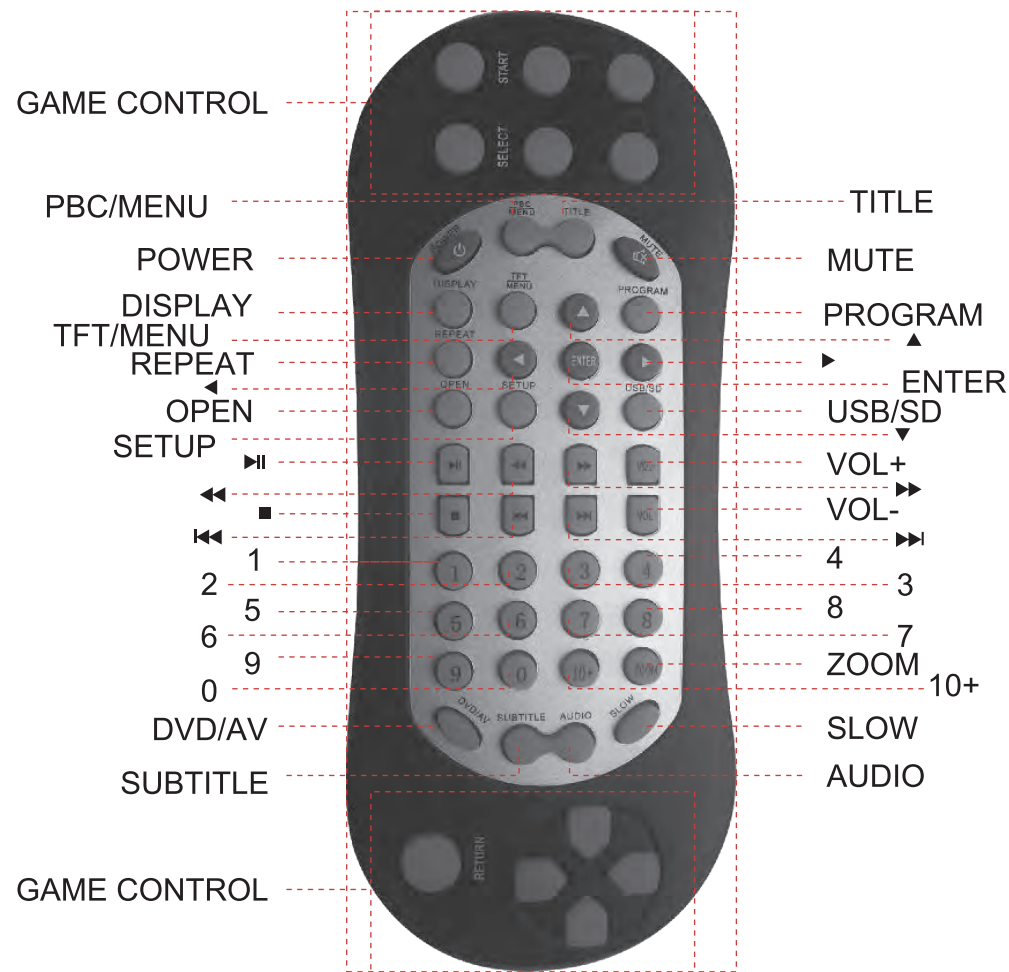

Attention:

1. Direct the control to window of infrared receiver of the machine.
2. Do not press, drop and disassemble the remote control.
3. Continually press the keys on control with least two-seconds pause.
4. Please put out the battery when not using the control for a long time.

Method of Operating DVD System

Playing a disc (DVD/VCD/CD)

- Turn **ON** the player insert the DVD disc
- Make sure that the disc's label is facing up
- Sliding into the slot, the disc is automatically played
- To stop press the button **STOP**
- To stop temporarily press the button **PLAY/PAUSE**

Playing a MP3/MP4 file

- Turn on the player insert the **SD/SUB**
- Sliding into the slot, the **SD/USB** is automatically played
- To stop press the button **STOP**
- To stop temporarily press the button **PLAY/PAUSE**
- To resume again press the button **PLAY/PAUSE**
- To replay a song you want

1. Press the button after choosing a song (track) you want by using Arrow button
2. You can replay the song directly by entering the number of the song.

Disc Menu

- You can select the following menu when are recorded in discs.
- To display recorded menu on disc **DVD/VCD 2.0**
- Press the **DVD** Menu key
- The menu recorded in disc appears. (Scene Selection, Special Features, etc)
- Menu appears differently depending on discs.
- **CD, VCD1.1** does not have disc menu function
- Press the arrow keys to remove to item you want, and press the **ENTER** key.

MENU FUNCTION

- Press MENU key on the unit panel or press TFT/MENU key on remote control
- **To enter into main menu:**
PICTURE - VOLUME - OPTION - SYSTEM - CLOCK
Press ▲/▼ to select submenu and take the corresponding setup.

Picture Control

AV Picture Selections:

Use the unit (remote control) to achieve the desired settings.

1. Press the **MENU** (remote **TFT MENU**) button on the unit to bring up the on-screen picture control menu.
2. Select the desired menu by pressing **MENU** button on the unit to choose main: **PICTURE, VOLUME, OPTION, SYSTEM** or **CLOCK**. Press the **▲/▼** (remote **▲/▼**) button to enter main menu.
3. Press the **◀/▶** (remote **◀/▶**) button to adjust the sub-menu setting. In the menu controlled process, press the **MENU** button to return to the upper level of menus.



Playing a Disc

Playing DVD player

Turn **ON** the power, and place the disc in.

1. Press the power button to turn ON (Power indicator is OFF). display is ON and the player will start loading the disc.
2. Press the Open button to eject the disc tray out, then insert the disc, press the open button again to close. The player will recognize the different formats of the discs, and disc mark will be displayed on the top left side of the screen.
3. While playing DVD discs, please select one item in DVD menu or title menu. while playing VCD2.0 or CD, this player plays one by one.
4. Press the Direction Buttons or the Number Buttons to select the desired item, then press Enter or Play to start.
5. The player will play automatically. Press Pause to stop temporarily, press pause again Pause or Play to cancel pause. While playing a DVD disc, press stop for memory stop, press Play for memory play, press Stop twice to stop playing .

Note: To stop playing DVD press Stop twice.

Basic Operation

FM channel: This unit has multiple frequencies

Unit Control

Press the menu button on the unit, press the AV/DVD button, then press +/- to select the SOUND CONTROL item. Press AV/DVD button, select the press +/- to display the FM menu, press unit AV/DVD button, then press +/- to select the FM channel. In the menu controlled process, press the MENU button to return to the upper level of menus.

Remote Control

press the menu button on the remote control, press the **▲/▼** button, then press **◀/▶** to select the SOUND CONTROL item. Press the **▲/▼** button, then press **◀/▶** to display the FM menu, press **▲/▼** button, then press **◀/▶** to select the FM channel. In the menu controlled process, press the TFT MENU button to return to the upper level of menus.

Video System Interface

Use the included remote control or buttons on the monitor panel to control your media.

Hold in the MENU button to access settings, hold the MENU button to exit the settings screen interface.

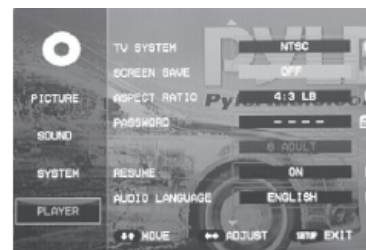

Main Menu Option Settings:

- PICTURE
- SOUND
- SYSTEM
- PLAYER

Settings and Configuration - System Setup

Use the included remote control or buttons on the monitor panel to control system setup configuration.

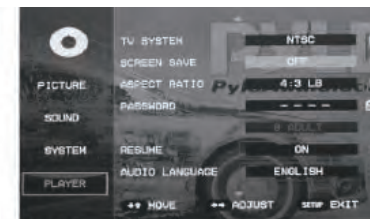

Picture

Mode standard, vivid, soft, optimal, user (custom)

Rotate state 1, state 2, state 3, state 4

Sound

Sound Mode standard, music, speech, movie

Down Mix LT/RT, stereo, VSS

OP Mode Line out, RF remod

Dynamic Range OFF, 1/8 - 7/8, full

FM RF Frequency selection

IR RF A, B, OFF

Volume 0 - 15 (Max)

Settings and Configuration

SYSTEM

Language	English, French, Chinese, Italian, Spanish, Portuguese, Deutsch
OSD Duration	Never, 5, 10, 30 & 60 seconds
Video Output	AV, OFF
Reset	Rest System & Settings

PLAYER

TV System	PAL, NTSC, AUTO
Screen Save	ON / OFF
Aspect Ratio	4:3LB, 4:3PS, 16:9
Password	(Default 0000)
Resume	ON/OFF
Audio Language	Selectable
Subtitle Language	Selectable
Menu Language	Selectable

***Please note:** state1, state2, state3 and state4 allow the monitor's display screen to rotate and flip. To accommodate for rear view and backup camera system compatibility, the settings menu also rotates and flips -- this may result in difficulty of reading the menu settings text. To assist in reading the menu settings text, revert the **ROTATE** setting selection back to 'state3' and resume configuring your settings.

*Change the **TV System** settings to adjust the DVD output format of your media disc.

Power ON/OFF

Press and hold the **Power** button to turn **ON/OFF** the unit

Monitor Source Selection

Press the Power button to switch between the (4) source input selection modes.

- Disc, AV1, AV2, HDMI

CD/DVD System Operation

Insert a CD/DVD -- with the label facing the back of the PLRD146. The contents will automatically play upon insertion.

MP3 Playback

Insert a USB Flash or SD Memory Card and your media will automatically play.

Installation (Professional Installation Recommended)

Product Installation & Housing Changing Operation

1. Turn over the machine, and take down the metal support bracket carefully.
2. Tighten the metal support bracket to the ceiling of vehicle as showed in the second picture, and leave a certain space to let the connecting wire pass through. (Take extra care to avoid damage)
3. To install the unit to the metal support bracket, connecting with the unit and the wires passing through the space remained. (Take care to tidy up the wires to avoid pressing Multimedia chipset. And install special screws to avoid loose.)

NOTICE: If you need to change the housing, please do it before installing the machine in the car.

Chip installed inside products is composed by mechanism and electronic sub-assembly, be careful when installing and pay attention to be pressured.

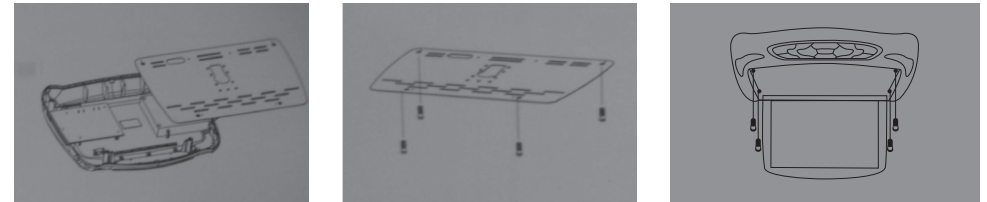

4. Installing and changing Interchangeable skin

You can change different colors of the interchangeable housings easily by opening the original housings with a small release key provided in the package.

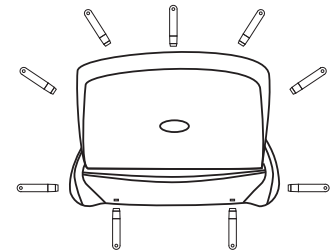

Connection Diagram

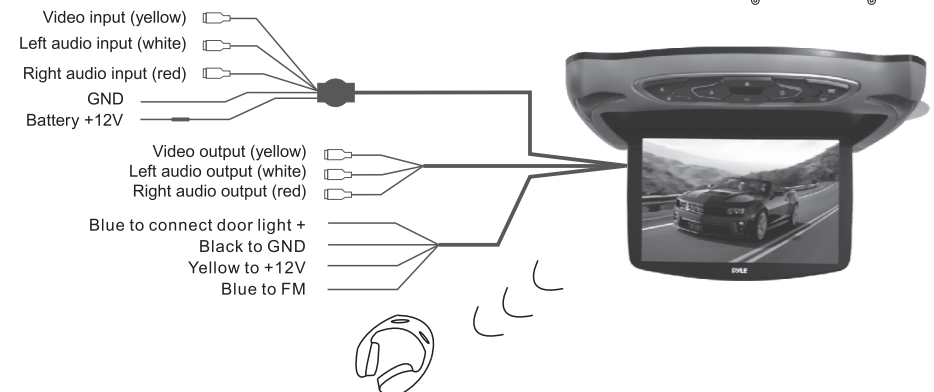

Without audio & video input or audio & video output, the wire of input & output does not need to be connected.

DISC INFORMATION

DVD features

DVD discs provide high-resolution images with high-quality sound and surround sound effects. This DVD player can play not only DVD discs of various versions, but also S-VCD, VCD, audio CD and MP3 discs. Each disc only plays the information saved in it, and some functions cannot be utilized.

Discs that cannot be played

DVD-RW, DVD-REM, CD-ROM, CD-EXTRA discs cannot be played on this unit. Also, a CD or a CD-RW which was recorded on special software cannot be played.

Region code

Your DVD player is designed and manufactured to region management information that is recorded on a DVD disc.

The region number of this DVD Player is 1. This DVD player plays free code also.

Copyright protection.

This product incorporates copyright protection technology that is protected by methods claims of certain US. patents and other intellectual property rights owned by the Macrovision Corporation and other rights. Owner's use of this copyright protection technology must be authorized by the Macrovision Corporation, and is intended for home and other limited viewing uses only unless otherwise authorized by the Macrovision Corporation.

How to handle the disc

Don't touch the shiny side of the disc (the side with the embedded information). Don't stick a label or a glue-based note on either side of the disc. Don't use discs that have glue or a damaged gluey label- it might result in damage to your DVD player. Don't put discs in the sunshine. Park your car in the shade.

Caution

Wipe softly with a wet cloth and then with a dry one.

Before playback, wipe the disc outward from the center with a clean cloth.

Do not use any type of solvent such as thinner, benzene, commercially - available cleaners or antistatic spray. To avoid damaging your DVD player, don't use a scratched disc.

CAUTIONS ON USE

Handling

When holding with both hands



- Do not use damaged (cracked or warped) discs.
- Do not scratch the signal surface or let it become dirty.
- Do not stick a label or a glue-based note on either side of the disc.
- Do not use discs that have glue or a damaged label with exposed adhesive residue, it might result in damage to your DVD player.
- Do not put discs in the sunshine. Park your car in the shade.

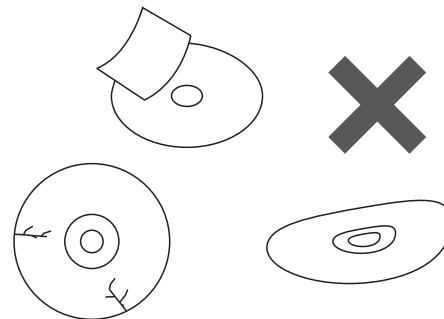

Storing discs

Always put discs in their place and store them vertically. Do not put discs in a hot or humid place, places exposed to direct sunlight and places in which the temperature is extremely low or high.

- Read any cautions included with the disc carefully.

Cleaning discs

Fingerprints or dust on discs may reduce sound or picture quality. Remove them by wiping the disc with a soft cloth from the center toward the edges gently.

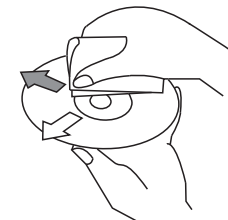

- For tough dirt, wipe softly with a wet cloth and then with a dry one.
- Do not use any type of solvent such as thinner, benzene.
- Do not use antistatic spray.

Irregularly shaped disc

Irregularly shaped discs (heart-shaped discs, hexagonal discs, etc.) cannot be played on this player.

- May cause damage to the player.
- Only use round discs.

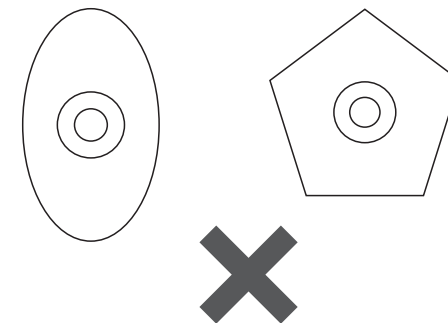

Troubleshooting

TROUBLE	ACTION
No power	Check and see if the power cable is properly connected.
No picture	Make sure that the equipment is properly connected. Check and see if the connected monitor is turned on
Stopped picture	Check and see if the video cable is properly connected and if the monitor is turned on.
Poor playback picture	Clean the disc
No color	The color system of this unit does not match the color system of the monitor. Check the color system of the unit.
Distorted sound	Adjust the video system by pressing the TV system button. (PAL, NTSC)
The remote control doesn't work properly	Remove any obstacles between the remote control unit and the remote control sensor. Operate the remote control at a shorter distance.
DISC ERROR is displayed on the screen	Set the power button to OFF and then back to ON alternatively. Turn OFF the power, disconnect the power plug and then reconnect it.

CHECK POINT

When a disc is brought from a cold environment to a warm one, there may be moisture on the disc, or condensation will appear on the pickup lens. It will affect the disc playback.

1. Remove the disc from the Multimedia player.
2. Turn **ON** the power and leave it ON for an hour to vaporize the condensation.
3. You can now operate the Multimedia player without any problem.

PLRD146

Roof Mount LCD Monitor

13.3" Roof Mount TFT LCD Monitor Built In Multimedia Disc/USB/SD Player with Wireless FM/IR Transmitter & Included 3 Color Skins (Gry/Blk/Tan)

Features:

- 13.3" Wide Screen Hi Resolution TFT-LCD Monitor
- Overhead Console with Dual LED Dome Lights
- On Screen Menu Control
- Full Function wireless remote control
- IR Transmitter Ready for Wireless Headphone
- Overhead Console with Dual LED Dome Lights
- TouchButton Dual Function Front Mounted Controls
- Side Mount Slot-Load DVD Player
- DVD CD/CD/CD-R/CDRW/MP3 Compatible
- Built in Speaker's and audible button indicators
- Built in Anti-Skip Mechanism & Last position memory
- Wireless FM Transmitter to broadcast to a existing FM stereo (Portable/Car/Etc.)
- 3 sets of interchangeable 2pc snap-on color skins.
Choose from Grey, Black, or Tan

Whats' in the Box:

- LCD Monitor
- One wireless remote control
- User of manual
- One small release key
- 2 sets of interchangeable housings
- Fix Screws x 4 pcs

Technical Specifications:

- Resolution: 1280 x 800
- Brightness: 450 Cd/Sq.M
- Contrast Ratio: 500:1
- Power Source: DC 12 Volt
- Multi System: NTSC/PAL Auto Switch
- Dimensions (LxWxH): 16.2" x 13.0" x 2.15" Closed (9.75" Open)