

PYLE[®]
PyleUSA.com



Questions or Comments?
We are here to help!
Phone: 1.718.535.1800
PyleUSA.com/ContactUs



PYLE[®]
PyleUSA.com



PMX3500PH
Wireless BT Home/PA Mixing Amplifier

USER GUIDE

Features:

- Bluetooth Wireless Streaming Ability
- Built-in USB Playback
- LED Display
- USB Flash Drive
- Aux Input
- MP3/MIC/AC-3 Inputs
- Digital LED Display
- Microphone 1 and 2 Level Gain and Talk-over Control
- Microphone 1 Priority function
- Mic Talk-over Ability to Speak Over Audio, Karaoke Style
- Desktop Home/PA Mixing Power Amplifier
- Compact Home Theater-Stereo Receiver Style
- Built-in Bluetooth for Wireless Music Streaming
- Optical/Coaxial Digital Signal Inputs
- Aux Audio Input Selection
- MP3/WAV Audio Files Support
- Connect & Stream Audio from External Devices
- Front Panel Audio Control Center
- Treble, Bass, Master & Microphone Volume Adjustable

Bluetooth Connectivity:

- Receives Wireless Signal for Audio Streaming
- Simple & Hassle-Free Pairing Setup
- Integrated Antenna for Extended Wireless Range
- Works with All of Today's Latest Devices
(Smartphones, Tablets, Laptops, Computers, etc.)
- Bluetooth Version: 5.0
- Bluetooth Network Name: 'Pyle Speaker'
- Wireless Range: 40'+ Ft.

California Prop 65 Warning

⚠ WARNING:

This product contains Lead (Pb) which is known to the state of California to cause cancer birth defects and other reproductive harm. Do not ingest.

For more info go to: www.P65warnings.ca.gov

What's in the Box:

- Desktop Stereo Amplifier
- Remote Control

Technical Specs:

- Power Output: 500 Watts Peak Power
- Remote Control Battery: Need 2x 'AAA' Battery (not included)
- MAX Power Output: 50 Watt x2(@ 4 Ohm)
- RMS Power Output: 35 Watt x 2 (@ 4 Ohm)
- Tone Control: Bass, f=100Hz +/-12dB, Treble, f=10 KHz +/-12dB
- Tone Control for Mic: Bass, f=100Hz +/-8dB, Treble, f=10 KHz +/-8dB
- Frequency Adjustment: +/-2dB
- Signal to Noise Ratio: >71dB
- T.H.D.: <1%
- Separation Degree: >45dB
- Radio Station Presets: Up to 40 Stations
- Power Supply: 120V/240V, Switchable
- Dimensions (L x W x H): 11.81" x 9.45" x 2.76" -inches

Front Panel

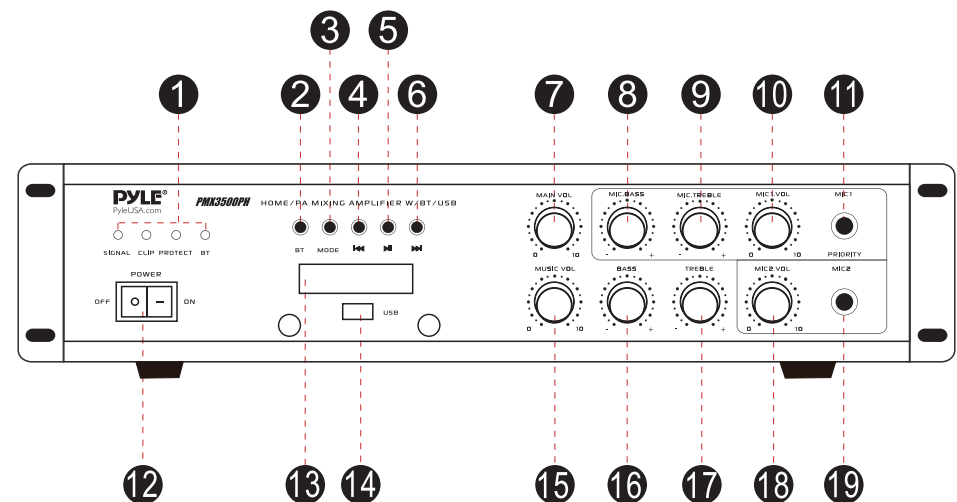

Front and Back Panel

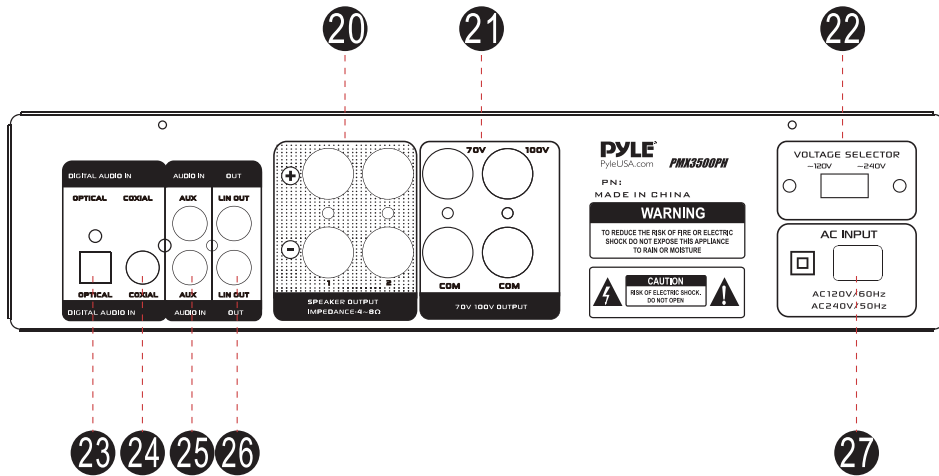

- | | |
|---------------------------------------|--------------------------------|
| 1. Signal/Clip/Protect/BT indicator | 19. Mic 2 Input |
| 2. BT-Press this key to enter BT Mode | 20. Speaker Output |
| 3. Input Selector | 21. 70V/100V Output |
| 4. Previous Song/Previous Station | 22. 120V/240V Voltage Selector |
| 5. Play/Pause | 23. Optical Input |
| 6. Next Song/Next Station | 24. Coaxial Input |
| 7. Main Volume Control | 25. Aux Input |
| 8. Mic Bass Volume Control | 26. Lin Output |
| 9. Mic Treble Volume Control | 27. AC 120V/240V Input |
| 10. Mic1 Volume Control | |
| 11. Mic 1 Input | |
| 12. Power ON/OFF Switch | |
| 13. LED Digital Display | |
| 14. USB Reader | |
| 15. Master Volume Control | |
| 16. Bass Volume Control | |
| 17. Treble Volume Control | |
| 18. Mic1 Volume Control | |

Remote Control Functions

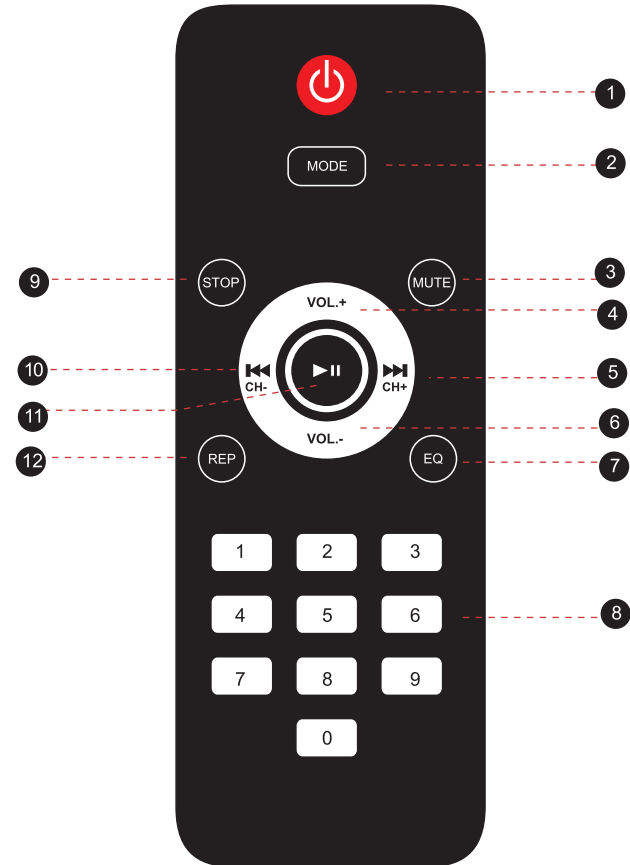

1. USB/SD Standby/ON key
2. USB/SD/DVD mode
3. Mute button
4. **Master Volume + button:** Increases volume level
5. **Next button:** Move forward through tracks from USB input
6. **Master Volume - button:** Decreases volume level.
7. Equalizer button
8. **Numeric key pad:** In USB mode, use to manually select tracks.
9. **Stop button:** Stops music playing from USB input
10. **Previous button:** Move back through tracks from USB input.
11. **Play/Pause button:** Play and pause music from USB input.
12. **Repeat button:** Repeats current track from USB Input

WIRELESS BT STREAMING OPERATION INSTRUCTION:

You can connect external devices with built-in Wireless BT to this amplifier to play music through the amplifier's speakers. If speakers are connected, you will hear tones to assist with the connection.

1. Press the "BT" button on the front panel to select "BT" mode.
2. Turn on the Wireless BT on your external device.
3. Search for available BT devices. Make sure you're within range of the amplifier, then select "**Pyle Speaker**" from the list.
4. Once you hear the tones, the unit is ready to pair.
5. You can now play music from your external device through the amplifier.

Cleaning and Storage

Cleaning

1. **Turn Off and Unplug:** Always turn off and unplug the amplifier before cleaning.
2. **Exterior Cleaning:** Use a soft, dry cloth to wipe the exterior surface of the amplifier. If needed, lightly dampen the cloth with water. Do not use any harsh chemicals or abrasive cleaners.
3. **Avoid Moisture:** Ensure that no moisture enters the amplifier, especially through the control buttons, knobs, or input/output jacks.
4. **Check Vents:** Periodically check the ventilation openings to ensure they are free of dust and debris. Use a dry, soft brush or a can of compressed air to clean them if necessary.

Storage

1. **Cool, Dry Location:** Store the amplifier in a cool, dry place away from direct sunlight, heat sources, or areas with high humidity.
2. **Cover:** If possible, cover the amplifier with a dust cover or cloth to protect it from dust and dirt.
3. **Cable Management:** Neatly wrap and secure all cables to prevent tangling or damage during storage.
4. **Avoid Stacking:** Do not stack heavy items on top of the amplifier to avoid damaging the controls or casing.

FCC INFORMATION

WARNING:

Changes or modifications not expressly approved by the party responsible for compliance could void the user's authority to operate the equipment.

NOTE: This equipment has been tested and found to comply with the limits for a Class B digital device, pursuant to Part 15 of the FCC Rules. These limits are designed to provide reasonable protection against harmful interference in a residential installation. This unit generates, uses, and can radiate radio frequency energy, and if not installed and used in accordance with the instructions, may cause harmful interference to radio communications. However, there is no guarantee that interference will not occur in a particular installation. If this equipment does cause harmful interference to radio or television reception, which can be determined by turning the equipment off and on, the user is encouraged to try and correct the interference by one or more of the following measures:

- Reorient or relocate the receiving antenna.
- Increase the separation between the equipment and receiver.
- Connect the equipment to an outlet on a circuit different from that to which the receiver is connected.
- Consult the dealer or an experienced radio/TV technician for help.

This device complies with Part 15 of the FCC Rules. Operation is subject to the following two conditions:

1. This device may not cause harmful interference.
2. This device must accept any interference received, including interference that may cause undesired operation.

Register Product

Thank you for choosing PyleUSA. By registering your product, you ensure that you receive the full benefits of our exclusive warranty and personalized customer support. Complete the form to access expert support and to keep your PyleUSA purchase in perfect condition.



PyleUSA.com/register