

SereneLife

Questions? Issues?
We are here to help!
Phone: (1) 718-535-1800
Email: support@pyleusa.com

SereneLife



PSLMSGST20 **Hot Stone Massage Kit**

Portable Heated Rock Therapy System with Digital Temperature Controller,
Includes (12) Massaging Stones





User Manual

PLEASE MAKE SURE THAT YOU HAVE READ THE MANUAL CAREFULLY BEFORE USING IT.

THERMAL THERAPY MASSAGE KIT

Thermal therapy is the use of heat in therapy, such as for pain relief and health. It can take the form of a hot stone, hot bamboo sticks, and others. It can be beneficial to those with arthritis and stiff muscles and injuries to the deep tissue of the skin. Hugeworth born out of the desire to make massage therapy mobile. Our innovative electric massage warmer set comes with a light-weight energy efficient stylish storage/travel bag case that doubles as stone heater oven that quickly heats up the rocks, and it is the helpful tool to heat the massage stones or bamboo sticks. As we know the application of warmed Basalt stones/bamboo sticks combined with manual massage to provide the client with a deeply relaxing Therapeutic experience. This treatment which also benefits the therapist not only financially but also physically.

PRODUCT FEATURE

-  **Innovative waterless heating technology**
With waterless heating technology there is no need for traditional stone heating equipment.it can drop the electricity consumption, much "greener" and more environmentally friendly.
-  **Digital temperature controller**
Our digital temperature controller grants therapist the ability to choose the desired stone temperature.
-  **Portable massage kit**
Our portable massage kit offers mess-free stone warming along with the ability to easliy transport for traveling therapist as well as your massage practice or home use.
-  **Multifunctionality**
Combined heating with bag, it is more than a bag, not only can self-contained but also can heat.



110V Socket



Controller



Power cord

Basalt stones (Optional accessory)



4.5x4.5x1.8cm*6PCS



7x7x1.8cm*6PCS

HOW TO USE

STEP 1

Place stones inside the portable massage heating warmer. Make sure all stones are placed flat and not stacked on top of one another.

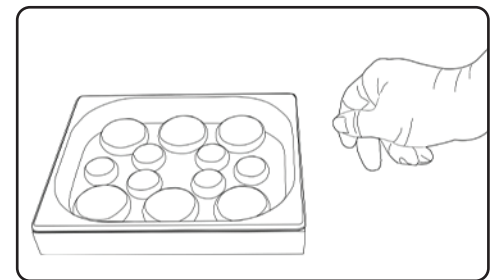

STEP 2

Connect the temperature controller to the portable massage heating warmer.

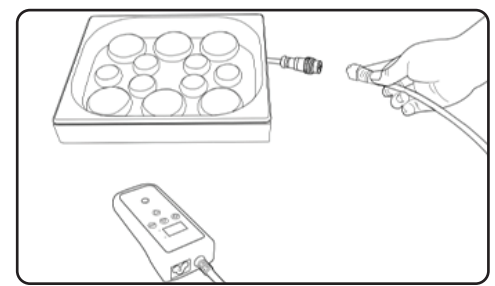

STEP 3

Connect the power cord to the temperature controller and then plug power cord into a power outlet.

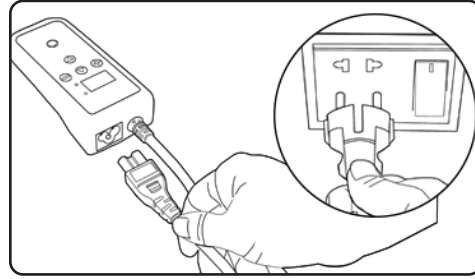

STEP 4

Press the power button on the temperature controller and set desired temperature or heating time.

Wait about 10-15 minutes and the stones will be ready to use.

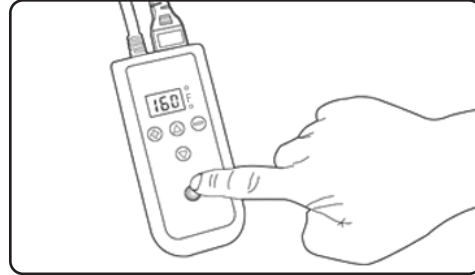

**Heating time depends on the ambient temperature and usage.*

INDICATOR STATEMENT

Status	Mode
OFF	Controller is off
ERO	NTC disconnect
Red light on	Heating
Red light twinkles	Reached the setted temperature
Green light on	Countdown function is working

MAINTENANCE

1. Use a dry towel to wipe the surface of the device.
2. Place the product in the box and keep it dry if long time without using.
In order to improve user experience, there will be changes in product features without prior written notice, please refer to actual contents in the package.

WARRANTY

In order to let you use this product with confidence and better protect your rights and interests. Our company will implement after-sales service on the basis of abiding by the general administration of quality supervision, inspection and quarantine and the ministry of information industry.

The following circumstances not cover by warranty

1. The effective service or free maintenance period has been exceeded.
2. Failure to follow the correct instructions for use, maintenance, and storage leading to malfunction or damage.
3. Consumers disassemble the product themselves.
4. Product defects caused by human factors (such as operation errors, and input of inappropriate voltage and touch the water).

CAUTIONS

1. Risk of electric shock, can cause injury or death if improper operation.
2. Please do not cover by any other things when using, it will cause the fire in extreme cases.
3. Ensure to use in a dry environment. Do not immerse this product in water or other liquids to avoid short circuit or electric shock. Heating system is not waterproof.
4. Do not allow children or incapacitated persons to use this product.
Please keep this product out of the reach of children.
5. The Kit should be keep away from high temperature environment and point-blank sunshine.
6. Donot leave unattended.
7. This product requires professionals use. Please do not separate, maintain, or refit the product if you were not professional.
8. Heating speed may vary from the room temperture, using habits, etc.
Please set the temperature as desired avoid burns caused by excessive heat.
9. If the product has some abnormal conditions, such as bad smell, overheat, abnormal color, distortion, etc. please stop using immediately and contact the local dealer.

Features:

- Innovative Waterless Heating Technology
- Digital Temperature Controller
- Hot Stone Massage System
- Simple Electric Plug-in Design
- Quick Setup: All-in-One Portable Kit
- Smooth & Sculpted Round Basalt Rock Stones
- Uniquely Selected Stone Type for Comfort & Maximum Heat Retention
- Wired Temperature Controller Unit
- Digital LCD Display with Selectable Temperature Setting
- Energy Efficient Warming Bag Quickly Heats Up
- Melt Away Stress to Soothe Muscle Tension, Soreness, Stiffness
- Heated Stone Massage Relieves Pains Caused by Sprains & Strains
- Ideal for Athletes, Home Care, and Therapeutic Spa Centers

What's in the Box:

- Hot Stone Heating Box
- Digital Temp Controller
- (6) Large Massage Stones
- (6) Small Massage Stones
- Power Cable

Technical Specs:

- Construction Materials: Aluminum, Bamboo
- Stone Type: Basalt Rock, Round
- Heating Time: 8-15mins
- Stone Maximum Heat Retention: 25mins
- Adjustable Temperature: 70-160 °Fahrenheit (30-70 °C)
- Large Stone Size: 2.8" x 0.7" -inches (-Each)
- Small Stone Size: 1.8" x 0.7" -inches (-Each)
- Large Stone Weight: 0.39 lbs. (-Each)
- Small Stone Weight: 0.15 lbs. (-Each)
- Power Cord Length: 5.9' ft.
- Power Supply: 155W
- Power Output: 110V, 1.4A
- Total Bag Size (L x W x H): 12.9" x 10.6" x 2.6" -inches

