

serenelife™



PUCWM44

Portable Mini Washing Machine

Bucket Washer for Clothes Laundry Lightweight
and Easy to Bring for Camping, RV, Travel
Small Spaces Folding (Black and White)

USER GUIDE

The **Portable Mini Washing Machine** adopts a soft rubber barrel body, which can be folded easily for storage and carrying.

According to different configuration, the washing machine has Cold wash, Spin Dry wash and Hot wash functions.

Specially designed for items that need to be washed and disinfected.

Table of Contents

Washing Machine parts	3
Method of use (expansion and folding of washing machine)	3
How to use the Portable Mini Washing Machine Bucket	4
Procedures Description	5
Spin Basket Assembly Diagram	6
Notes	7
Cleaning and maintenance	7
Troubleshooting	8
Features and Technical Specs	9

Washing Machine parts

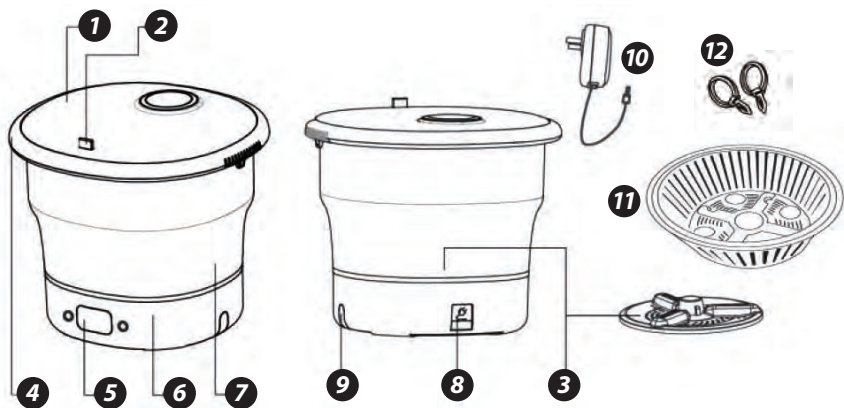

1. Lid
2. Lifting handle
3. Pulsator (internal)
4. Upper frame
5. Panel
6. Base
7. Soft rubber bottom
8. Plug
9. Soft plug at drain outlet
10. Power plug (adaptor)
11. Spin basket
12. Drain Basket latches

Method of use (expansion and folding of washing machine)

1. **Unfolding:** Take out the folding washing machine, use one hand to press the bottom of the barrel, use the other hand to lift upper frame from one side to the other side.
2. **Folding:** Hold the upper frame with both hands, then press it down evenly.

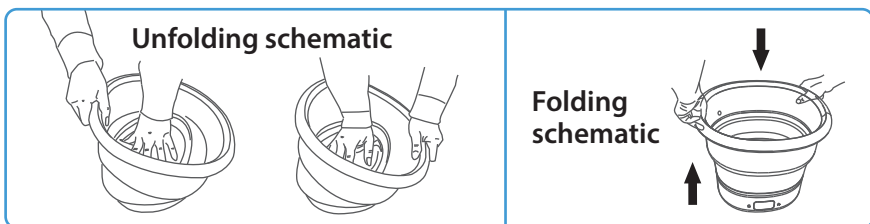

How to use the Portable Mini Washing Machine Bucket

1. Pull up the folding washing machine, push up the baffle at the power cord socket, and insert the power cord plug.

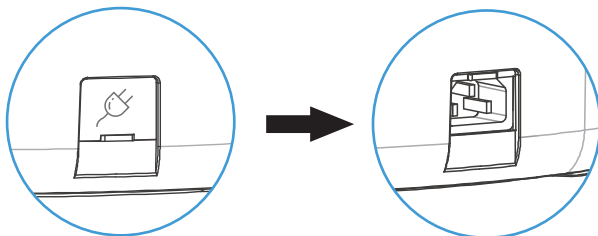

2. Insert the drainage outlet with cork.
3. Put in the clothes, add water over the soft rubber bucket (*do not exceed the highest water level*), put in the cleaning agent.
4. **Close the lid before running the washer**, otherwise water will overflow as it rotates.

Power ON/OFF and Washing Operation Method

1. **Touch button and display of the machine:** *The panel of the machine you purchased may be inconsistent with the following figure. Please refer to the machine you purchased.*



2. **Power ON:** The Washing Machine will ring when the power is ON; Press and hold "Start/Pause" for 2 seconds to boot. Short press the same button to start or pause.
Power OFF: Press and hold "Start/Pause" for 2 seconds.

3. The machine has a variety of cleaning procedures (Please refer to the machine you purchased). Available cleaning time are 5 min, 10 min, 15 min.
4. After boot, the default is "**Cold Wash**" procedure with washing time of 5 minutes. Press "**Time Process**" to select the washing program, and press and hold "**Time Process**" to select the washing time. After running, the device will be in standby state, and automatic shutdown after 2 minutes.

Procedures Description

Cold Wash

Ultrasonic vibration is added in the washing process to accelerate the collapse of dirt. Automatic release of ozone water without residue.

Spin Dry

Drain out water in wash tub after washing. Attach the spin basket. Transfer the wash load, ensure that the clothes are evenly distributed. Choose the "**Spin Dry**" function.

Hot Wash

The "**Hot Wash**" indicator light will blink when the device starts heating. It will start washing when the water temperature reached 49°C (120.2°F). The "**Hot Wash**" indicator light will stay lit and the time indicator light flashes. Ultrasonic vibration is added in the washing process to accelerate the disintegration of dirt.

Spin Basket Assembly Diagram

1. Gently fold the **spin basket** outward with water into a semi-circle shape, and the outward arc of the convex buckle is roughly close to the drain basket.

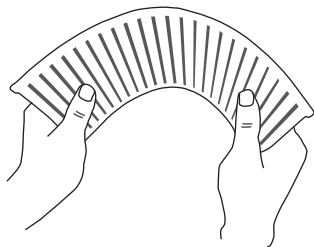

2. Insert the **spin basket** folded into a semi-circle into the slot on the bottom of the **spin basket**.

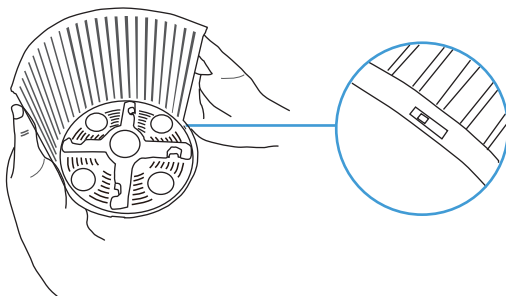

3. Insert another **spin basket** into the slot on the bottom of the drain basket in the same way.

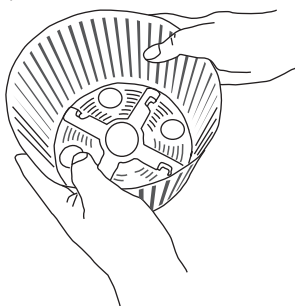

4. Align the notches of the six card slots on the **spin basket** with the protruding tabs on the **spin basket** sheet, and press down gently to make the protruding tabs on the **spin basket** snap into the overflow blue ring slot.

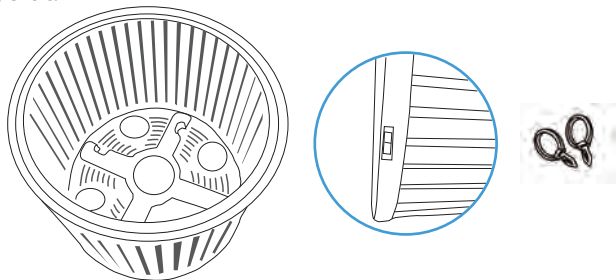

Notes

1. Close the lid before the washing machine starts to run, otherwise the water may overflow.
2. When the washing machine starts to run, do not force stop the rotation of the pulsator, this may cause damage to the machine.
3. The Portable Mini Washing Machine is designed for small items, do not wash overload.
4. When spin, insert 1pc or 2pc latches into the hole in the spin basket.

Cleaning and maintenance

1. **DO NOT** use water to wash the case of the washing machine, especially the base. Otherwise it will damage the washing machine. After using, wipe off the water and dry completely before folding for storage. You can use wet wipes to wipe the case or the rubber part. **DO NOT** use organic solvents to wipe.
2. Sharp objects should not be in direct contact with the rubber barrel, so as not to damage it.
3. Power sockets used should be reliably grounded.
4. If the power cord is damaged, it must be replaced with a dedicated cord or a dedicated component purchased from its manufacturer or maintenance department.

Troubleshooting

Trouble	Possible Reason	Solutions
Your machine does not spin.	Heavy wash loads Water supply is not adequate	Redistribute wash load Fill water to MAX level
The Pulsator suspend spinning together with gas emitting	The ozone generator is working to produce Ozone gas	This is usually normal. Cover the cap to obtain best sterilization effect
Vibrating noise	Ultrasonic vibrator is working	This is usually normal.
The Washing machine does not start	Electrical power cord may not be plugged in or connection may be loose. Incorrect boot operation	Replace a new electrical power cord (adapter). Press and hold power button for 2 seconds to boot
Heat problem (Heating Verstion)	Protection for lackness of water	Fill the machine with water and reboot the function.
Automatic shutdown	Automatic shutdown	The machine will automatically shut down to save power after 10 minutes of suspension or two minutes after completion of the program.

Features:

- With Handle, Hot Wash and Basket
- With Semi-Automatic Cleaning Functions
- Comes with a Hand Carry and a Lid Cover
- High-Frequency Vibration to Effectively Remove Dirt
- Energy-Saving and Environmental Protection
- Foldable and Portable Bucket Type
- Convenient to Use and Store
- Saving Water and Electricity
- Perfect for Use in Camping, Apartments, Dorms, and Business Trip
- Small and Convenient Washing Machine
- Comes with a Power Cord and Automatic Button
- Perfect for Small Clothes, Underwear, Towels, Socks, and Other Small Items
- One Touch Control Button
- Made out of Premium Safe and Non-Toxic Material
- Made out of a Unique Combination of Edible Grade TPE and BPA-Free Plastic

What's in the Box:

- Washing Machine

Technical Specs:

- Construction Material: TPE, ABS
- Wash Capacity: 2.2 Lbs.
- Spin Capacity: 1.1 Lbs
- Rated Wash Power: 35W
- Frequency Response: 60Hz
- Voltage: 120V
- Waterproof: IPX4
- S/N Ratio: 60dB
- Timer: 0~15 mins
- Motor: Copper Motor
- Motor Speed: 2200 Revolutions/Min
- Unfolded Dimension: 12.59" x 15.15" x 10.98"-inches
- Folded Dimension: 12.59" x 15.15" x 5.5"-inches



serenelife™
www.SereneLifeHome.com

Questions? Comments?

We are here to help!

Phone: (1) 718-535-1800

Email: support@pyleusa.com

