



Questions or Comments?
We are here to help!
Phone: 1.718.535.1800
PyleUSA.com/ContactUs



Visit Our Website
SCAN ME
PyleUSA.com



PUNP34BT

**Retro Classic-Style Bluetooth Radio
Speaker Sound System**

USER GUIDE

READ ALL INSTRUCTIONS CAREFULLY BEFORE USING THIS PRODUCT.

RETAIN THIS OWNER'S MANUAL FOR FUTURE REFERENCE.

Features:

- Classic Style Radio with Modern Technology
- Built-in Bluetooth for Wireless Music Streaming
- Elegant Vintage Replica Crafted Sound System
- AM/FM Radio with Retro Styled Dial
- Aux (3.5mm) Input Connector Jack
- Connect External Devices (Smartphone, Tablet, MP3 Players)
- USB Flash Drive & SD Memory Card Readers
- USB Port Double Function for Device Charging
- Plays Your Favorite MP3 Digital Audio Files
- Simple Rotary Knobs and Button Control Center
- RCA (L/R) Output Connector Jacks
- Ability to Connect to External Speaker Systems
- Full Range Sound Reproduction
- Dual Built-in Stereo Speakers

Bluetooth Wireless Streaming:

- Works with All of Your Favorite Devices
(iPhone, Android, Smartphone, iPad, Tablet, etc.)
- Stream your Audio through the Turntable's Speaker System
- Bluetooth Network Name: 'Pyle Turntable'
- Bluetooth Version: 5.3
- Bluetooth Wireless Range: 30'+ Feet

⚠ WARNING: Cancer and Reproductive Harm - www.P65warnings.ca.gov

Technical Specs:

- Digital Audio File Compatibility: MP3 / WMA
- Maximum USB Flash/SD Card Support: 32GB
- Construction Material: Wood, MDF Fibreboard
- Power: 110V, AC
- Dimensions (L x W x H): 7.1" x 11.8" x 7.1" -inches

SAFETY INSTRUCTIONS

WARNING: TO PREVENT FIRE OR SHOCK HAZARD, DO NOT EXPOSE THIS APPLIANCE TO RAIN OR MOISTURE.

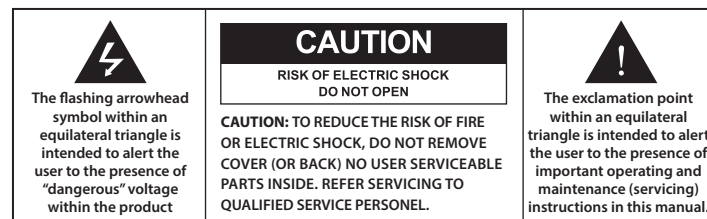

IMPORTANT SAFETY INSTRUCTIONS

1. **Read instructions** - All the safety and operating instructions should be read before the appliance is operated and should be saved for future reference.
2. **Retain instructions** - The safety and operating instructions should be retained for future reference.
3. **Heed warnings** - All warnings on the appliance and in the operating instructions should be adhered to.
4. **Follow instructions** - All operation and use instructions should be followed.
5. **Water and Moisture** - The appliance should not be used near water; for example, near a bathtub, washbowl, kitchen sink, laundry tub, in a wet basement, or near a swimming pool, and the like.
6. **Carts and Stands** - The appliance should be used only with a cart or stand that is recommended by the manufacturer. An appliance and cart combination should be moved with care. Quick stops, excessive force, and uneven surfaces may cause the appliance and cart combination to overturn.



7. **Wall and Ceiling Mounting** - The appliance should be mounted to a wall or ceiling only as recommended by the manufacturer.
8. **Ventilation** - The appliance should be situated so that its location or position does not interfere with its proper ventilation. For example, the appliance should not be situated on a bed, sofa, rug, or similar surface that may block the ventilation openings; or placed in a built-in installation, such as a bookcase or cabinet that may impede the flow of air through the ventilation openings.
9. **Heat** - The appliance should be situated away from heat sources such as radiators, heat registers, stoves, or other appliances (including amplifiers) that produce heat.
10. **Power Sources** - The appliance should be connected to a power supply only of the type described in the operating instructions or as marked on the appliance.
11. **Grounding or Polarization** - Precautions should be taken so that the grounding or polarization means of an appliance is not defeated.
12. **Power-Cord Protection** - Power supply cords should be routed so that they are not likely to be walked on or pinched by items placed upon or against them, paying particular attention to cords at plugs, convenience receptacles, and the point where they exit from the appliance.
13. **Protective Attachment Plug** - The appliance is equipped with an attachment plug having overload protection. This is a safety feature. See the Instruction Manual for replacement or resetting of the protective device. If replacement of the plug is required, ensure the service technician uses a replacement plug specified by the manufacturer that has the same overload protection as the original plug.
14. **Cleaning** - The appliance should be cleaned only as recommended by the manufacturer.
15. **Power Lines** - An outdoor antenna should be located away from power lines.
16. **Outdoor Antenna Grounding** - If an outside antenna is connected to the receiver, be sure the antenna system is grounded to provide some

protection against voltage surges and built-up static charges. Section 810 of the National Electrical Code, ANSI/NFPA No. 70-1984, provides information on proper grounding of the mast and supporting structure, grounding of the lead-in wire to an antenna discharge unit, size of grounding conductors, location of the antenna discharge unit, connection to grounding electrodes, and requirements for the grounding electrode.

17. **Nonuse Periods** - The power cord of the appliance should be unplugged from the outlet when left unused for a long period of time.
18. **Object and Liquid Entry** - Care should be taken so that objects do not fall and liquids are not spilled into the enclosure through openings.
19. **Damage Requiring Service** - The appliance should be serviced by qualified service personnel when:
 - A. The power supply cord or the plug has been damaged; or
 - B. Objects have fallen, or liquid has been spilled into the appliance; or
 - C. The appliance has been exposed to rain; or
 - D. The appliance does not appear to operate normally or exhibits a marked change in performance; or
 - E. The appliance has been dropped, or the enclosure damaged.
20. **Servicing** - The user should not attempt to service the appliance beyond that described in the operating instructions. All other servicing should be referred to qualified service personnel.



This symbol indicates that this product incorporates double insulation between hazardous mains voltage and user accessible parts. When servicing, use only identical replacement parts.

Register Product

Thank you for choosing PyleUSA. By registering your product, you ensure that you receive the full benefits of our exclusive warranty and personalized customer support. Complete the form to access expert support and to keep your PyleUSA purchase in perfect condition.



[PyleUSA.com/register](https://www.PyleUSA.com/register)

MAINTENANCE

Cleaning the unit: Do not use harsh chemicals on this unit. Clean by lightly wiping with a soft cloth and water. Be sure to dry completely.

Note: Due to the evolving needs of customers, any changes to the functions, specifications, or the product may be made without notice.

Functions & Controls

1. ON/OFF - Volume Control
2. Radio Tuning Control
3. Function Selector (AM, FM, USB)
4. Dial Control
5. Speakers
6. SD Card Reader
7. USB Flash Reader
8. Previous/Volume -
(Press for previous song/
Hold for volume down)
9. Play/Pause
10. Next/Volume + (Press for next song/
Hold for volume up)
11. IR Receiver
12. AC Power Cable
15. FM Wire Antenna
16. Aux Input
17. RCA Output

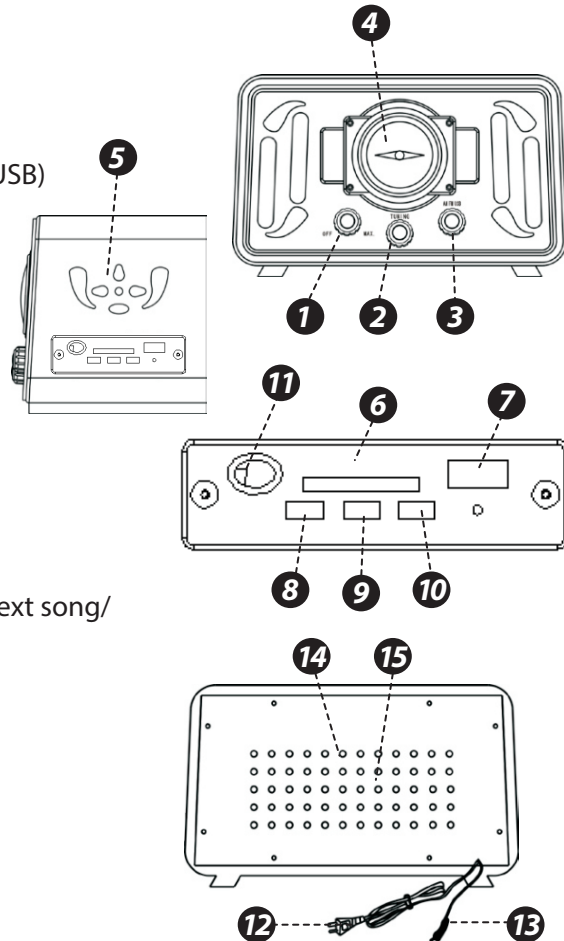

RADIO RECEPTION

1. Turn the **VOLUME CONTROL** clockwise until a “click” is heard.
2. Set the **FUNCTION** Selector to the AM or FM position.
3. Select the required receiving band with the **BAND SWITCH**.
4. Turn the **TUNING CONTROL** to select the desired radio station.
5. Adjust the **VOLUME CONTROL** to obtain the desired sound level from the speaker.
6. To turn the radio off, turn the **VOLUME CONTROL** counter-clockwise until a “click” is heard.

TIPS FOR GOOD RADIO RECEPTION

Use the **FM WIRE ANTENNA** and fully extend it into an open area. To ensure the best AM sensitivity, try repositioning the unit until the best reception is obtained.

CELLPHONE/SMARTPHONE CHARGE FUNCTION

When the unit is powered on, connect your USB cable into the port -- then connect your device to the USB cable. Your phone will now charge.

USB/SD PLAYBACK FUNCTION

1. Using the Function Selector, choose 'USB'.
2. Inserting a USB or SD card will automatically play compatible audio files.
3. While playing from a USB flash drive, inserting an SD card will take priority and play SD card files.
4. When both flash media drives are inserted, USB will take priority and play first.
 - Please note the unit is compatible with only MP3 and WMA file types.
 - The unit is compatible with USB smaller than 16GB.

BLUETOOTH FUNCTION

1. Turn the 'ON/OFF - Volume Control' knob clockwise until you hear a 'beep' sound. This will turn the blue power light on.
2. Set the FUNCTION Selector to 'USB' mode.
3. Press and hold the 'Play / Pause' button to change to 'Bluetooth Mode'.
4. Turn on Bluetooth on your device. Search for 'Pyle Turntable' and connect.
5. When connected successfully, the blue light will remain on.

To ensure optimum Bluetooth sound quality, please remain within 30 feet of the product during connection.

- *Press and hold the 'Play/Pause' button to switch between audio modes.*

AUX PLAYBACK FUNCTION - CONNECTED DEVICE

To play audio from Aux (3.5mm) connected input devices:

- Connect your device via audio cable and connect to the unit.
- Switch the 'Function Selector', located on the front panel, to USB Mode.
- On the side panel, press and hold the Play / Pause button for 5 seconds.
The LED indicator light will blink and shine orange when the unit is ready to stream audio.

AUDIO INPUT

You will have the ability to connect external devices and stream their audio through the radio's speakers.

Please be sure to turn the function switch selector to the 'USB' mode to listen to your connected device.

AUDIO IN-OUT JACK PANEL

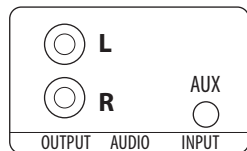

AUDIO DEVICE OUT

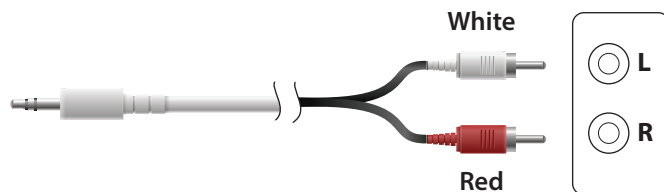

AUDIO OUTPUT

You will have the ability to connect the radio to external speaker systems.

AUDIO AMPLIFIER INT

AUDIO IN-OUT JACK PANEL

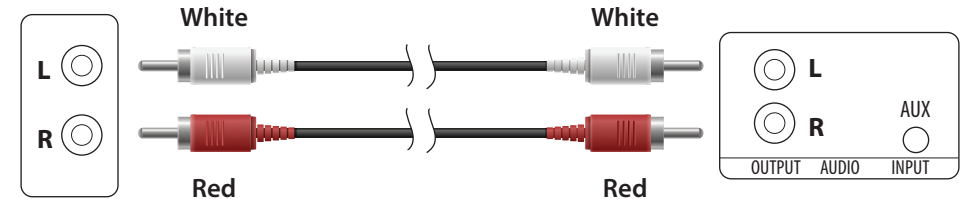

ATTENTION

- A. Before connecting, please make sure to turn off the power.
- B. Ensure the connector is fitted appropriately into the connector. Non-secure or loose connections will result in distortion and unwanted noise.
- C. The connector lines/cables should not be tight. There should be enough slack.

FCC INFORMATION

WARNING:

Changes or modifications not expressly approved by the party responsible for compliance could void the user's authority to operate the equipment.

NOTE: This equipment has been tested and found to comply with the limits for a Class B digital device, pursuant to Part 15 of the FCC Rules. These limits are designed to provide reasonable protection against harmful interference in a residential installation. This unit generates, uses, and can radiate radio frequency energy, and if not installed and used in accordance with the instructions, may cause harmful interference to radio communications. However, there is no guarantee that interference will not occur in a particular installation. If this equipment does cause harmful interference to radio or television reception, which can be determined by turning the equipment off and on, the user is encouraged to try and correct the interference by one or more of the following measures:

- Reorient or relocate the receiving antenna.
- Increase the separation between the equipment and receiver.
- Connect the equipment to an outlet on a circuit different from that to which the receiver is connected.
- Consult the dealer or an experienced radio/TV technician for help.

This device complies with Part 15 of the FCC Rules. Operation is subject to the following two conditions:

1. This device may not cause harmful interference.
2. This device must accept any interference received, including interference that may cause undesired operation.