

Visit Our Website



SCAN ME  
serenelifehome.com

# Lux Series Air Mattress

serenelife™

## USER GUIDE

### EZ® BED-Luxe

This product may be covered under one or more of the following U.S. and / or foreign patents: U.S. Pat. Nos. : 6,754,926 B2; 6,763,540; 7,020,921 B2; 7,365,277; 7,380,301; 7,475,443; 7,497,416 B2; 7,597,123; 7,647,662; 7,739,760; 7,703,160; 7,739,763; 8,024,830 B2; 8,051,517; 8,151,390; 8,214,953; 8,297,309; 8,348,207; 8,444,103; 8,549,686; 8,801,392; 8,863,771; 9,062,668 B2; 9,121,519 B2; 9,157,433; 9,395,076; 9,848,706; 9,989,979; EP2997858B1; Others U.S. and International Patents Pending

#### Weight Limit:

600 LBS For King Size  
500 LBS For Queen Size  
300 LBS For Twin Size

Please see reverse side for more information  
EZ® BED protective casing is not recommended for airline travel

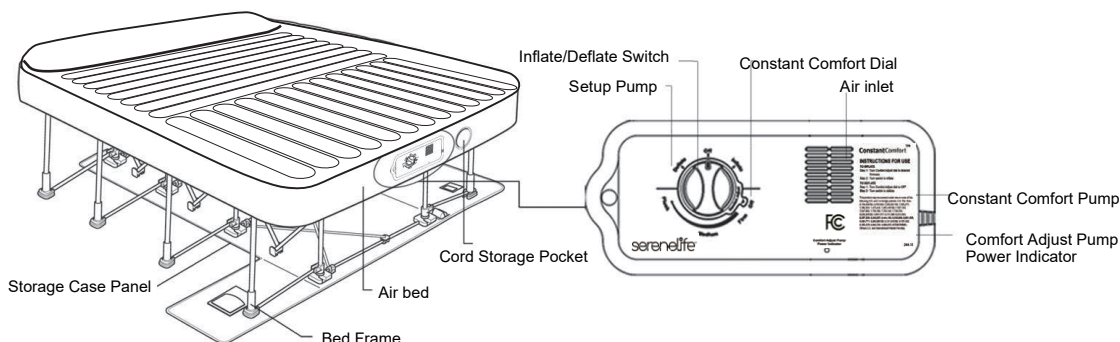

### Instructions for EZ®BED-Luxe Setup Operations:

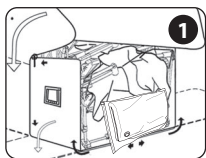

1 Unzip the storage case completely and take out the memory foam pillow top before inflation. Ensure the panel of the storage case is laid flat on the floor; this will prevent damage to the bed frame and ensure smooth extension out of its storage case.

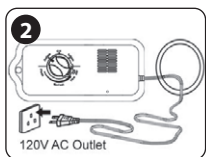

2 Do not place anything on top or around the bed during the inflation cycle. The bed will expand to approximately 9ft. in length and 7ft. in width. (Clear space accordingly). Plug the pump into a polarized 120V AC outlet.

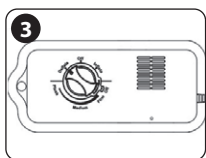

3 Turn the Constant Comfort Dial to the desired firmness level. Turn the Inflate/Deflate switch clockwise to "Inflate" position to turn on the Setup Pump and inflate the air bed.

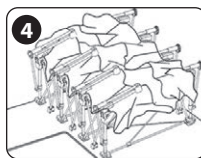

4 The airbed frame will automatically extend from its storage case.

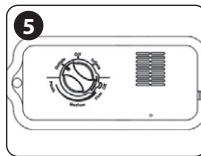

5 The Setup Pump will automatically turn off upon reaching the selected firmness level, and the Inflate/Deflate Switch will automatically return to the "Off" position.

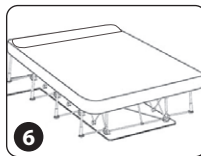

**EZ®BED-Luxe is ready for use.**

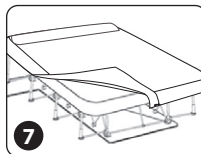

7 Please put the memory foam pillowtop on air bed.

### Instructions for EZ®BED-Luxe Comfort Adjust Pump Operations:

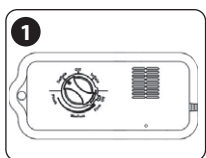

1 The Constant Comfort Pump is a fully automatic pressure maintenance pump designed to operate silently, ensuring it won't disturb your sleep when it automatically turns on to re-inflate. The pump will activate when the air pressure inside the air bed drops below a predetermined low pressure level and will turn off upon reaching the selected firmness level (firmness determined by adjusting the Constant Comfort Dial).

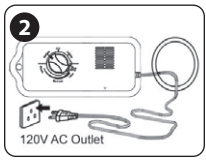

To ensure the Constant Comfort Pump operates, plug the power cord into a 120V AC electrical wall socket.

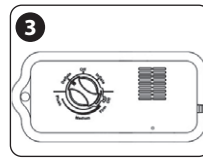

To turn off the Constant Comfort auto-inflate function, turn the Constant Comfort Dial to the "Off" position. Constant Comfort Pump will not automatically turn on regardless of air pressure inside air bed.

### Instructions for EZ®BED-Luxe Storage Operations:

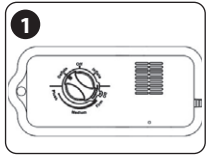

Clear the area, bedding, and any other articles on top or around EZ BED before deflation. Turn the Constant Comfort Dial to the "Off" position to prevent the Constant Comfort Pump from automatically turning on.

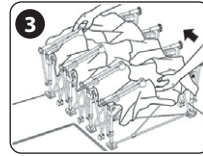

Gently lift up the airbed frame by its foot end and push it back into its storage case.

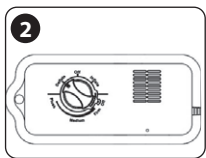

Turn the Inflate/Deflate Switch counter-clockwise to the "Deflate" position for complete air removal. Upon complete air removal, the Setup Pump will automatically turn off, and the Inflate/Deflate Switch will automatically return to the "Off" position. Place the power cord into the Cord Storage Pocket for storage.

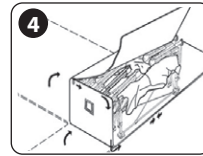

Zip up the storage case for storage. The handle and wheels are located on the storage case for easy and convenient transport.

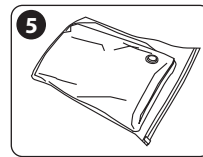

Put the memory foam pillowtop into the PE Bag and carry case.

### For Better Protection of This Product:

- Never unfold or inflate the airbed in temperatures below freezing.
- Avoid extensive exposure to the sun.
- Protect the airbed from contact with sharp objects and rough ground.
- Make sure to handle the pump with care.

### CAUTION:

#### For Household/Residential Use Only

**Double insulation** - when servicing, use only identical replacement parts.

### CARE AND MAINTENANCE:

Clean the airbed only with mild soap and water.

### IMPORTANT SAFETY INSTRUCTIONS:

READ ALL INSTRUCTIONS BEFORE USING.

### DANGER:

To reduce the risk of electric shock, always unplug this appliance from the electrical outlet before cleaning.

## ⚠ WARNING



#### Babies Can Suffocate

To prevent suffocation and death, never place a baby 15 months old or younger on this product.



#### Child Entrapment Hazard

Always position the product 1 ft (30 cm) or more away from objects such as walls and dressers to prevent a child from being entrapped.



#### Keep the product fully inflated when in use

#### Risk of Suffocation or Entrapment Hazard

- Never allow persons with limited mobility to sleep on inflatable mattresses.
- Disabled persons or those using medical devices may become entrapped in the mattress if deflation occurs. See instructions for additional warnings.

## WARNING:

1. Never operate this appliance if it has a damaged cord or plug, is not working properly, or has been dropped into water. Return it to a service center for examination and repair.
2. Never operate the appliance with the air openings blocked. Keep the air openings free of lint, hair, and the like.
3. Never drop or insert any object into any opening.
4. Do not use outdoors. For Household Use Only.
5. Do not use near people using or wearing medical devices.
6. Do not operate where aerosol (spray) products are being used or where oxygen is being administered. Keep the pump away from flammable liquids. The area where the pump is used should be well-ventilated.
7. Do not obstruct ventilation holes on the pump.
8. Do not open the pump case—electrical hazard may result. No user-serviceable parts.
9. Do not over-inflate.
10. Unplug from the outlet before cleaning.
11. Close supervision is necessary when this appliance is used by, or near children, invalids, or disabled persons.
12. Use this appliance only for its intended use as described in this manual. Do not use attachments unless recommended by the manufacturer.
13. Keep the cord away from heated surfaces.
14. To disconnect, turn all controls to the off position, then remove the plug from the outlet.
15. To reduce the risk of electric shock, this appliance has a polarized plug (one blade is wider than the other). This plug will fit in a polarized outlet only one way. If the plug does not fit fully in the outlet, reverse the plug. If it still does not fit, contact a qualified electrician to install the proper outlet. Do not change the plug in any way.
16. Power supply for the pump must be 120V AC.
17. It is not recommended to plug into the 120V power source unattended when not in use.
18. For proper pump usage, it is recommended not to exceed 5 minutes of continuous inflation/deflation time. The pump does not turn off automatically.
19. In case the pump overheats due to excessive continuous inflation/deflation, the power will automatically cut off, the pump cool down indicator will be on, and reset to begin working within 30 minutes, then the pump cool down indicator will be off.
20. The pump included in this airbed is thermally protected.

## 21. SAVE THESE INSTRUCTIONS.

This appliance is double-insulated. In a double-insulated product, two systems of insulation are provided instead of grounding. No grounding means is provided on a double-insulated product, nor is a means for grounding to be added to the product. Servicing a double-insulated product requires extreme care and knowledge of the system and is to be done only by factory qualified service personnel. Replacement parts for a double-insulated product must be identical to the parts they replace.

**NOTE:** *Airbed material may stretch during the first use and may need additional air to reach the desired firmness. Air inside the bed may expand and contract with varying temperatures potentially leading to reduced pressure inside the bed. If this occurs, simply add more air using the built-in pump to achieve the desired firmness.*

## REPAIRING (Repair kit included):

First, deflate the bed by following the instructions for deflation. Clean and repair the affected area thoroughly. Cut a piece of clear patch material (included in the repair kit) into a size that will cover the puncture. Apply the self-adhesive patch over the affected area by peeling off the backing and placing the sticky side down on the airbed. Rub the patch to ensure adhesion. Allow four (4) hours for the repair to set before attempting to inflate the airbed.

## IMPORTANT SAFETY INFORMATION AND WARNINGS

Adult supervision is required for setup. **Warning:** This is an electrical product. To avoid the risk of fire, burns, injury, and shock, it should not be played on or placed near where small children can reach it. Do not use in or around water. Not to be used outside; this bed is for indoor use only. The **EZ®BED-Luxe** should be placed in an open area before use, ensuring there are no sharp objects, steps, drops, or breakable objects in the area. Unplug when not being used.

## Register Product

Thank you for choosing SereneLife. By registering your product, you ensure that you receive the full benefits of our exclusive warranty and personalized customer support.

Complete the form to access expert support and to keep your SereneLife purchase in perfect condition.



Serenelifehome.com/  
register

**WARNING:**

*"Please note that changes or modifications to this product are not expressly approved by the party responsible for compliance, and could void the user's authority to operate the equipment."*

If this equipment does cause harmful interference to radio or television reception, which can be determined by turning the equipment off and on, the user is encouraged to try to correct the interference by one or more of the following measures:

- Reorient or relocate the receiving antenna.
- Increase the separation between the equipment and receiver.
- Connect the equipment to an outlet on a circuit different from that to which the receiver is connected.
- Consult the dealer or an experienced radio/TV technician for help.

Importer: **SOUND AROUND INC.**  
Address: 1600 63RD ST, BROOKLYN NY

**FEATURES:**

- Auto Inflate Function: Automatically Inflates During Use for Constant Comfort
- Includes Memory Foam Cover Sheet for Enhanced Comfort
- Flocked Top Surface Keeps Bedding in Place
- Integrated Pillow Design Supports Head When Lying Down
- U-Style Coils Even Out Weight Distribution
- Strong and Sturdy Powder Coated Steel Frame
- Built-In High Power Pump
- Easy to Set-Up: Inflates/Deflates in 3 Minutes
- Self-Deploying: Simply Unzip Case, Plug In, Turn On, Walk Away
- Automatically Opens and Closes by Itself
- Transforms Into Zip-Up Rolling Case for Convenient Portability On-the-Go
- Sturdy 600D Polyester Wheeled Storage Case
- 20" Raised Height Similar to a Regular Bed
- Great for Frequent Travelers, Campers, Apartment Dwellers, and RV Owners
- Great Spare Bed for Out-Of-Town Guests

**WHAT'S IN THE BOX:**

- Airbed With Steel Frame
- Electric Pump
- (2) Repair Patch with Adhesive
- Built-in Zip Storage Bag (or Wheeled Case)

**TECHNICAL SPECS:**

- Material: Sturdy PVC & flock top
- PVC Thickness: 0.45mm
- 2 styles U Coils



SLEZBDTW10LX



SLEZBDQN20LX



SLEZBDKG50LX

	Weight Capacity	Case Dimension	Inflated Dimension
<b>King Size</b>	600 LBS	42" x 15" x 21"	81.5" x 74" x 20.25"
<b>Queen Size</b>	500 LBS	34.25" x 15" x 21.5"	78" x 63" x 20.25"
<b>Twin Size</b>	300 LBS	24" x 16.5" x 20"	77" x 41.5" x 20.25"

**California Prop 65 Warning**

**⚠️ WARNING:**

This product contains Phthalates which is known to the state of California to cause cancer birth defects and other reproductive harm. Do not ingest.

For more info go to: [www.P65warnings.ca.gov](http://www.P65warnings.ca.gov)



**Questions or Comments?**

**We are here to help!**

**Phone: 1.718.535.1800**

**Serenelifehome.com/ContactUs**