

SereneLife



USER'S MANUAL

NEOBATH BIDET

SLTLSP14

WARNING! PLEASE PLACE ALL THE PRODUCTS AT A MODERATE ROOM TEMPERATURE AND DO NOT STORAGE THE BIDETS AND ITS ACCESSORIES IN A FREEZING TEMPERATURE ENVIRONMENTS UNDER ZERO DEGREE CELSIUS.

1. NAMES AND FUNCTIONS OF PARTS

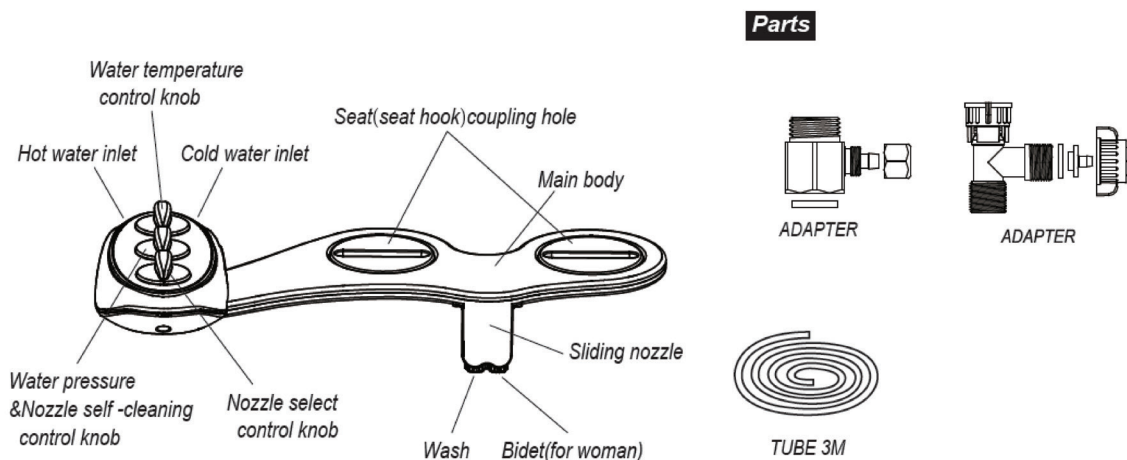

2. INSTALLATION

PREPARATION

- A. Remove the existing toilet seat.
- C. Flush toilet to drain tank completely.

- B. Turn off the water valve.
- D. Take out exiting water pipe.

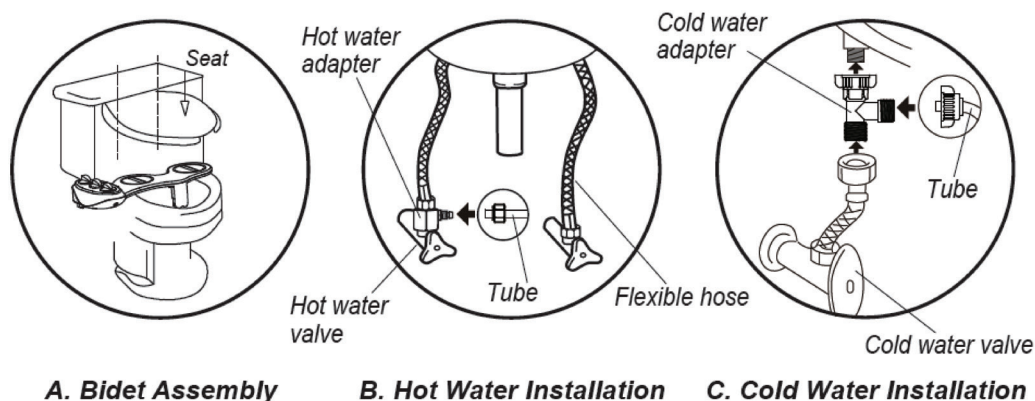

! HELPFUL TIP:

Over tightening flexible hoses adaptor can cause damage to the threads and result in water leakage. Use only hand pressure first and check for any leakage. Turn only less than quarter turn at a time making sure there is no leakage.

3. FINAL ASSEMBLY

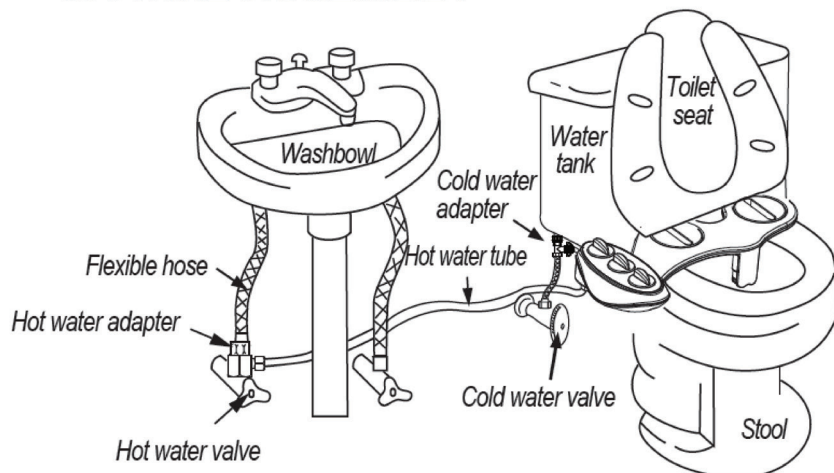

Congratulations! You are now ready to use your THE Bidet Attachment. Be sure to slowly turn pressure control knob until you reach the desired pressure. The water pressure control device is to be used only to control water pressure, not to set up the duration of the water spray.

TROUBLE SHOOTING

Twin Nozzle System

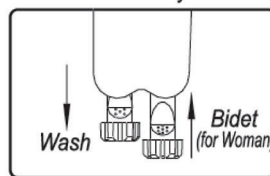

If your spray outlet hole is clogged for some reason, simply try to move spray outlet up and down for a few times manually.

NEOBATH BIDET FEATURES AND SPECIFICATIONS

- Non-Electric Hot/Cold Water Bidet
- D.I.Y. Installation: Easy-to-Use & Easy-to-Setup
- Universal Toilet Bowl Seat Compatibility
- Fits Virtually All Toilet Bowl Makes & Models
- Designed for a Gentle & Efficient Hygiene Clean
- Sold as: 1
- Weight: 2.74 lbs.

SereneLife

